

**BRAKE DISCS**  
**CATALOGUE**  
**2016**



**CATALOGUE  
2016**



**BRAKE DISCS**

**DISCHI FRENO**

**FREINS À DISQUES**

**BREMSSCHEIBEN**

**DISCOS DE FRENO**





Introduzione		4
Introduction		
Introduction		
Einleitung		
Introduccion		
<hr/>		
Dimensioni		8
Sizes		
Dimensions		
Abmessungen		
Medidas		
<hr/>		
Specifiche tecniche		10
Technical specifications		
Caractéristiques techniques		
Technische Eigenschaften		
Características técnicas		
<hr/>		
<b>Sec.1</b>	Gamma completa veicoli	16
	Complete range of vehicles	
	Gamme complète véhicules	
	Motorrad Produktpalette	
	Gama completa vehiculos	
<hr/>		
<b>Sec. 2</b>	Disegni dischi fissi e loro applicazioni	56
	Drawings of fixed discs and their applications	
	Dessins des disques fixes et leurs applications	
	Zeichnungen der einteiligen Bremsscheiben und deren Anwendungen	
	Diseños y aplicaciones de los discos fijos	
<hr/>		
<b>Sec. 3</b>	Disegni dischi flottanti e loro applicazioni	92
	Drawings of floating discs and their applications	
	Dessins des disques flottants et leurs applications	
	Zeichnungen der schwimmenden Bremsscheiben und deren Anwendungen	
	Diseños y aplicaciones de los discos flotantes	
<hr/>		

# INTRODUCTION



## Aware of being the leader.

Brembo has always stood for technical excellence: this fact makes us global leaders in braking systems for cars, motorcycles and commercial vehicles. For more than 50 years, we have been installing our systems on the most prestigious cars and motorcycles and we are a trusted companion of the greatest drivers and riders in their thrilling adventures. We have shared victory in over 300 world championships by their side. On all levels, our goal is always to further past achievements and seek out new challenges. This is the reason why the Brembo Group, whose staff is formed by 10% of specialized engineers and technicians, invests heavily in Research & Development. From the hatching concept to the final brake on the tar-mat: we closely monitor all the steps that lead to the manufacture of each single component of the braking system. R&D, testing, production and assembly, quality control and distribution, without forgetting customer service: close monitoring of the value chain from start to finish is a guiding principle of our philosophy. We carry out all manufacturing processes in-house, as it should be for a Group that is aware of its leadership in the industry. We think of ourselves as one big team that, besides focusing on product quality, also dedicates its attention to performance, comfort and driving safety. Every new product, every article that we add to our offer is a new success, the fruit of hard work and passion born out of computerized simulations and that ends with market placement, after having brilliantly passed the most stringent of quality tests.



## La consapevolezza di essere leader.

Da sempre, Brembo è sinonimo di eccellenza tecnica: per questo siamo leader mondiali dei sistemi frenanti per auto, moto e veicoli commerciali. Da oltre 50 anni equipaggiamo le automobili e le moto più prestigiose e accompagniamo i più grandi piloti nelle loro emozionanti avventure: con loro abbiamo vinto oltre 300 campionati mondiali. In ogni settore il nostro obiettivo è sempre stato quello di superare i traguardi raggiunti e cercare nuove sfide. Per questo, il Gruppo Brembo, formato per il 10% da ingegneri e tecnici specializzati, dedica al settore R&D (Ricerca e Sviluppo) una quota crescente di investimenti. Dall'idea che prende forma alla frenata al termine del rettilineo: tutte le fasi che portano alla realizzazione di ogni singolo elemento dell'impianto frenante sono scrupolosamente monitorate. Ricerca e design, sviluppo e test, produzione e assemblaggio, controllo della qualità e distribuzione, senza dimenticare l'assistenza: è il controllo della catena del valore un punto fermo della nostra filosofia. Tutto il processo produttivo si svolge al nostro interno, come deve essere per un Gruppo consapevole di essere leader del proprio settore. Ci consideriamo un unico grande team che, oltre alla qualità dei propri prodotti, pone la massima attenzione anche alle prestazioni, al comfort e alla sicurezza di guida. Ogni nuovo prodotto, ogni articolo che aggiungiamo alla nostra gamma è un nuovo successo, frutto di un severo e appassionante processo che nasce dalle simulazioni computerizzate e si conclude con la diffusione al mercato, dopo aver superato brillantemente tutti i più rigorosi test qualitativi.



**F**

### La conscience d'être un leader.

Brembo est depuis toujours synonyme d'excellence technique : c'est la raison pour laquelle nous sommes le leader mondial des systèmes de freinage pour voitures, motos et véhicules utilitaires.

Depuis plus de 50 ans, nous équipons les voitures et les motos les plus prestigieuses et nous accompagnons les plus grands pilotes dans leurs passionnantes aventures : nous avons gagné avec eux plus de 300 championnats du monde.

Quel que soit le domaine, notre objectif a toujours été d'aller au-delà des objectifs atteints et de relever de nouveaux défis.

C'est pourquoi le Groupe Brembo, formé à 10% d'ingénieurs et de techniciens spécialisés, réserve au secteur R&D (Recherche et Développement) une part croissante d'investissements.

De l'idée qui prend forme jusqu'au freinage au bout de la ligne droite : toutes les phases permettant de réaliser chaque élément du système de freinage sont scrupuleusement contrôlées. Recherche et design, développement et essais, fabrication et assemblage, contrôle de la qualité et distribution, sans oublier l'assistance : le contrôle de la chaîne de valeur est un point clé de notre philosophie.

Tout le processus de production se déroule au sein de l'entreprise, une condition sine qua non pour un Groupe conscient d'être le leader de son secteur. Nous nous considérons comme une seule grande équipe qui réserve le maximum d'attention non seulement à la qualité de ses produits, mais aussi aux performances, au confort et à la sécurité au volant.

Tout nouveau produit, tout article que nous ajoutons à notre gamme est un nouveau succès, fruit d'un processus à la fois rigoureux et passionnant, qui naît des simulations informatisées et s'achève par la diffusion sur le marché, après avoir brillamment passé tous les tests qualitatifs les plus sévères.

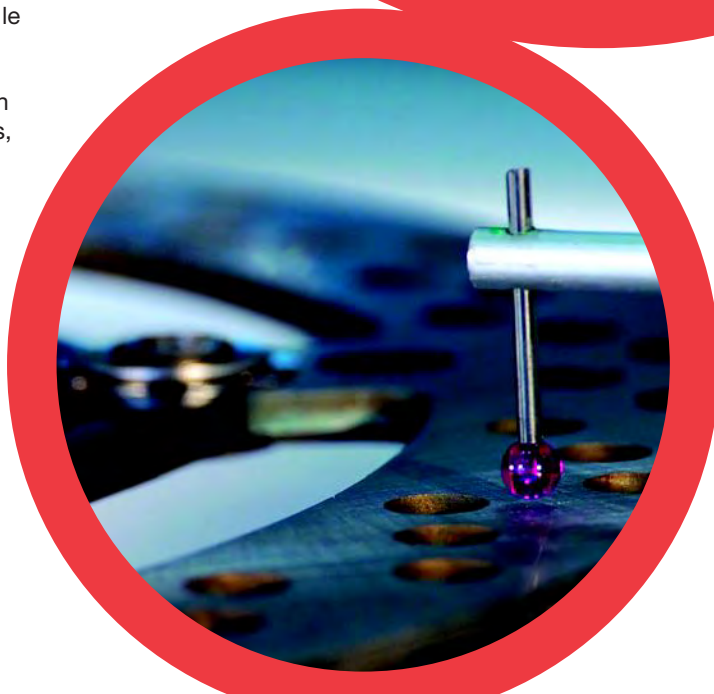

# INTRODUCTION

## **D** Das Bewusstsein Marktführer zu sein.

Bei Brembo steht technische Exzellenz seit jeher im Mittelpunkt: Es darf also nicht verwundern, dass wir Weltmarktführer bei Bremsanlagen für PKW, Motorräder und Nutzfahrzeuge sind.

Seit über 50 Jahren statten wir die renommiertesten Automobil- und Motorradmarken aus und begleiten die besten Fahrer bei ihren sensationellen Unternehmungen: gemeinsam mit ihnen haben wir über 300 Weltmeisterschaften gewonnen.

In jedem Bereich sind wir darauf fokussiert, über die erreichten Zielsetzungen hinaus neue Herausforderungen anzustreben. Deshalb investiert die Brembo Gruppe, die zu 10 % aus Fachingenieuren und

technischen Spezialisten besteht, einen wachsenden Anteil ihres Kapitals in die Forschung und Entwicklung.

Von der Idee, die Form

annimmt, bis zum Bremsmanöver am Ende der Geraden: Alle Phasen, die zum Entstehen jedes einzelnen Elements der Bremsanlage führen, werden genauestens überwacht. Forschung und Design, Entwicklung und Tests, Produktion und Montage, Qualitäts- und Vertriebskontrolle, nicht zu vergessen der Kundendienst: Die Kontrolle der Wertschöpfungskette ist ein Fixpunkt unserer Philosophie.

Der gesamte Produktionsprozess erfolgt werksintern, wie es bei einer Gruppe sein muss, die sich dessen bewusst ist, Marktführer des eigenen Wirtschaftszweigs zu sein. Wir sind ein einzigartiges, großartiges Team, das nicht nur größten Wert auf die Qualität seiner Produkte, sondern auch auf die Leistung, den Komfort und die Fahrsicherheit legt.

Jedes neue Produkt, jeder neue Artikel unseres Angebots stellt ein neues Erfolgsmoment im Rahmen eines ebenso strengen wie anregenden Prozesses dar, der bei komplexen Computersimulationen ansetzt und nach Erfüllung akkurater Qualitätstests mit der Vermarktung endet.





**E**

### La conciencia de ser líder.

Brembo desde siempre es sinónimo de excelencia técnica: por esto somos líderes mundiales de sistemas de frenos para automóvil, moto y vehículos comerciales. Llevamos más de 50 años equipando las motos y los automóviles más prestigiosos y acompañando a los mejores pilotos en sus aventuras emocionantes: con ellos hemos ganado más de 300 campeonatos mundiales.

En todos los sectores nuestro objetivo es siempre lograr las metas y buscar nuevos desafíos. Por esto el Grupo Brembo, un 10% del cual está conformado por ingenieros y técnicos especializados, dedica al sector de I&D (Investigación y Desarrollo) una cuota creciente de inversiones.

Desde la idea que va concretándose hasta la frenada al final de la recta: todas las fases que llevan a realizar cada uno de los elementos del sistema de frenos han sido cuidadosamente controladas. Investigación y diseño, desarrollo y pruebas, producción y ensamble, control de calidad y distribución, sin descuidar el servicio técnico: un punto firme de nuestra filosofía empresarial es el control de la cadena de valor.

Todo el proceso productivo lo realizamos en nuestras propias instalaciones, como debe ser para un Grupo consciente de ser líder de su sector. Nos consideramos un único grande equipo que, además de la calidad de sus productos, dedica la máxima atención también a las prestaciones, al confort y a la seguridad a la hora de conducir.

Cada nuevo producto, cada artículo que añadimos a nuestra gama es un nuevo éxito, resultado de un proceso severo y apasionante que empieza por las simulaciones informáticas y termina con la puesta en comercio, después de haber pasado sobresalientemente todas las pruebas de calidad más rigurosas.





# DIMENSIONS

## I Dimensioni

- A Diametro esterno
- B Diametro centraggio
- C Interasse fori fissaggio
- D Diametro fori fissaggio
- E Spessore disco

## UK Sizes

- A Outer diameter
- B Spigot hole diameter
- C Distance between fixing centres
- D Diameter of fixing holes
- E Disc thickness

## F Dimensions

- A Diamètre extérieur
- B Diamètre de centrage
- C Entraxe des trous de fixation
- D Diamètre des trous de fixation
- E Épaisseur du disque

## D Abmessungen

- A Außendurchmesser
- B Zentrierungsdurchmesser
- C Abstand zwischen Befestigungsbohrungen
- D Durchmesser der Befestigungsbohrungen
- E Scheibenstärke

## E Medidas

- A Diámetro exterior
- B Diámetro centrado
- C Distancia entre los orificios de fijación
- D Diámetro de los orificios de fijación
- E Espesor del disco

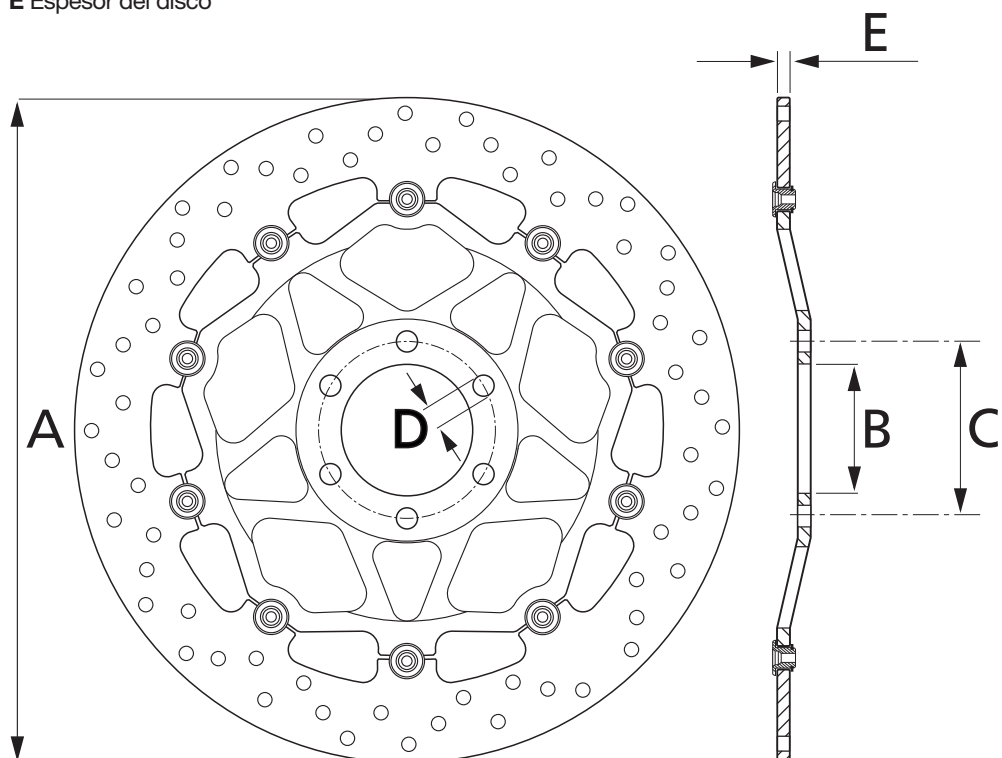



MADE IN ITALY  
brembo

13.03124

MIN. TH. 4,5mm

KBA 6129



52-802



# TECHNICAL SPECIFICATIONS

## Dischi Brembo

Pur essendo un componente della moto apparentemente semplice, il disco freno richiede esperienza e tecnologia per la sua realizzazione, in quanto parte fondamentale di un sistema che, nonostante le forti sollecitazioni termomeccaniche, deve garantire sicurezza, affidabilità e prestazioni in tutte le condizioni d'utilizzo. Per queste ragioni vi consigliamo di controllare periodicamente lo stato dei vostri dischi e, quando necessario, provvedere alla loro sostituzione. Brembo, azienda leader nel campo degli impianti frenanti, offre una linea completa di dischi in grado di soddisfare qualsiasi necessità:

### **Dischi freno Serie Oro**

Perfettamente intercambiabili ai dischi di serie, sono la scelta dei motociclisti che non vogliono rinunciare alla qualità Brembo.

## Caratteristiche costruttive

### **Dischi freno "Flottanti"**

Sono composti dalla fascia frenante in acciaio Inox, collegata attraverso 10 nottolini di trascinamento alla campana realizzata in lega di alluminio, lavorata CNC e successivamente anodizzata. I dischi "flottanti" Brembo, in virtù dell'impiego di materiali di altissima qualità, forniscono prestazioni di assoluta eccellenza.

### **Dischi freno "Fissi"**

Sono realizzati in acciaio Inox in un unico pezzo, secondo una linea progettuale e costruttiva che assicura un'esecuzione perfetta: le tolleranze strettissime imposte ed i cicli di lavorazione scelti garantiscono ai dischi "fissi" Brembo caratteristiche di planarità e concentricità che li pongono al top della scelta.

Nota: I **Serie Oro** seguono le caratteristiche costruttive dei dischi originali, quindi se la moto monta di serie un disco flottante anche il ricambio sarà così costruito. Per facilitare la scelta, le prime due cifre del codice identificano la tipologia del disco: 78 per i flottanti, 68 per i fissi.





UK

## Brembo Discs

It might appear to be one of the more simple parts on a motorcycle, but the brake disc requires considerable experience and technology to manufacture, given its role as a key component in a system exposed to strong thermo-mechanical stresses, yet expected to guarantee safety, reliability and performance under any operating conditions. With this in mind, we recommend that you check the state of your discs periodically, and be sure to replace them when necessary. Brembo, world-leading designer and manufacturer of brake systems, offers a comprehensive range of discs that will meet any and every need:

### **Serie Oro brake discs**

100% interchangeable with standard discs, these are the choice of motorcyclists familiar with Brembo quality and willing to accept nothing less.

### **Features of construction**

#### **'Floating' brake discs**

In this design, the disc proper is made of stainless steel and connected by way of 10 drive pins to a hub flange cast from light aluminium, machined on CNC equipment and then anodized. Brembo 'floating' discs are manufactured from materials of the highest quality and deliver performance second to none.

#### **'Fixed' discs**

Fashioned in one piece from stainless steel, these are discs designed and constructed to produce a faultlessly engineered package: ultra-close manufacturing tolerances and selected machining cycles guarantee flatness and concentricity that will recommend Brembo 'fixed' discs to the most discerning of motorcyclists.

Note:

**Serie Oro** discs are made to the same design as their OE equivalent; accordingly, if the machine came with a floating disc, then the Gold Series replacement will also be a floating disc. For easy identification, the first two digits of the part number indicate the type of disc: 78 for floating, 68 for fixed.





# TECHNICAL SPECIFICATIONS



## Disques Brembo

Bien que pouvant sembler un composant apparemment simple de la moto, le disque de frein exige expérience et technologie pour sa réalisation, puisqu'il s'agit d'une pièce fondamentale d'un système qui doit garantir, malgré de fortes contraintes thermodynamiques, la sécurité, la fiabilité et les performances dans toutes les conditions d'utilisation. C'est pour cette raison que nous vous conseillons de contrôler périodiquement l'état de vos disques et, si nécessaire, de les remplacer. Brembo, entreprise leader dans le domaine des systèmes de freinage, offre une gamme complète de disques en mesure de satisfaire toute nécessité :

### Disques de frein Serie Oro

Pouvant remplacer parfaitement les disques de série, c'est le choix des les motocyclistes qui ne veulent pas renoncer à la qualité Brembo.

## Caractéristiques de construction

### Disques de frein « flottants »

Ils sont formés par une bande circulaire de freinage en acier inox, reliée au moyen de 10 masselottes d'entraînement à la cloche réalisée en alliage d'aluminium, usinée sur une machine à CNC et ensuite anodisée. Du fait de l'emploi de matériaux de très haute qualité, les disques « flottants » Brembo fournissent des performances de premier plan.

### Disques de frein « fixes »

Ils sont réalisés en acier inox d'une seule pièce, selon une ligne de conception et de construction qui assure une exécution parfaite : les tolérances très étroites imposées et les cycles d'usinage choisis garantissent aux disques « fixes » Brembo des caractéristiques de planéité et de concentricité qui en font le meilleur choix.

Note : les disques **Serie Oro** ont les mêmes caractéristiques de construction que les disques d'origine ; ainsi, si la moto est équipée de série d'un disque flottant, la pièce détachée sera elle aussi construite de cette manière.

Pour faciliter le choix, les deux premiers chiffres de la référence identifient le type de disque :

78 pour les disques flottants, 68 pour les disques fixes.



## Brembo Bremsscheiben

Die Bremsscheiben eines Motorrads scheinen auf den ersten Blick einfache Komponenten zu sein; für deren Herstellung sind jedoch reichlich Erfahrung und technologische Versiertheit erforderlich, da sie die wesentlichen Bestandteile eines Systems sind, die angesichts der hohen thermomechanischen Belastungen Sicherheit, Zuverlässigkeit und Leistung unter jeder Fahrbetriebsbedingung garantieren müssen. Aus diesen Gründen empfiehlt es sich, regelmäßig den Zustand der Bremsscheiben zu kontrollieren und bei Bedarf deren Austausch zu veranlassen. Brembo, das führende Unternehmen im Bereich der Bremsanlagen für Motorräder, verfügt über ein in jeder Hinsicht komplettes Angebot an Bremsscheiben, die entsprechend ausgelegt sind, um jede Anforderung zu erfüllen:

### **Bremsscheiben Serie Oro**

Für diese anstelle aller gängigen Serienmodelle montierbaren Bremsscheiben entscheiden sich diejenigen Motorradfahrer, die auf keinen Fall auf Brembo Qualität verzichten möchten.

### **Bautechnische Eigenschaften**

#### **„Schwimmend gelagerte“ Bremsscheiben**

Diese Bremsscheiben bestehen aus einem Bremsband aus Edelstahl, das über 10 Mitnehmerbolzen mit dem Innenteil aus CNC-bearbeiteter und anschließend eloxierter Aluminiumlegierung verbunden ist. Die „schwimmend gelagerten“ Bremsscheiben von Brembo bieten dank der Fertigung mit Materialien höchster Qualität absolute Spitzenleistungen.

#### **„Einteilige“ Bremsscheiben**

Diese in einem Stück gefertigten Bremsscheiben aus Edelstahl werden nach einem Verfahren hergestellt, das an Perfektion seinesgleichen sucht: Die bewusst eng

gehaltenen Toleranzen und die ausgewählten Bearbeitungszyklen garantieren den „einteiligen“ Brembo Bremsscheiben nahezu unvergleichliche Ebenheits- und Konzentritätseigenschaften.

Hinweis: Die Modelle der **Serie Oro** entsprechen bautechnisch den Original-Bremsscheiben, d.h., ist das Motorrad serienmäßig mit einer schwimmend gelagerten Bremsscheibe versehen, wird das Ersatzteil analog dazu hergestellt. Um die Auswahl zu erleichtern, geben die ersten zwei Ziffern des Codes den Bremsscheibentyp an: 78 für schwimmend gelagerte bzw. 68 für einteilige Bremsscheiben.

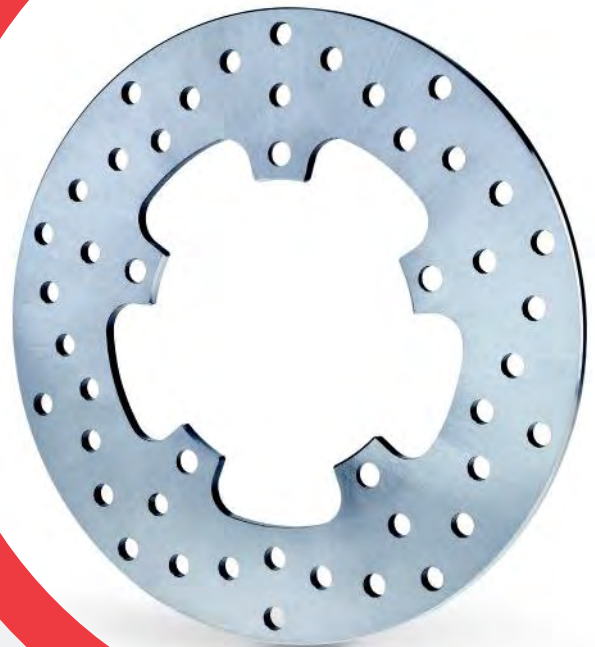

# TECHNICAL SPECIFICATIONS

## **E** Discos Brembo

Más allá de su aparente sencillez, un disco de freno requiere experiencia y tecnología en su realización, por ser un componente fundamental de un sistema sujeto a considerables esfuerzos termomecánicos que debe garantizar seguridad, fiabilidad y altas prestaciones en cualquier condición de uso. Por estas razones, recomendamos controlar periódicamente el estado de los discos y sustituirlos cuando sea necesario. Brembo, empresa líder en el sector de los sistemas de freno, ofrece una línea completa de discos capaces de responder a cualquier necesidad:

### **Discos de freno Serie Oro**

Perfectamente intercambiables con los discos de serie, son la elección de los motociclistas que no están dispuestos a renunciar a la calidad Brembo.

## **Características constructivas**

### **Discos de freno “Flotantes”**

Compuestos por una banda de freno de acero inoxidable conectada a través de 10 pasadores a la campana, realizada en aleación de aluminio, mecanizada por CNC y posteriormente anodizada. Gracias al empleo de materiales de altísima calidad en su fabricación, los discos “flotantes” Brembo aseguran prestaciones de absoluta excelencia.

### **Discos de freno “Fijos”**

Realizados en un único bloque macizo de acero inoxidable, con una línea de proyecto y construcción que asegura una ejecución perfecta: las estrictas tolerancias y los ciclos de mecanizado elegidos garantizan a los discos “fijos” Brembo características de planaridad y concentricidad que los colocan en la cumbre de la gama.

Nota: Los **Serie Oro** siguen las características constructivas de los discos originales. Por lo tanto, si la moto se suministra de serie con un disco flotante, el repuesto estará construido de la misma manera.

Para facilitar la elección, las primeras dos cifras del código identifican el tipo de disco: 78 en los flotantes, 68 en los fijos.





A close-up, high-contrast photograph of Brembo brake components. The image features two brake discs, one in the foreground and one in the background, both with a brushed metal finish and a pattern of circular cooling holes. A brake pad is positioned between the discs, showing its dark, textured friction surface. The lighting creates strong highlights and deep shadows, emphasizing the metallic textures and the complex shapes of the parts. The Brembo logo and 'MADE IN ITALY' are visible on the pad.

MADE IN ITALY  
brembo





# **GAMMA COMPLETA VEICOLI**

COMPLETE RANGE OF VEHICLES

GAMME COMPLETE VEHICULES

MOTORRAD PRODUKTPALETTE

GAMA COMPLETA VEHICULOS





				Fix	Floating	Fix	Floating
<b>ADIVA</b>							
250	AD 200	06 >	●	68B407B6		68B40776	
<b>AGRATI GARELLI</b>							
50	BIG WHEEL	93 >	●	68B40710		68B40710	
50	BIP-RACING	94 >	●	68B40710			
50	GRINTA	95 >	●	68B40710			
50	PONY SR	95 >	●	68B40710			
50	QUEENIE	95 >	●	68B40710			
<b>APRILIA</b>							
50	AMICO	92 > 94	●	68B40710			
50	AREA 51	98 > 02	●			68B40717	
50	AREA 51 SUPERBIKE	00 > 02	●			68B40717	
50	GULLIVER	95 > 00	●	68B40717			
50	HABANA	99 >	●	68B40717			
50	HABANA CUSTOM	99 >	●	68B40717			
50	MC GULLIVER	95 >	●	68B40717			
50	MOJITO	04 > 08	●	68B40717			
50	MOJITO CUSTOM	99 > 03	●	68B40717			
50	MOJITO RETRO	99 > 03	●	68B40717			
50	RALLY	92 > 96	●	68B40717			
50	RALLY	97 >	●	68B40717		68B40717	
50	RALLY AC	96 >	●	68B40717			
50	RALLY LC	92 > 96	●	68B40717			
50	RALLY LC	97 >	●	68B40717		68B40717	
50	RS	99 > 05	●			68B407G2	
50	SCARABEO	94 > 97	●	68B40736			
50	SCARABEO	98 > 05	●	68B40732		68B40717	
50	SCARABEO 4T	02 > 09	●	68B40732		68B40717	
50	SCARABEO 4T RESTYLING	06 > 08	●	68B40732			
50	SCARABEO 4V4T	13 >	●	68B40732			
50	SCARABEO BRIGHT	98 >	●	68B40732		68B40717	
50	SCARABEO DE LUXE	98 >	●	68B40732		68B40717	
50	SCARABEO DITECH	02 > 04	●	68B40732		68B40717	
50	SCARABEO DITECH	05 >	●	68B40732			
50	SCARABEO STREET	98 >	●	68B40732			
50	SONIC GP	98 > 08	●	68B40710			
50	SONIC SPICE	98 > 08	●	68B40710			
50	SPORTCITY ONE 2T/4T	08 >	●	68B40730			
50	SPORTCITY ONE STREET	09 >	●	68B40730			
50	SR CAPIROSSI	98 >	●	68B40717		68B40717	
50	SR DITECH	00 > 06	●	68B40717		68B40717	
50	SR EUROPA	93 >	●	68B40717			
50	SR LC	94 > 96	●	68B40717		68B40719	
50	SR PUREJET	03 > 05	●	68B40717		68B40717	
50	SR R	05 >	●	68B40717		68B40717	
50	SR R FACTORY	03 > 04	●	68B40717		68B40717	
50	SR R FACTORY	05 > 08	●	68B40719		68B40717	
50	SR R FACTORY	09 >	●	68B40717		68B40717	
50	SR R FACTORY REPLICA SBK	10 >	●	68B40717		68B40717	
50	SR RACING	97 > 00	●	68B40717		68B40717	
50	SR STEALTH LC	97 > 00	●	68B40717		68B40717	
50	SR STREET	03 > 12	●	68B40719		68B40717	
50	SR URBAN KID	93 >	●	68B40717			
50	SR VIPER-REPLICA	94 >	●	68B40717			
50	TUONO	03 > 04	●			68B407G2	
50	VIPER-REPLICA	94 >	●	68B40717			
70	SCARABEO	94 > 98	●	68B40736			
100	SCARABEO	99 >	●	68B40732			
125	AF-1 FUTURA	90 > 92	●		78B40870		
125	ATLANTIC	03 > 11	●	68B40798		68B40719	
125	HABANA	99 >	●	68B40717			
125	HABANA CUSTOM	00 >	●	68B40717			
125	HABANA DITECH	02 >	●	68B40717			
125	LEONARDO	95 > 02	●	68B40732		68B40717	
125	LEONARDO ST	03 >	●	68B40732		68B40717	
125	MOJITO	03 > 08	●	68B40717			
125	MOJITO CUSTOM	99 > 01	●	68B40717			
125	MOJITO RETRO	99 > 01	●	68B40717			
125	MX	04 > 07	●		78B40870	68B40753	
125	PEGASO	89 > 99	●	68B407G5		68B40753	
125	RS EXTREMA	89 > 91	●		78B40870	68B40753	
125	RS EXTREMA	92 > 97	●		78B40870	68B40753	





				Fix	Floating	Fix	Floating
<b>APRILIA</b>							
125	RS REPLICA	92 > 97	●		78B40870	68B40753	
125	SCARABEO	98 > 98	●	68B40736			
125	SCARABEO	99 > 03	●	68B407B0		68B40732	
125	SCARABEO	04 > 07	●	68B407B0		68B40798	
125	SCARABEO GT	99 > 03	●	68B407B0		68B40732	
125	SCARABEO I.E.	08 >	●	68B407B0			
125	SPORT PRODUCTION	92 >	●		78B40870		
125	SPORTCITY	05 > 05	●	68B407B0			
125	SPORTCITY	06 > 07	●	68B407B0		68B40732	
125	SPORTCITY CUBE	09 >	●	68B407B0		68B40732	
125	SPORTCITY ONE	11 >	●	68B40730			
125	SPORTCITY STREET	12 > 12	●●	68B407B0		68B40732	
125	SR	99 > 03	●	68B40717		68B40717	
125	SR MAX	10 >	●	68B407B6		68B40777	
125	SR REPLICA	99 > 01	●	68B40717		68B40717	
125	TUAREG RALLY	89 > 92	●			68B40753	
125	TUONO	04 > 05	●		78B40870	68B407G2	
150	LEONARDO	96 > 98	●	68B40732		68B40717	
150	LEONARDO ST	99 > 02	●	68B40732		68B40732	
150	MOJITO	03 > 07	●	68B40717			
150	SCARABEO	98 > 98	●	68B40736			
150	SCARABEO	99 > 03	●	68B407B0		68B40732	
150	SR	99 > 03	●	68B40717		68B40717	
150	SR REPLICA	99 >	●	68B40717		68B40717	
200	ATLANTIC	03 > 04	●	68B40798		68B40719	
200	SCARABEO GT	01 > 06	●	68B407B0		68B40732	
200	SCARABEO I.E.	07 >	●	68B407B0		68B407G2	
200	SCARABEO LIGHT	07 >	●	68B407B0		68B407G2	
200	SPORTCITY	04 > 08	●	68B407B0		68B40732	
200	SPORTCITY CUBE	08 > 10	●●	68B407B0		68B40732	
250	ATLANTIC	04 > 06	●	68B40798		68B40719	
250	LEONARDO	99 > 04	●	68B40732		68B40736	
250	RS	94 >	●			68B407G2	
250	SCARABEO	04 > 05	●	68B407B0		68B40777	
250	SCARABEO	10 >	●	68B407B0			
250	SCARABEO I.E.	06 > 09	●	68B407B0		68B40777	
250	SCARABEO LIGHT	06 > 08	●	68B407B0			
250	SPORTCITY	06 > 08	●●	68B407B0		68B40732	
250	SPORTCITY CUBE	08 > 12	●●	68B407B0		68B40732	
300	ATLANTIC	10 > 11	●	68B40798		68B40719	
300	LEONARDO ST	05 > 06	●●	68B40732		68B40717	
300	SCARABEO I.E.	09 >	●	68B407B0		68B40777	
300	SCARABEO LIGHT	06 > 10	●	68B407B0			
300	SCARABEO SPECIAL	09 >	●	68B407B0		68B40777	
300	SPORTCITY CUBE	08 >	●	68B407B0		68B40732	
300	SPORTCITY STREET	12 > 12	●●	68B407B0		68B40732	
300	SR MAX	10 >	●	68B407B6		68B40777	
400	ATLANTIC SPRINT	06 >	●●	68B407B0		68B40719	
400	SCARABEO I.E.	06 >	●	68B407B0		68B40777	
400	SCARABEO LIGHT	07 >	●●	68B407B0		68B407G2	
400	SCARABEO URBAN	06 > 08	●●	68B407B0		68B40777	
500	ATLANTIC	01 > 05	●●	68B407B0		68B40736	
500	ATLANTIC SPRINT	05 > 05	●	68B407B0		68B40719	
500	ATLANTIC SPRINT	06 > 08	●	68B407B0		68B40736	
500	SCARABEO	03 > 06	●●	68B407B0		68B40736	
500	SCARABEO CLASSIC	10 >	●	68B407B0		68B40777	
500	SCARABEO GT ABS	06 >	●	68B407B0		68B40777	
500	SCARABEO I.E.	06 >	●	68B407B0		68B40777	
500	SCARABEO LIGHT	07 >	●●	68B407B0		68B40776	
500	SCARABEO URBAN	06 > 11	●	68B407B0		68B40777	
600	PEGASO	89 > 91	●	68B407G5		68B40753	
650	CUBE	93 > 00	●			68B40753	
650	CUBE	01 >	●			68B40781	
650	PEGASO	91 > 92	●	68B407G5		68B40753	
650	PEGASO	93 > 00	●	68B407G5		68B40753	
650	PEGASO FACTORY	07 > 09	●		78B40870	68B40781	
650	PEGASO I.E.	01 > 04	●	68B407G5		68B40781	
650	PEGASO STRADA	05 > 09	●		78B40870	68B40760	
650	PEGASO TRAIL	05 > 08	●	68B407G5		68B40781	
750	DORSODURO	08 >	●		78B40870	68B40760	
750	DORSODURO ABS	08 >	●		78B40870	68B40760	
750	DORSODURO FACTORY	10 >	●●		78B40870	68B40760	







				Fix	Floating	Fix	Floating
<b>APRILIA</b>							
750	SHIVER	07 >	●		78B40870	68B40760	
750	SHIVER GT ABS	09 >	●		78B40870	68B40760	
750	SHIVER SL	07 > 09	●		78B40870	68B40760	
850	MANA	07 > 11	●●		78B40870		
850	MANA GT	09 > 13	●●		78B40870		
850	SRV	12 >	●	68B407F5		68B407F6	
1000	RSV	98 > 00	●		78B40870	68B407G6	
1000	RSV	01 > 03	●		78B40870	68B407G6	
1000	RSV FACTORY	03 > 07	●●		78B40870	68B407G6	
1000	RSV R	00 > 08	●		78B40870	68B407G6	
1000	RSV SP	99 > 00	●		78B40870	68B407G6	
1000	RSV4 FACTORY	09 > 11	●		78B40870	68B407G6	
1000	RSV4 FACTORY APRC	11 > 12	●		78B40870	68B407G6	
1000	RSV4 FACTORY APRC ABS	13 >	●		78B40870	68B407G6	
1000	RSV4 R	10 > 10	●		78B40870	68B407G6	
1000	RSV4 RF	15 >	●		78B40870	68B407G6	
1000	RSV4 RR	15 >	●		78B40870	68B407G6	
1000	SL FALCO	00 > 04	●		78B40870	68B407G6	
1000	TUONO	03 >	●		78B40870	68B407G6	
1000	TUONO FIGHTER	02 > 05	●●		78B40870	68B407G6	
1000	TUONO R	03 > 09	●		78B40870	68B407G6	
1000	TUONO RACING	04 > 05	●		78B40870	68B407G6	
1000	TUONO V4 FACTORY	15 >	●		78B40870	68B407G6	
1000	TUONO V4 FACTORY RR	15 >	●●		78B40870	68B407G6	
1000	TUONO V4R	11 >	●		78B40870	68B407G6	
1000	TUONO V4R APRC	11 >	●●		78B40870	68B407G6	
1000	TUONO V4R APRC ABS	14 >	●●		78B40870	68B407G6	
1200	CAPONORD	13 >	●●		78B40870		
1200	CAPONORD ABS	13 >	●●		78B40870		
1200	CAPONORD RALLY	15 >	●		78B40870	68B40760	
1200	DORSODURO	11 >	●●		78B40870		
1200	DORSODURO ABS	11 >	●●		78B40870		
<b>ATALA</b>							
50	AT 18	98 >	●	68B40716			
50	BYTE	97 > 00	●	68B40710			
50	CAROSSELLO AT 15	97 >	●	68B40736			
50	HACKER AT 12	96 >	●	68B40715			
50	SKEGGIA	99 >	●	68B40715			
<b>AXY</b>							
125	GULP	08 >	●	68B40740		68B40740	
125	YUK	07 >	●	68B40740		68B40740	
150	GULP	08 >	●	68B40740		68B40740	
150	YUK	07 >	●	68B40740		68B40740	
200	GULP	08 >	●	68B40740		68B40740	
200	YUK	07 >	●	68B40740		68B40740	
300	ROAR	08 >	●	68B40740		68B40740	
<b>BENELLI</b>							
50	491 ARMY	97 >	●	68B40716		68B40716	
50	491 GT	97 >	●	68B40716		68B40716	
50	491 NAKED	99 >	●	68B40716			
50	491 RACING	97 >	●	68B40716		68B40716	
50	491 SPORT	97 >	●	68B40716		68B40716	
50	491 ST	01 >	●	68B40716			
50	491 SUPERBIKE	97 >	●	68B40716		68B40716	
50	K2	98 >	●	68B40716			
50	K2 NAMUR	99 >	●	68B40716			
50	PEPE	99 >	●	68B40739			
50	PEPE 4T	05 >	●	68B40739			
50	PEPE CLASSIC	05 >	●	68B40739			
100	K2	99 >	●	68B40716			
100	NAKED	99 > 02	●	68B40716			
100	PEPE	99 >	●	68B40739			
125	ADIVA	00 >	●	68B40739			
125	VELVET	99 > 04	●	68B40739		68B40735	
125	VELVET TOURING	01 >	●	68B40739		68B40735	
150	ADIVA	00 >	●	68B40739			
150	VELVET	00 > 04	●	68B40739		68B40735	
150	VELVET TOURING	01 >	●	68B40739		68B40735	
250	VELVET	99 >	●	68B40798		68B40735	
250	VELVET TOURING	01 >	●	68B40798		68B40735	
300	BN 302	14 >	●		78B40870	68B40781	



				Fix	Floating	Fix	Floating
<b>BENELLI</b>							
400	VELVET	03 >	●	68B40798		68B40772	
600	BN	14 >	●		78B40870	68B40781	
600	BN GT	14 >	●		78B40870	68B40781	
899	TNT CENTURY RACER	11 >	●		78B40870	68B40781	
899	TRE 899 K	11 >	●		78B40870	68B40781	
900	TORNADO 3 BIPOSTO	02 > 03	●●		78B40870		
900	TORNADO 3 L.E.	03 > 06	●●		78B40870	68B407G6	
900	TORNADO 3 RS	04 > 06	●●		78B40870	68B407G6	
1130	TNT	04 >	●●		78B40870	68B40781	
1130	TNT	05 > 06	●●		78B40870	68B40781	
1130	TNT CAFE' RACER	05 > 07	●●		78B40870	68B40781	
1130	TNT CENTURY RACER	11 >	●		78B40870	68B40781	
1130	TNT R 160	11 >	●●		78B40870	68B40781	
1130	TNT RS	05 > 06	●		78B40870	68B40781	
1130	TNT SPORT	05 >	●		78B40870	68B40781	
1130	TNT TITANIUM	05 > 07	●		78B40870	68B40781	
1130	TORNADO TRE	06 >	●		78B40870	68B40781	
1130	TORNADO TRE R	13 >	●		78B40870	68B40781	
1130	TRE K	06 > 07	●●		78B40870	68B40781	
1130	TRE K	11 >	●●		78B40870	68B40781	
1130	TRE K AMAZONAS	13 >	●		78B40870	68B40781	
<b>BETA</b>							
50	ARK	96 > 98	●	68B40716		68B40716	
50	ARK	99 >	●	68B40717		68B40716	
50	CHRONO "13"	94 >	●	68B40716			
50	EIKON	99 >	●	68B40716		68B40716	
50	QUADRA	95 > 96	●	68B40716			
50	QUADRA	97 >	●	68B40716		68B40716	
50	TEMPO "16"	00 >	●	68B40738			
125	EIKON	00 >	●	68B40730		68B40716	
150	EIKON	00 >	●	68B40730		68B40716	
250	RR	05 > 09	●		78B40814	68B40789	
250	RR	13 >	●	68B407B8		68B407F0	
300	RR	13 >	●	68B407B8		68B407F0	
350	RR	11 > 12	●		78B40814	68B40789	
350	RR	13 >	●	68B407B8		68B407F0	
400	RR	05 > 12	●		78B40814	68B40789	
400	RR	13 >	●	68B407B8		68B407F0	
400	RR ENDURO	05 > 12	●		78B40814	68B40789	
450	RR	05 > 12	●		78B40814	68B40789	
450	RR	13 >	●	68B407B8		68B407F0	
498	RR	12 >	●		78B40814	68B40789	
498	RR	13 >	●	68B407B8		68B407F0	
520	RR	10 > 11	●		78B40814	68B40789	
525	RR	05 > 09	●		78B40814	68B40789	
<b>BIMOTA</b>							
400	YB 7	89 >	●●		78B40870		
500	V-DUE	97 > 00	●●		78B40870		
650	BB1 SUPERMONO	96 > 00	●●		78B40870		
851	TESI	90 > 91	●●		78B40870		
904	DB2 SR	93 > 00	●●		78B40870		
904	DB3 MANTRA	95 > 00	●●		78B40870		
904	DB4	98 > 99	●●		78B40870		
1000	DB5	05 >	●●		78B40870		
1000	DB6 R DELIRIO	06 >	●●		78B40870		
1000	DIECI BIPOSTO	92 > 95	●●		78B40870		
1000	SB8 K GOBERT	04 > 06	●●		78B40870		
1000	SB8 R	97 > 00	●●		78B40870		
1100	SB6	96 > 00	●●		78B40870		
1100	SB6R	98 > 00	●●		78B40870		
1100	SB8K SANTAMONICA	04 >	●●		78B40870		
<b>BMW</b>							
125	C 1	99 >	●	68B407G2			
125	C 1 EXECUTIVE	00 >	●	68B407G2			
125	C 1 FRIENDS	01 >	●	68B407G2			
200	C 1	01 >	●	68B407G2			
200	C 1 EXECUTIVE	01 >	●	68B407G2			
200	C 1 FRIENDS	01 >	●	68B407G2			
450	R 45	78 > 86	●		178B40836		
600	C 600 SPORT	12 >	●●	68B407G0		68B407G0	
650	C 650 GT	12 >	●●	68B407G0		68B407G0	





				Fix	Floating	Fix	Floating
<b>BMW</b>							
650	F 650	93 > 01	●	68B407G5	78B40896	68B40781	
650	F 650 CS	02 > 07	●	68B407G5	78B40896	68B40781	
650	F 650 DAKAR	00 > 02	●			68B40781	
650	F 650 FL	93 > 00	●	68B407G5	78B40896	68B40781	
650	F 650 GS	00 > 07	●	68B407G5	78B40896	68B40781	
650	F 650 GS	08 >	●	68B407G5	78B40896	68B407C0	
650	F 650 GS ABS	00 > 07	●	68B407G5	78B40896	68B40781	
650	F 650 GS ABS	08 >	●	68B407G5	78B40896	68B40781	
650	F 650 ST	97 > 01	●	68B407G5	78B40896	68B40781	
650	G 650 GS	09 >	●	68B407G5	78B40896	68B40781	
650	G 650 XCHALLENGE	07 > 09	●	68B407G5	78B40896	68B40774	
650	G 650 XCOUNTRY	07 > 09	●	68B407G5	78B40896	68B40774	
650	G 650 XMOTO	07 > 09	●		78B40870	68B40781	
650	R 65	78 > 80	●		178B40836		
650	R 65 GS	87 > 92	●		178B40836		
650	R 65 RT	85 > 95	●		78B40892		
700	F 700 GS	13 >	●●		78B40896	68B407C0	
750	K 75	84 > 96	●	68B407D2		68B407D3	
750	K 75 C	85 > 91	●●	68B407D2			
750	K 75 RT	90 > 96	●	68B407D2		68B407D3	
750	K 75 S	85 > 88	●	68B407D2		68B407D3	
750	K 75 S	89 > 92	●●	68B407D2			
750	K 75 S	93 > 96	●	68B407D2		68B407D3	
800	F 800 ABS	04 > 07	●●	68B407D7 *			
800	F 800 ABS	08 > 13	●●	168B407D7			
800	F 800 GS	09 >	●		78B40896	68B407C0	
800	F 800 GS ADVENTURE	14 >	●●		78B40896	68B407C0	
800	F 800 GT	13 >	●●	168B407D7		68B407C0	
800	F 800 R	09 > 11	●●	168B407D7		68B407C0	
800	F 800 S	06 > 07	●●	68B407D7 *		68B407C0	
800	F 800 S	08 > 10	●●	168B407D7		68B407C0	
800	F 800 ST	06 > 07	●●	68B407D7 *		68B407C0	
800	F 800 ST	08 > 12	●			68B407C0	
800	R 80	81 > 95	●●		78B40892		
800	R 80 GS	87 > 87	●		78B40816		
800	R 80 GS	88 > 90	●		178B40836		
800	R 80 PD	91 > 95	●		78B40816		
800	R 80 R	91 > 95	●●		78B40892		
800	R 80 RT	83 > 95	●●		78B40892		
800	R 80 ST	80 > 92	●		178B40836		
850	R 850 C	98 > 01	●	68B407D6 *		68B407C8	
850	R 850 GS	98 > 07	●	68B407D6 *		68B407C8	
850	R 850 R	94 > 01	●		78B40846	68B407C8	
850	R 850 R	95 > 00	●			68B407C8	
850	R 850 R	02 > 07	●	68B407D6 *		68B407C8	
850	R 850 ROADSTER	95 > 00	●			68B407C8	
850	R 850 RT	95 > 01	●		78B40846	68B407C8	
850	R 850 RT	02 > 04	●	68B407D7 *		68B407C8	
850	R 850 RT ABS	95 > 01	●			68B407C8	
1000	K 1	89 > 93	●●		78B40846	68B407D3	
1000	K 100	83 > 89	●●	68B407D2		68B407D3	
1000	K 100 LT ABS	90 > 91	●	68B407D2		68B407D3	
1000	K 100 RS	83 > 91	●	68B407D2		68B407D3	
1000	K 100 RS 16V	89 > 93	●		78B40846	68B407D3	
1000	K 100 RT	84 > 89	●	68B407D2		68B407D3	
1000	R 100	76 > 80	●	68B407B1			
1000	R 100 CS	76 > 89	●●	68B407B1			
1000	R 100 GS	87 > 95	●		78B40892		
1000	R 100 PD	91 > 95	●		78B40892		
1000	R 100 R	91 > 96	●		78B40816	68B407C8	
1000	R 100 RS	85 > 95	●●		78B40816		
1000	R 100 RT	85 > 95	●●		78B40816		
1000	S 1000 R	14 >	●●	168B407D7		68B407F2	
1000	S 1000 RR	09 >	●	168B407D7		68B407F2	
1000	S 1000 RR HP4	13 >	●●		78B40888	68B407F2	
1000	S 1000 XR	15 >	●●	168B407D7		68B407C0	
1100	K 1100 LT ( no ABS )	93 > 00	●		78B40846	68B407D3	
1100	K 1100 RS	93 > 99	●●		78B40846		
1100	R 1100 GS	94 > 01	●●	68B407D6 *		68B407C8	
1100	R 1100 R	95 > 01	●●		78B40846	68B407C8	
1100	R 1100 R ROADSTER	95 > 01	●●		78B40846	68B407C8	
1100	R 1100 RS	85 > 93	●		78B40846	68B407C8	



				Fix	Floating	Fix	Floating
<b>BMW</b>							
1100	R 1100 RS	94 > 01	●●		78B40846		
1100	R 1100 RT	94 > 01	●		78B40846	68B407C8	
1100	R 1100 RT ABS	94 > 01	●●		78B40846	68B407C8	
1100	R 1100 S	98 > 00	●●	68B407D6 *		68B407C8	
1100	R 1100 S	01 > 06	●●	68B407D7 *		68B407C8	
1100	R 1100 S BOXER	03 > 06	●●	68B407D7 *		68B407C8	
1150	R 1150 GS	99 > 04	●●	68B407D6 *		68B407C8	
1150	R 1150 GS ADVENTURE	02 > 05	●●	68B407D6 *		68B407C8	
1150	R 1150 R	01 > 06	●●	68B407D7 *		68B407C8	
1150	R 1150 R ROCKSTER	03 > 06	●●	68B407D7 *		68B407C8	
1150	R 1150 RS	01 > 05	●●	68B407D7 *		68B407C8	
1150	R 1150 RT	01 > 05	●●	68B407D7 *		68B407C8	
1150	R 1150 RT ABS	01 > 05	●●	68B407D7 *		68B407C8	
1200	HP2 ENDURO	06 > 09	●	68B407D6 *		68B407C0	
1200	HP2 MEGAMOTO	07 > 07	●●	68B407D7 *		68B407C0	
1200	HP2 MEGAMOTO	08 > 10	●	168B407D7		68B407C0	
1200	HP2 SPORT	08 > 11	●●	168B407D7		68B407C0	
1200	K 1200 GT	02 > 07	●●	68B407D7 *			
1200	K 1200 GT	08 >	●●	168B407D7			
1200	K 1200 LT	99 > 01	●●	68B407D6 *			
1200	K 1200 LT	02 >	●●	68B407D7 *			
1200	K 1200 R	05 > 08	●●	68B407D7 *		68B407C0	
1200	K 1200 R SPORT	07 >	●●	68B407D7 *		68B407C0	
1200	K 1200 RS	97 > 00	●●	68B407D6 *			
1200	K 1200 RS	01 > 06	●●	68B407D7 *			
1200	K 1200 S	05 > 07	●●	68B407D7 *		68B407C0	
1200	K 1200 S	08 >	●●	168B407D7			
1200	K 1200 S ABS	05 > 07	●●	68B407D7 *		68B407C0	
1200	K 1200 S ABS	08 >	●●	168B407D7			
1200	R 1200 C	97 > 01	●●	68B407D6 *			
1200	R 1200 C CLASSIC	03 >	●●	68B407D6 *			
1200	R 1200 CL	02 > 06	●●	68B407D6 *			
1200	R 1200 CRUISER	97 > 01	●●	68B407D6 *			
1200	R 1200 GS	04 > 07	●			68B407C0	
1200	R 1200 GS	08 > 12	●●	168B407D6		68B407C0	
1200	R 1200 GS	13 >	●	168B407D6		68B407G9	
1200	R 1200 GS ABS	04 > 07	●			68B407C0	
1200	R 1200 GS ABS	08 > 12	●	168B407D6		68B407C0	
1200	R 1200 GS ABS	13 >	●	168B407D6		68B407G9	
1200	R 1200 GS ADVENTURE	06 > 07	●●	68B407D6 *		68B407C0	
1200	R 1200 GS ADVENTURE	08 > 12	●	168B407D6		68B407C0	
1200	R 1200 GS ADVENTURE	14 >	●	168B407D6		68B407G9	
1200	R 1200 R	06 > 07	●●	68B407D7 *		68B407C0	
1200	R 1200 R	08 > 12	●●	168B407D7		68B407C0	
1200	R 1200 R	15 >	●	168B407D7		68B407G9	
1200	R 1200 R DARK WHITE	14 >	●●	168B407D6		68B407C0	
1200	R 1200 RS	15 >	●	168B407D7		68B407G9	
1200	R 1200 RT	05 > 07	●●	68B407D7 *		68B407C0	
1200	R 1200 RT	08 > 12	●●	168B407D7		68B407C0	
1200	R 1200 RT	14 >	●	168B407D7		68B407G9	
1200	R 1200 S	06 > 07	●●	68B407D7 *		68B407C0	
1200	R 1200 S	08 >	●●	168B407D7		68B407C0	
1200	R 1200 ST	05 > 07	●●	68B407D7 *		68B407C0	
1200	R 1200 ST	08 >	●	168B407D7		68B407C0	
1200	R NINE T	14 >	●●	168B407D7		68B407C0	
1300	K 1300 GT	09 > 10	●●	168B407D7			
1300	K 1300 R	08 > 13	●●	168B407D7		68B407C0	
1300	K 1300 S	09 > 12	●●	168B407D7		68B407C0	
1300	K 1300 S	15 >	●●	168B407D7		68B407C0	
1600	K 1600 GT	11 > 12	●●	168B407D7			
1600	K 1600 GTL	11 > 12	●●	168B407D7			
<b>BS VILLA</b>							
50	AX	93 >	●	68B40710			
50	GZ	93 >	●	68B40710			
50	ZX	93 >	●	68B40710			
<b>BUELL</b>							
1200	M2	98 > 02	●			68B40780	
1200	M2 CYCLONE	98 > 02	●			68B40780	
1200	S1 LIGHTNING	98 > 02	●			68B40780	
1200	S3 THUNDERBOLT	98 > 02	●			68B40780	
1200	S3T THUNDERBOLT	98 > 02	●			68B40780	







				Fix	Floating	Fix	Floating
<b>BUELL</b>							
1200	X1	98 > 02	●			68B40780	
<b>CAGIVA</b>							
50	CITY	92 > 94	●	68B40711			
50	CITY LUCKY	95 >	●	68B40711			
80	CITY	93 >	●	68B40711			
125	MITO	90 > 90	●		78B40870		
125	MITO	91 > 94	●		78B40870		
125	MITO 2	92 >	●		78B40870		
125	MITO 525	06 > 10	●		78B40870		
125	MITO EV	95 > 07	●		78B40870		
125	PLANET	97 > 03	●		78B40870		
125	PLANET	04 > 07	●		78B40870		
125	RAPTOR	04 > 06	●		78B40870		
125	SUPER CITY	92 > 00	●		78B40870		
500	RIVER	99 > 01	●●		78B40870		
600	RIVER	95 > 99	●		78B40870		
750	ELEFANT	94 > 95	●			68B40780	
900	ELEFANT I.E.	90 > 96	●			68B40780	
900	GRAN CANYON	99 > 04	●			68B40780	
<b>CCM</b>							
644	DS	02 > 06	●			68B40752	
644	R30	02 > 06	●			68B40752	
<b>DAELIM</b>							
50	MESSAGE II	98 >	●	68B40711			
50	VIVO	99 >	●	68B40711			
100	DELFINO	99 >	●	68B40711			
125	ROADWIN FI	11 > 12	●	68B407E9			
125	ROADWIN R FI	99 > 00	●	68B407E9			
125	ROADWIN R FI	11 > 12	●	68B407E9			
125	ROCKET	99 > 00	●	68B407E9			
125	VL DAYSTAR CLASSIC	00 > 03	●	68B407E9			
125	VL DAYSTAR FI	00 > 12	●	68B407E9			
125	VT EVOLUTION	99 > 11	●	68B407E9			
<b>DERBI</b>							
50	GP1	01 > 02	●			68B40713	
50	GP1 REPLICA	01 > 02	●			68B40713	
50	VAMOS	95 > 97	●	68B40710			
125	BOULEVARD S	07 >	●	68B407B0		68B40732	
125	PREDATOR	99 >	●	68B40730		68B40713	
125	RAMBLA	09 > 11	●	68B407B0		68B40732	
180	PREDATOR	99 >	●	68B40730		68B40713	
250	RAMBLA	09 >	●	68B407B0		68B40732	
300	RAMBLA	10 > 11	●●	68B407B0		68B40732	
<b>DUCATI</b>							
350	350 SUPERSPORT	91 > 92	●		78B40870	68B40791	
400	400 SUPERSPORT	93 > 97	●		78B40870	68B40791	
400	MONSTER 400	95 > 97	●		78B40870	68B40791	
400	MONSTER 400 DARK	03 >	●		78B40870	68B40791	
400	MONSTER 400	01 > 06	●		78B40870	68B40791	
400	SCRAMBLER	15 >	●			68B40791	
600	600 SUPERSPORT	91 > 00	●		78B40870	68B40791	
600	MONSTER 600	93 > 02	●		78B40870	68B40791	
600	MONSTER 600	98 >	●		78B40870	68B40791	
600	MONSTER 600 DARK	98 >	●		78B40870	68B40791	
600	MONSTER 600 DARK	00 > 01	●		78B40870	68B40791	
600	MONSTER 600 DARK CITY	99 >	●		78B40870	68B40791	
600	MONSTER 600 DARK CITY	00 > 01	●		78B40870	68B40791	
600	MONSTER 600 METALLIC	00 > 01	●		78B40870	68B40791	
620	MONSTER 620 DARK (MONODISCO)	04 > 05	●		78B40870	68B40791	
620	MONSTER 620 I.E.	05 > 06	●●		78B40850	68B40791	
620	MONSTER 620 S I.E.	02 > 04	●		78B40870	68B40791	
620	MULTISTRADA 620 (BIDISCO)	04 >	●●		78B40850	68B40791	
620	MULTISTRADA 620 SD	04 > 06	●		78B40870	68B40791	
620	SPORT	03 > 04	●		78B40870	68B40791	
620	SUPERSPORT	02 > 05	●●		78B40870	68B40791	
695	MONSTER 695	06 > 07	●●		78B40850	68B40791	
696	MONSTER 696	08 > 12	●		78B40870	68B40791	
696	MONSTER 696	13 >	●●		78B40885	68B40791	
696	MONSTER 696 ABS	08 > 12	●		78B40870	68B40791	
696	MONSTER 696 ABS	13 >	●●		78B40885	68B40791	



				Fix	Floating	Fix	Floating
<b>DUCATI</b>							
696	MONSTER 696 ANNIVERSARY / ABS	13 >	●●		78B40885	68B40791	
748	748	00 > 02	●●		78B40870		
748	748 BIPOSTO	95 > 98	●●		78B40870		
748	748 BIPOSTO	99 > 02	●●		78B40870		
748	748 R	00 > 00	●●		78B40870		
748	748 S	99 > 02	●●		78B40870		
748	748 SP	95 > 97	●●		78B40870		
748	748 SPS	98 > 99	●●		78B40870		
748	749	03 > 07	●		78B40880	68B40768	
748	749 DARK	03 > 07	●		78B40880	68B40768	
748	749 R	03 > 07	●		78B40880	68B40768	
748	749 S	03 > 07	●●		78B40880	68B40768	
750	750 SPORT	01 > 02	●		78B40870	68B40791	
750	750 SUPERSPORT	91 > 99	●		78B40870	68B40791	
750	750 SUPERSPORT I.E.	00 > 02	●		78B40870	68B40791	
750	MONSTER 750 DARK I.E.	02 >	●		78B40870	68B40791	
750	MONSTER 750	94 > 01	●●		78B40870	68B40791	
750	MONSTER 750	00 > 01	●●		78B40870	68B40791	
750	MONSTER 750 (BIDISCO)	96 > 97	●		78B40870	68B40791	
750	MONSTER 750 (MONODISCO)	96 > 97	●		78B40870	68B40791	
750	MONSTER 750 DARK	00 > 01	●		78B40870	68B40791	
750	MONSTER 750 METALLIC	00 > 01	●		78B40870	68B40791	
795	MONSTER 795	12 > 13	●●		78B40885	68B40791	
795	MONSTER 795	14 >	●●		78B40885	68B40791	
795	MONSTER 795 ABS	13 >	●●		78B40885	68B40791	
795	MONSTER 795 ABS CORSE STRIPE	14 >	●●		78B40885	68B40791	
796	HYPERMOTARD	10 > 12	●		78B40845	68B40792	
796	MONSTER	10 >	●●		78B40878	68B40792	
796	MONSTER ABS	10 > 12	●		78B40878	68B40792	
796	MONSTER ABS ANNIVERSARY	13 >	●●		78B40878	68B40792	
796	MONSTER ANNIVERSARY	13 >	●●		78B40878	68B40792	
803	800 SPORT	03 > 04	●●		78B40870	68B40791	
803	MONSTER 800 S I.E.	03 > 04	●		78B40870	68B40791	
803	MONSTER S2 R	05 > 06	●		78B40850	68B40792	
803	MONSTER S2 R DARK	05 > 06	●		78B40850	68B40792	
803	SCRAMBLER CLASSIC	15 >	●			68B40791	
803	SCRAMBLER FULL THROTTLE	15 >	●			68B40791	
803	SCRAMBLER ICON	15 >	●			68B40791	
803	SCRAMBLER URBAN ENDURO	15 >	●			68B40791	
803	SUPERSPORT 800	06 >	●		78B40870	68B40791	
803	SUPERSPORT 800 S	03 > 04	●●		78B40870	68B40791	
820	HYPERMOTARD	13 >	●		78B40878	68B40792	
820	HYPERMOTARD SP	13 >	●		78B40878	68B40792	
820	HYPERMOTARD TOURING	13 >	●		78B40878	68B40792	
820	HYPERSTRADA	13 >	●		78B40878	68B40792	
821	HYPERMOTARD SP	15 >	●		78B40878	68B40792	
821	MONSTER 821	15 >	●●		78B40878	68B40791	
821	MONSTER 821 DARK	15 >	●●		78B40878	68B40791	
821	MONSTER 821 STRIPE	15 >	●●		78B40878	68B40791	
848	848	08 > 10	●		78B40880	68B40792	
848	848 EVO	11 >	●●		78B40890	68B40792	
848	848 EVO CORSE SPECIAL EDITION	12 >	●●		78B40890	68B40792	
848	848 SUPERBIKE	13 >	●		78B40880	68B40792	
848	STREETFIGHTER	12 >	●●		78B40886	68B40792	
848	STREETFIGHTER S	12 >	●●		78B40886	68B40792	
851	851	89 > 91	●		78B40870	68B40791	
851	851 SP 5	93 >	●		78B40870	68B40791	
851	851 SP2	90 >	●		78B40870	68B40791	
851	851 SP3	91 >	●		78B40870	68B40791	
851	851 SP4	92 >	●●		78B40870	68B40791	
888	888 SP	90 > 93	●		78B40870	68B40791	
888	888 SUPERBIKE STRADA	94 > 95	●●		78B40870	68B40791	
899	PANIGALE	14 >	●●		78B40880	68B40791	
900	900 SUPERSPORT	89 > 90	●		78B40870	68B40791	
900	900 SUPERSPORT	91 > 99	●		78B40870	68B40791	
900	900 SUPERSPORT I.E.	00 > 02	●		78B40870	68B40791	
900	900 SUPERSPORT S I.E.	02 >	●		78B40870	68B40791	
900	MH 900 EVOLUTION	01 > 02	●●		78B40870		
900	MONSTER 900	93 > 99	●		78B40870	68B40791	
900	MONSTER 900 CROMO	98 >	●●		78B40870	68B40791	
900	MONSTER 900 CROMO I.E.	00 > 01	●		78B40870	68B40791	
900	MONSTER 900 DARK CITY	99 >	●		78B40870	68B40791	





				Fix	Floating	Fix	Floating
<b>DUCATI</b>							
900	MONSTER 900 DARK I.E.	00 > 02	●		78B40870	68B40791	
900	MONSTER 900 I.E.	00 >	●		78B40870	68B40791	
900	MONSTER 900 METALLIC I.E.	00 > 01	●		78B40870	68B40791	
900	MONSTER 900 S I.E.	00 > 01	●		78B40870	68B40791	
900	MONSTER 900 SPECIAL	98 >	●		78B40870	68B40791	
900	SPORT	02 >	●		78B40870	68B40791	
900	SUPERLIGHT 900	92 > 92	●		78B40870	68B40791	
900	SUPERLIGHT 900	93 > 97	●		78B40870	68B40791	
907	907 I.E.	90 > 91	●			68B40791	
907	907 I.E.	92 > 93	●●		78B40870	68B40791	
916	916	94 > 96	●●		78B40870		
916	916 BIPOSTO SENNA	94 > 98	●●		78B40870		
916	916 RACING	94 > 97	●●		78B40870		
916	916 S	94 > 96	●●		78B40870		
916	916 SP	94 > 96	●●		78B40870		
916	916 SPS	97 > 98	●●		78B40870		
916	MONSTER S4	01 > 03	●		78B40870	68B40791	
916	MONSTER S4 FOGGY	02 >	●		78B40870	68B40791	
916	ST4	98 > 04	●		78B40870	68B40791	
916	ST4 S	03 >	●		78B40870	68B40791	
944	ST2	97 > 03	●		78B40870	68B40791	
996	996	99 > 01	●●		78B40870		
996	996 R	01 >	●●		78B40870		
996	996 S	99 > 01	●●		78B40870		
996	996 SPS	99 > 01	●●		78B40870		
996	996 SPS II	99 > 01	●●		78B40870		
996	996 SPS III	99 > 01	●●		78B40870		
996	ST4 S	01 > 05	●		78B40870	68B40791	
998	998	02 >	●●		78B40870		
998	998 F.E.	02 >	●●		78B40870		
998	998 MATRIX	02 >	●●		78B40870		
998	998 S	02 >	●●		78B40870		
998	999	03 > 07	●		78B40880	68B40768	
998	999 R	03 > 07	●		78B40880	68B40768	
998	999 S	03 > 07	●		78B40880	68B40768	
999	999 XEROX	03 > 07	●●		78B40880	68B40768	
1000	1000SS S	03 >	●		78B40870	68B40791	
1000	1100SS	03 > 06	●●		78B40870	68B40791	
1000	DESMOSEDICI RR	08 >	●●		78B40890	68B40768	
1000	GT 1000 TOURING	06 > 10	●		78B40870	68B40791	
1000	MONSTER 1000 S I.E.	03 > 05	●		78B40870	68B40791	
1000	MONSTER S2 R 1000	06 > 07	●		78B40870	68B40791	
1000	MONSTER S2 R 1000 DARK	06 > 07	●●		78B40850	68B40791	
1000	MONSTER S4 1000 R	03 > 04	●●		78B40870	68B40792	
1000	MONSTER S4 1000 R (MONOBRACCIO)	05 > 06	●●		78B40870	68B40792	
1000	MONSTER S4 1000 RS	06 >	●		78B40880	68B40792	
1000	MULTISTRADA / S	03 > 06	●●	68B407F3		68B40792	
1000	PAUL SMART I.E.	06 > 07	●		78B40870	68B40791	
1000	SPORT	06 > 08	●●		78B40870	68B40791	
1000	SPORT S	07 >	●		78B40870	68B40791	
1000	ST3	04 > 06	●		78B40870	68B40791	
1000	ST3 S ABS	06 > 07	●●		78B40870	68B40791	
1098	1098 / R / S / TRICOLORE	07 >	●		78B40890	68B407E8	
1098	STREETFIGHTER	09 >	●		78B40890	68B407E8	
1098	STREETFIGHTER S	09 >	●		78B40890	68B407E8	
1100	HYPERMOTARD	07 > 09	●		78B40845	68B40792	
1100	HYPERMOTARD EVO	10 > 12	●		78B40845	68B40792	
1100	HYPERMOTARD EVO SP	10 > 12	●●		78B40845	68B40792	
1100	HYPERMOTARD S	07 > 09	●		78B40845	68B40792	
1100	MONSTER	09 >	●●		78B40878	68B40792	
1100	MONSTER EVO ABS	11 >	●		78B40878	68B407H0	
1100	MONSTER EVO ABS ANNIVERSARY	11 >	●		78B40878	68B407H0	
1100	MONSTER S	09 > 10	●		78B40880	68B40792	
1100	MULTISTRADA / S	07 > 09	●●		78B40878	68B407H1	
1198	1098 BAYLISS	09 >	●		78B40890	68B407E8	
1198	1098 R	09 >	●		78B40890	68B407E8	
1198	1198	09 >	●		78B40890	68B407E8	
1198	1198 S	09 >	●●		78B40890	68B407E8	
1198	1198 SP	11 >	●		78B40890	68B407E8	
1199	PANIGALE	12 >	●		78B40890	68B407H1	
1199	PANIGALE R	13 >	●		78B40890	68B407H1	
1199	PANIGALE S	12 >	●		78B40890	68B407H1	



				Fix	Floating	Fix	Floating
--	--	--	--	-----	----------	-----	----------

**DUCATI**

1199	PANIGALE S ABS	12 >	●		78B40890	68B407H1	
1199	PANIGALE S TRICOLORE ABS	12 >	●		78B40890	68B407H1	
1199	SUPERLEGGERA	14 >	●		78B40890	68B407H1	
1200	DIAVEL	11 >	●		78B40878	68B407H2	
1200	DIAVEL CARBON	13 >	●		78B40878	68B407H2	
1200	DIAVEL DARK	13 >	●●		78B40878	68B407H2	
1200	DIAVEL STRADA	13 >	●		78B40878	68B407H2	
1200	DIAVEL TITANIUM	15 >	●		78B40878	68B407H2	
1200	MONSTER	14 >	●		78B40878	68B407H1	
1200	MONSTER R	15 >	●●		78B408A4	68B407H1	
1200	MONSTER S	14 >	●●		78B408A4	68B407H1	
1200	MONSTER S STRIPE	15 >	●		78B408A4	68B407H1	
1200	MULTISTRADA	10 > 12	●●		78B40878	68B407H1	
1200	MULTISTRADA	15 >	●●		78B40878	68B407H2	
1200	MULTISTRADA ABS	10 >	●		78B40878	68B407H1	
1200	MULTISTRADA S	15 >	●●		78B408A4	68B407H2	
1200	MULTISTRADA S D-AIR	15 >	●●		78B408A4	68B407H2	
1200	MULTISTRADA S GT	13 >	●		78B40878	68B407H1	
1200	MULTISTRADA S PIKES PEAK	13 >	●		78B40878	68B407H1	
1200	MULTISTRADA S SPORT	11 > 12	●●			68B407H1	
1200	MULTISTRADA S TOURING	13 >	●		78B40878	68B407H1	
1200	MULTISTRADA TOURING ABS	10 >	●●		78B40878		
1299	PANIGALE	15 >	●●		78B40890	68B407H1	
1299	PANIGALE R	15 >	●		78B40890	68B407H1	
1299	PANIGALE S	15 >	●		78B40890	68B407H1	

**FANTIC MOTOR**

50	BIG WHEEL	91 > 94	●	68B40710			
50	FLYING TIGER	96 >	●	68B40710			
50	GRINTA	95 >	●	68B40710			
50	LEADER	95 >	●	68B40717			
50	QUEENIE	95 >	●	68B40710			
50	SPIKE	96 >	●	68B40711			

**GARELLI**

150	MOSQUITO	08 >	●	68B40740		68B40740	
-----	----------	------	---	----------	--	----------	--

**GAS GAS**

125	EC	96 > 11	●			68B40752	
125	MC	96 > 09	●			68B40752	
200	EC	04 > 07	●			68B40752	
200	HOBBY	07 >	●			68B40752	
250	EC	96 > 09	●			68B40752	
250	EC 2T	96 > 09	●			68B40752	
250	EC 4T	96 > 09	●			68B40752	
250	EC F RACING	13 >	●			68B40752	
250	EC RACING	12 >	●			68B40752	
250	MC	96 > 09	●			68B40752	
300	EC	96 > 09	●			68B40752	
300	EC 2T	13 >	●			68B40752	
300	EC F RACING	13 >	●			68B40752	
300	EC RACING	12 >	●			68B40752	
300	MC	96 > 09	●			68B40752	
400	EC	02 > 05	●			68B40752	
400	EC	06 > 07	●			68B40752	
400	FSE	04 > 07	●			68B40752	
400	MC	02 > 05	●			68B40752	
400	MC	06 > 07	●			68B40752	
400	PAMPERA	06 > 07	●			68B40752	
450	EC	03 > 07	●			68B40752	
450	FSE	03 > 07	●			68B40752	
450	FSR	07 >	●			68B40752	
450	MC	03 > 06	●			68B40752	
450	MC	07 >	●			68B40752	
450	PAMPERA	07 > 08	●			68B40752	

**GILERA**

50	DNA	00 >	●			68B40776	
50	EASY MOVING	97 >	●	68B40710			
50	ICE	99 >	●	68B40722			
50	RUNNER	94 > 00	●	68B40730			
50	RUNNER	01 >	●	68B40730		68B40713	
50	RUNNER DD	96 >	●	68B40730		68B40713	
50	RUNNER PURE JET	03 >	●	68B40730		68B40713	
50	RUNNER RACING REPLICA	03 >	●	68B40730		68B40713	





				Fix	Floating	Fix	Floating
--	--	--	--	-----	----------	-----	----------

## GILERA

50	RUNNER SP	00 > 01	●	68B40730		68B40713	
50	RUNNER SP	06 >	●	68B40730		68B40713	
50	STALKER	98 >	●	68B40717		68B40713	
50	STORM	96 > 01	●	68B40717		68B40713	
50	TYPHOON	96 >	●	68B40717			
50	TYPHOON BENETTON	93 > 95	●	68B40717			
50	TYPHOON MARTINI	96 >	●	68B40717			
50	TYPHOON XR	96 >	●	68B40717			
125	DNA	01 > 03	●	68B40776		68B40776	
125	GFR	93 >	●		78B40870		
125	KZ	86 >	●	68B40772		68B40772	
125	NEXUS	07 > 09	●	68B407B6		68B40777	
125	NEXUS IE	10 >	●	68B407B6		68B40777	
125	RUNNER	95 > 05	●	68B40717			
125	RUNNER	06 >	●	68B40730		68B40776	
125	RUNNER FX (GRIMECA CALIPER)	97 > 05	●	68B40730		68B40776	
125	RUNNER FX (HENGTONG CALIPER)	97 > 05	●	68B40730		68B40776	
125	RUNNER FX SP (GRIMECA CALIPER)	98 > 05	●	68B40730		68B40776	
125	RUNNER FX SP (HENGTONG CALIPER)	98 > 05	●	68B40730		68B40776	
125	RUNNER ST	08 >	●	68B40774		68B40776	
125	RUNNER VX 4T (GRIMECA CALIPER)	99 > 04	●	68B40730		68B40776	
125	RUNNER VX 4T (GRIMECA CALIPER)	05 > 07	●	68B40774		68B40738	
125	RUNNER VX 4T (HENGTONG CALIPER)	99 > 04	●	68B40730		68B40776	
125	RUNNER VX 4T (HENGTONG CALIPER)	05 > 07	●	68B40774		68B40738	
125	TYPHOON XR	95 >	●	68B40717			
180	DNA	01 > 03	●	68B40776		68B40776	
180	RUNNER FXR	98 > 04	●	68B40730		68B40776	
180	RUNNER FXR SP (GRIMECA CALIPER)	99 > 05	●	68B40730		68B40776	
180	RUNNER FXR SP (HENGTONG CALIPER)	99 > 05	●	68B40730		68B40776	
180	RUNNER SP	98 >	●	68B40730		68B40776	
180	RUNNER VXR	99 >	●	68B40730		68B40776	
180	RUNNER VXR	00 >	●	68B40730		68B40776	
200	HERCULES	02 >	●	68B40730		68B40776	
200	RUNNER SP	01 > 02	●	68B40730		68B40776	
200	RUNNER VXR	01 > 04	●	68B40730		68B40738	
200	RUNNER VXR	05 > 08	●	68B40774		68B40738	
250	NEXUS	06 > 08	●	68B407B6		68B40777	
300	NEXUS	08 >	●	68B407B6		68B40777	
500	FUOCO I.E.	07 > 11	●	68B40774		68B40777	
500	NEXUS	04 > 13	●	68B407B6		68B40777	
500	NEXUS I.E. SP	06 > 08	●●	68B407B6		68B40777	

## HARLEY DAVIDSON

883	XL 883 R ROADSTER	10 > 11	●		78B40891		
883	XL 883 R SPORTSTER	00 > 03	●		78B40891		
883	XL 883 SPORTSTER CUSTOM	04 > 10	●		78B40891		78B40828
883	XL L IRON	09 > 13	●		78B40891		
883	XL L SPORTSTER LOW	07 > 13	●		78B40891		
883	XL SPORTSTER CUSTOM	00 > 03	●		78B40891		78B40828
883	XLH 883	70 > 84	●		78B40822	68B407E0	
883	XLH 883 SPORTSTER	85 > 99	●		78B40822	68B407E0	
883	XLH 883 SPORTSTER	00 > 06	●		78B40891		78B40828
883	XLH 883 SPORTSTER HUGGER	00 > 03	●		78B40891		78B40828
1000	XL	78 > 81	●		78B40822	68B407E0	
1000	XLS ROADSTER	79 > 84	●		78B40822	68B407E0	
1130	VRSCA V-ROD	02 > 05	●				78B40828
1200	XL 1200 R	00 > 06	●●		78B40891		
1200	XL 1200 R SPORTSTER ROADSTER	04 > 08	●●		78B40891		
1200	XL 1200 SPORTSTER	04 > 06	●		78B40891		78B40828
1200	XL 1200 SPORTSTER CUSTOM	00 > 03	●		78B40891		78B40828
1200	XL 1200 SPORTSTER NIGHTSTER	07 > 13	●		78B40891		78B40828
1200	XL 1200 SPORTSTER SPORT	00 > 03	●		78B40891		78B40828
1200	XL C SPORTSTER CUSTOM	04 > 13	●		78B40891		78B40828
1200	XL L SPORTSTER LOW	07 > 13	●		78B40891		
1200	XL R SPORTSTER FORTY EIGHT	10 > 11	●		78B40891		
1200	XL S SPORT	00 > 03	●		78B40891		78B40828
1200	XLH 1200 SPORT	96 > 99	●●		78B40822		
1200	XLH 1200 SPORTSTER	87 > 99	●		78B40822	68B407E0	
1200	XLH 1200 SPORTSTER	00 > 03	●		78B40891		78B40828
1200	XR 1200	08 > 10	●●		78B40891		
1200	XR 1200 X	10 > 12	●●		78B40891		
1340	FLH 1340 ELECTRA GLIDE	82 > 83	●		78B40822	68B407E0	
1340	FLH 80	81 > 99	●		78B40822	68B407E0	





				Fix	Floating	Fix	Floating
--	--	--	--	-----	----------	-----	----------

**HARLEY DAVIDSON**

1340	FLSTC FAT BOY	89 > 99	●		78B40822	68B407E0	
1340	FLSTC FAT BOY	00 > 02	●		78B40891		78B40828
1340	FLSTC HERITAGE SOFTAIL CLASSIC	89 > 99	●		78B40822	68B407E0	
1340	FLSTC HERITAGE SOFTAIL CLASSIC	00 > 02	●		78B40891		78B40828
1340	FLSTF FAT BOY	89 > 99	●		78B40822	68B407E0	
1340	FXDWG DYNA WIDE GLIDE	93 > 98	●		78B40822	68B407E0	
1340	FXLR 1340 LOW RIDER CUSTOM	87 > 99	●		78B40822	68B407E0	
1340	FXLR 1340 LOW RIDER CUSTOM	00 >	●		78B40891		78B40828
1340	FXR 1340 SUPER GLIDE	82 > 99	●		78B40822	68B407E0	
1340	FXRS 1340 LOW RIDER SPORT	87 > 99	●		78B40822	68B407E0	
1340	FXRS LOW RIDER SPORT	87 > 99	●		78B40822	68B407E0	
1340	FXRT 1340 SPORT GLIDE	87 > 99	●		78B40822	68B407E0	
1340	FXSTC 1340 SOFTAIL CUSTOM	89 > 99	●		78B40822	68B407E0	
1340	FXSTS 1340 SPRINGER SOFTAIL	89 > 99	●		78B40822	68B407E0	
1340	FXSTS 1340 SPRINGER SOFTAIL	00 > 02	●		78B40891		78B40828
1450	FLHR/I ROAD KING	98 > 99	●		78B40822	68B407E0	
1450	FLHR/I ROAD KING	00 > 07	●●		78B40891		78B40828
1450	FLHRCI ROAD KING CLASSIC	00 > 06	●				78B40828
1450	FLHT/I ELECTRA GLIDE STANDARD	98 > 99	●		78B40822	68B407E0	
1450	FLHT/I ELECTRA GLIDE STANDARD	00 > 06	●●		78B40891		78B40828
1450	FLHTCUI ELECTRA GLIDE ULTRA CLAS.	00 > 06	●		78B40891		78B40828
1450	FLSTC HERITAGE SOFTAIL CLASSIC	00 > 06	●		78B40891		78B40828
1450	FLSTF FAT BOY	00 > 06	●		78B40891		78B40828
1450	FLSTS/I HERITAGE SPRINGER	00 > 03	●		78B40891		78B40828
1450	FLTR/I ROAD GLIDE	98 > 99	●		78B40822	68B407E0	
1450	FLTR/I ROAD GLIDE CLASSIC	00 > 07	●		78B40891		78B40828
1450	FXD DYNA SUPER GLIDE	00 > 03	●		78B40891		78B40828
1450	FXD DYNA SUPER GLIDE	06 > 07	●				78B40828
1450	FXDC DYNA SUPER GLIDE CUSTOM	06 > 07	●				78B40828
1450	FXDL DYNA GLIDE LOW RIDER	00 > 06	●		78B40891		78B40828
1450	FXDS DYNA SUPER GLIDE SPORT	98 > 99	●		78B40822	68B407E0	
1450	FXDS DYNA SUPER GLIDE SPORT	00 > 06	●●		78B40891		78B40828
1450	FXDWG DYNA WIDE GLIDE	93 > 99	●		78B40822	68B407E0	
1450	FXDWG DYNA WIDE GLIDE	00 > 07	●		78B40891		78B40828
1450	FXDX DYNA SUPER GLIDE T-SPORT	00 > 05	●		78B40891		78B40828
1450	FXRS SPORT GLIDE	84 > 86	●●		78B40822	68B407E0	
1450	FXRT TOUR GLIDE	84 > 86	●		78B40822	68B407E0	
1450	FXST SOFTAIL STANDARD	00 > 07	●		78B40891		78B40828
1450	FXSTB ICE BOB	00 > 03	●		78B40822	68B407E0	
1450	FXSTB/I NIGHT TRAIN	00 > 07	●		78B40891		78B40828
1450	FXSTC SOFTAIL CUSTOM	00 > 06	●●		78B40891		
1450	FXSTD SOFTAIL DEUCE	00 > 06	●		78B40891		78B40828
1450	FXSTS/I SPRINGER SOFTAIL	00 > 06	●		78B40891		78B40828
1584	FLHRCI ROAD KING CLASSIC	07 > 07	●		78B40891		78B40828
1584	FLHT/I ELECTRA GLIDE STANDARD	07 > 07	●		78B40891		78B40828
1584	FLHTCUI ELECTRA GLIDE ULTRA CLAS.	07 > 08	●		78B40891		78B40828
1584	FLHX STREET GLIDE	06 > 07	●		78B40891		78B40828
1584	FLSTB FAT BOY SPECIAL	10 > 13	●		78B40891		78B40828
1584	FLSTB SOFTAIL CROSS BONES	08 > 11	●		78B40891		78B40828
1584	FLSTC HERITAGE SOFTAIL CLASSIC	07 > 14	●		78B40891		78B40828
1584	FLSTF FAT BOY	07 > 14	●		78B40891		78B40828
1584	FLSTSE CVO SOFTAIL CONVERTIBLE	10 > 11	●		78B40891		78B40828
1584	FXCW ROCKER	08 > 09	●		78B40891		78B40828
1584	FXCWC ROCKER C	08 > 13	●		78B40891		78B40828
1584	FXD DYNA SUPER GLIDE	08 > 10	●				78B40828
1584	FXDB DYNA STREET BOB	08 > 14	●				78B40828
1584	FXDC DYNA SUPER GLIDE CUSTOM	08 > 14	●				78B40828
1584	FXDF FAT BOB	08 > 14	●				78B40828
1584	FXDL DYNA LOW RIDER	07 > 10	●				78B40828
1584	FXDWG DYNA WIDE GLIDE	08 > 14	●				78B40828
1584	FXS BLACKLINE	11 > 13	●		78B40891		78B40828
1584	FXSTB NIGHT TRAIN	08 > 10	●		78B40891		78B40828
1584	FXSTC SOFTAIL CUSTOM	08 > 10	●		78B40891		78B40828
1584	FXSTSS CVO SOFTAIL SPRINGER	09 > 09	●		78B40891		78B40828
1690	FLD SWITCHBACK	12 > 14	●●				78B40828
1690	FLS SOFTAIL SLIM	12 > 14	●●				78B40828

**HM**

125	CR E SUPERMOTARD	00 > 01	●			68B40786	
125	CR E SUPERMOTARD	02 > 03	●			68B40786	
125	CR E SUPERMOTARD	04 > 08	●			68B40786	
125	CRE F X	08 >	●			68B40748	
125	CRE SUPERMOTARD	03 > 03	●			68B40786	





				Fix	Floating	Fix	Floating
<b>HM</b>							
125	CRE SUPERMOTARD	04 > 08	●			68B40786	
125	CRM F X	08 >	●			68B40748	
230	CR F ENDURO	04 > 10	●	68B40796		68B40786	
230	CR F SUPERMOTARD	04 > 06	●			68B40786	
250	CR E SUPERMOTARD	00 > 01	●			68B40786	
250	CR E SUPERMOTARD	02 > 05	●			68B40786	
250	CR E SUPERMOTARD	06 > 09	●			68B40786	
250	CRE F	04 > 09	●	68B40796		68B40786	
250	CRE SUPERMOTARD	03 > 05	●			68B40786	
250	CRE X	04 > 09	●	68B40796		68B40786	
250	CRE X ENDURO	04 > 09	●	68B40796		68B40786	
250	CRF R SUPERMOTARD	04 > 08	●			68B40786	
250	CRF X SUPERMOTARD	04 > 08	●			68B40786	
450	CRF R	02 >	●	68B40796		68B40786	
450	CRF R SUPERMOTARD	02 > 03	●			68B40786	
450	CRF X SUPERMOTARD	04 > 09	●			68B40786	
<b>HONDA</b>							
50	BALI SJ	94 >	●	68B40716			
50	CRM	97 > 02	●	68B40769			
50	GP DIO	94 >	●	68B40711			
50	HM MOTO	95 >	●	68B40767			
50	NS AERO	90 > 97	●	68B40711			
50	SFX	88 > 96	●	68B40711			
50	SH FIFTY	96 >	●	68B40767			
50	SHADOW	98 > 99	●	68B40716			
50	SHADOW	00 >	●	68B40716			
50	SJ BALI	96 > 02	●	68B40716			
50	SKY	96 >	●	68B40716			
50	SKY ANNIVERSARIO	99 > 00	●	68B40716			
50	SKY CLASSIC	96 >	●	68B40716			
50	SKY DELUXE	99 > 02	●	68B40716			
50	SKY STD	97 > 02	●	68B40716			
50	SKY VETRO	99 > 01	●	68B40716			
50	SKY VETRO	00 >	●	68B40716			
50	SR DIO	90 > 93	●	68B40711			
50	SR DIO	00 >	●	68B40711			
50	SXR	98 > 00	●	68B40711			
50	SXR SHADOW	90 > 93	●	68B40711			
50	VISION	12 >	●	68B40759			
50	X8R S/X	98 > 04	●			68B40720	
50	ZX DIO	98 >	●	68B40711			
75	AX 1	89 >	●	68B40769			
75	CRM	95 > 99	●	68B40769			
75	SHADOW	88 >	●	68B40716			
90	SHADOW	98 >	●	68B40716			
90	YUPY	98 >	●	68B40716			
100	CHIOCCIOLA NES	95 >	●	68B40740			
100	SH FIFTY	96 >	●	68B40767			
100	SJ BALI	95 >	●	68B40716			
110	LEAD	08 >	●	68B40716			
110	VISION	12 >	●	68B40759			
125	@ NES	01 >	●	68B40740			
125	CBR R	03 > 09	●	68B407E9		68B40740	
125	CBR R	11 > 13	●	68B407M7		68B40766	
125	CBR R REPSOL	03 > 09	●	68B407E9		68B40740	
125	CBR R REPSOL	11 > 13	●	68B407M7		68B40766	
125	CR E	88 > 91	●	68B40769			
125	CR E	92 > 94	●	68B40769			
125	CR E	95 > 97	●	68B40796			
125	CR E	98 > 01	●	68B40796			
125	CR E	02 > 08	●	68B40796		68B40786	
125	CR F SUPERMOTARD	00 > 05	●			68B40786	
125	CR R	88 > 91	●	68B40769			
125	CR R	92 > 94	●	68B40769			
125	CR R	95 > 97	●	68B40796			
125	CR R	98 > 01	●	68B40796			
125	CR R	02 > 08	●	68B40796		68B40786	
125	CRM	98 >	●	68B40769			
125	DYLAN	00 > 07	●	68B40740			
125	FORZA ABS	15 >	●	68B407A6		68B40749	
125	PANTHEON	98 > 02	●	68B40775			
125	PANTHEON FES	03 > 07	●	68B40775		68B40749	



				Fix	Floating	Fix	Floating
<b>HONDA</b>							
125	PCX	10 >	●	68B40759			
125	PS	06 > 08	●	68B40740			
125	RS R	91 > 05	●		78B408A3		
125	S-WING/ABS	07 > 11	●	68B40775		68B40749	
125	SH ED	09 >	●●	68B40775		68B40780	
125	SH GT ABS	12 >	●	68B40775		68B40780	
125	SH MODE	14 >	●	68B40740			
125	SPACY	96 > 01	●	68B40716			
125	VARADERO	01 > 02	●			68B40740	
125	XLR R	98 > 00	●	68B40769			
150	@ NES	01 > 06	●	68B40740			
150	CRF F	03 > 06	●	68B40769			
150	DYLAN	00 > 07	●	68B40740			
150	PANTHEON	98 > 02	●	68B40775			
150	PANTHEON FES	03 > 07	●	68B40775		68B40749	
150	PCX	13 >	●	68B40759			
150	PS I	06 > 08	●	68B40740			
150	S-WING	07 >	●	68B40775		68B40749	
150	SH	98 > 08	●	68B40740			
150	SH ED	09 >	●●	68B40775		68B40780	
150	SH GT ABS	12 >	●	68B40775		68B40780	
230	CRF ENDURO	04 > 06	●	68B40796			
230	CRF TRIAL	04 > 06	●	68B40769			
230	SL	98 >	●	68B40769			
250	CB	91 > 06	●			68B40780	
250	CBF	04 > 08	●	68B407H7			
250	CBR R	11 > 13	●		78B40838	68B407M0	
250	CBR R ABS	11 > 13	●		78B40838	68B407M0	
250	CBR R ABS TRICOLORE	14 >	●		78B40838	68B407M0	
250	CN	88 >	●	68B40720			
250	CR E	88 > 91	●	68B40769			
250	CR E	92 > 94	●	68B40769			
250	CR E	95 > 96	●	68B40796			
250	CR E	02 > 08	●	68B40796		68B40786	
250	CR R	88 > 91	●	68B40769			
250	CR R	92 > 94	●	68B40769			
250	CR R	95 > 96	●	68B40796			
250	CR R	02 > 08	●	68B40796		68B40786	
250	CRE F	00 > 05	●			68B40786	
250	CRF	15 >	●	68B407N3		68B40786	
250	CRF L	13 >	●			68B40740	
250	CRF R	97 >	●		78B408A3		
250	CRF R	04 > 14	●	68B40796		68B40786	
250	CRF R	15 >	●	68B407N3		68B40786	
250	CRF X	04 > 07	●	68B40796		68B40786	
250	CRF X	08 > 12	●			68B40786	
250	CRM R	98 >	●	68B40769			
250	FORESIGHT	97 > 99	●	68B40775			
250	FORESIGHT	00 > 07	●	68B40775		68B40749	
250	FORZA	00 > 04	●	68B40775		68B40749	
250	FORZA X / XE	05 > 07	●	68B40775		68B40780	
250	FORZA X / XE	08 >	●	68B407A6		68B40780	
250	HORNET	97 >	●		78B408A3	68B40749	
250	JAZZ	00 > 04	●	68B40775		68B40749	
250	NX	88 >	●	68B40769			
250	RS R	90 > 97	●		78B408A3		
250	VTR	98 >	●			68B40749	
250	XELVIS	97 > 98	●			68B40749	
250	XLR BAJA	88 > 91	●	68B40769		68B40748	
250	XLR BAJA	96 >	●			68B40740	
250	XR R	91 > 04	●	68B40769		68B40740	
300	CBR	15 >	●		78B40838	68B407M0	
300	CBR ABS	15 >	●		78B40838	68B407M0	
300	CBR ABS HRC TRICOLORE	14 >	●		78B40838	68B407M0	
300	CBR R	14 >	●		78B40838	68B407M0	
300	CBR R ABS	15 >	●		78B40838	68B407M0	
300	FORZA ABS	14 >	●	68B407A6		68B40797	
300	FORZA NSS	12 >	●	68B407A6		68B40780	
300	SH 30 ANNI	15 >	●	68B407A6		68B407A6	
300	SH ABS	06 > 15	●	68B407A6		68B407A6	
300	SH I	06 > 15	●	68B407A6		68B407A6	
350	CB S G	87 >	●	68B407A5			





				Fix	Floating	Fix	Floating
<b>HONDA</b>							
400	CB	89 > 91	●			68B40749	
400	CB FOUR	97 >	●		78B40827		
400	CB N	82 > 88	●		78B408A3	68B40749	
400	CB V-TECH	11 >	●		78B408A3		
400	CBR F	85 > 87	●		78B408A3		
400	CBR RR	89 > 90	●		78B408A3	68B40743	
400	CBR RR	94 > 96	●●		78B408A3		
400	NSR	85 > 88	●	68B407A6		68B40743	
400	SILVER WING	06 > 08	●●	68B407A6		68B40780	
400	SW - T 400	09 >	●	68B407E7		68B40797	
400	VFR R	86 > 88	●	68B407E9		68B40743	
400	VFR R	89 > 91	●		78B408A3		
400	XR R	95 > 05	●	68B40769		68B40740	
400	XR R	06 > 07	●			68B40740	
400	XR SUPERMOTARD	00 > 07	●			68B40740	
440	XR R	06 > 07	●			68B40740	
440	XR SUPERMOTARD	06 > 07	●			68B40740	
450	CB S	85 > 89	●●	68B407A5			
450	CR F SUPERMOTARD	02 > 03	●			68B40786	
450	CR F SUPERMOTARD	04 >	●			68B40786	
450	CRF	15 >	●	68B407N3		68B40786	
450	CRF R	02 > 14	●	68B40796		68B40786	
450	CRF X	04 > 12	●	68B40796		68B40786	
500	CB	95 > 03	●			68B40780	
500	CB F	04 > 08	●			68B40783	
500	CB F	13 >	●			68B407L9	
500	CB S	98 > 02	●			68B40780	
500	CB X	13 >	●			68B407L9	
500	CBR R	13 >	●			68B407L9	
500	CR	88 > 91	●	68B40769			
500	CR	92 > 94	●	68B40769			
500	CR E	95 > 01	●	68B40796			
500	CR R	95 > 01	●	68B40796			
500	VF F-F2	83 > 87	●	68B407A6			
500	XR	91 > 93	●			68B40740	
600	CBF	04 > 07	●			68B40783	
600	CBF N	03 > 07	●			68B40783	
600	CBF S ABS	03 > 07	●			68B40783	
600	CBR F	87 > 90	●	68B407E9		68B40743	
600	CBR F	91 > 94	●	68B407E9		68B40749	
600	CBR F	95 > 98	●		78B408A3	68B40749	
600	CBR F	99 > 00	●		78B40825	68B40749	
600	CBR F	01 > 07	●		78B40823	68B40749	
600	CBR F	11 >	●●		78B40824	68B40783	
600	CBR F ABS	11 >	●●		78B40824	68B40783	
600	CBR F SPORT	01 > 02	●●		78B40823	68B40749	
600	CBR F3	03 >	●●		78B40825	68B40749	
600	CBR F4	01 > 06	●		78B40823	68B40749	
600	CBR RR	03 >	●●		78B40867	68B40749	
600	CBR RR ABS	09 > 12	●●		78B40867	68B40749	
600	HORNET	98 > 99	●		78B40827	68B40749	
600	HORNET	07 > 13	●●		78B40824	68B40783	
600	HORNET / S	00 > 06	●●		78B40826	68B40749	
600	HORNET ABS	07 > 08	●●		78B40824	68B40783	
600	SILVER WING	00 > 10	●	68B407A6		68B40780	
600	SILVER WING ABS	03 >	●	68B407E9		68B40780	
600	SW-T	11 > 12	●	68B407E7		68B40797	
600	XL R	83 > 87	●	68B40769			
600	XL V TRANSALP	87 > 90	●	68B407E9			
600	XL V TRANSALP	91 > 93	●	68B407E9		68B40780	
600	XL V TRANSALP	97 > 99	●	68B407A5		68B40780	
600	XL V TRANSALP VR/VT	94 > 96	●	68B407E9		68B40780	
600	XR R	88 > 99	●	68B40769		68B40740	
600	XR R DAKAR	99 >	●	68B40769		68B40740	
650	CB F	14 >	●	68B407K3		68B407L9	
650	CBR F	14 >	●	68B407K3		68B407L9	
650	FMX	05 > 06	●			68B40748	
650	NX DOMINATOR	88 > 92	●	68B407A5		68B40749	
650	NX DOMINATOR	93 > 04	●	68B407A5		68B40748	
650	SLR	97 > 99	●	68B407E9		68B40748	
650	VIGOR FX	99 > 01	●	68B407E9		68B40748	
650	XL V TRANSALP	00 > 07	●●	68B407A5		68B40780	





				Fix	Floating	Fix	Floating
<b>HONDA</b>							
650	XR L	93 > 12	●	68B407A5		68B40749	
650	XR R	97 > 99	●			68B40749	
650	XR R	00 > 08	●	68B40769			
650	XRV AFRICA TWIN	88 > 89	●			68B40780	
700	CTX	14 >	●	68B407G7		68B407G8	
700	CTX DCTI ABS	14 >	●	68B407G7		68B407G8	
700	CTX N	14 >	●	68B407G7		68B407G8	
700	CTX N DCTI ABS	14 >	●	68B407G7		68B407G8	
700	INTEGRA	12 >	●	68B407G7		68B407G8	
700	NC ABS	12 >	●	68B407G7		68B407G8	
700	NC ABS DCT	12 >	●	68B407G7		68B407G8	
700	NC S	12 >	●	68B407G7		68B407G8	
700	NC X ABS	12 >	●	68B407G7		68B407G8	
700	NC X ABS DCT	12 >	●	68B407G7		68B407G8	
700	XL 700 V TRANSALP	08 > 12	●●	68B407A5		68B40780	
700	XL 700 V TRANSALP ABS	08 > 12	●●	68B407A5		68B40780	
750	CB SEVEN-FIFTY	92 > 95	●●			68B40780	
750	CBX F	84 > 88	●●	68B407E9			
750	INTEGRA DCT ABS	14 >	●			68B407G8	
750	NC S	14 >	●	68B407G7		68B407G8	
750	NC X	14 >	●	68B407G7		68B407G8	
750	VFR F	85 > 87	●	68B407E9		68B407A6	
750	VFR F	88 > 89	●			68B407A6	
750	VFR F	94 > 97	●		78B408A3	68B407M6	
750	XLV R	83 > 87	●●	68B407E9			
750	XRV AFRICA TWIN	90 > 02	●●	68B407C7		68B407A5	
800	CROSSRUNNER	11 >	●		78B40825	68B407M6	
800	VFR INTERCEPTOR	98 > 10	●●		78B40825	68B407M6	
900	CBR RR	92 > 93	●●		78B40825	68B40749	
900	CBR RR	94 > 97	●●		78B408A3		
900	CBR RR	98 > 99	●●		78B40898	68B40749	
900	CBR RR	00 > 03	●●		78B40895	68B40749	
900	HORNET	02 > 06	●		78B40823	68B40780	
929	CBR RR	99 > 01	●			68B40749	
954	CBR RR	02 > 03	●			68B40749	
1000	CB R	08 >	●●		78B40867		
1000	CB R ABS	09 >	●●		78B40867		
1000	CBF	06 > 13	●●			68B40783	
1000	CBF ABS	06 > 13	●●			68B40783	
1000	CBF F ABS	15 >	●●			68B40783	
1000	CBF F ST	06 > 09	●●			68B40783	
1000	CBF F ST	10 > 13	●●			68B40783	
1000	CBF F ST ABS	06 > 12	●●			68B40783	
1000	CBR F	93 > 97	●			68B407A6	
1000	CBR RR	04 > 05	●●		78B40867	68B40749	
1000	CBR RR	06 > 07	●●		78B40877	68B40749	
1000	CBR RR	08 >	●●		78B40876	68B40749	
1000	CBR RR ABS	09 >	●●		78B40876	68B40749	
1000	CBR RR FIREBLADE	14 >	●●		78B40876	68B40749	
1000	CBR RR SP	14 >	●●		78B40876	68B40749	
1000	VF F	84 > 88	●●	68B407E9			
1000	VF R	86 > 87	●●	68B407E9			
1000	VTR F	97 > 07	●●		78B408A3	68B40749	
1000	VTR SP02	02 > 04	●●		78B40877	68B40749	
1000	VTR SP1	00 > 01	●●		78B40877	68B40749	
1000	XL VARADERO	99 > 02	●●		78B40825	68B407A5	
1000	XL-L VARADERO / ABS	03 > 11	●●		78B40825	68B407A6	
1100	CB X 11	00 > 03	●			68B407A6	
1100	CBR XX	97 > 04	●			68B407A6	
1200	CROSSTOURER	12 > 14	●	68B407N0		68B407N1	
1200	CROSSTOURER DCT TRAVEL EDITION	12 > 14	●	68B407N0		68B407N1	
1200	CROSSTOURER L	14 >	●	68B407N0		68B407N1	
1200	CROSSTOURER S	14 >	●●	68B407N0		68B407N1	
1200	VFR	10 > 13	●			68B407N1	
1200	VFR DCT	10 > 13	●			68B407N1	
1300	CB	03 > 08	●●		78B40867	68B407A6	
1500	GL C VALKIRIA	97 > 03	●●		78B40825		
1800	GL GOLDWING	01 >	●●		78B40825		
<b>HRD</b>							
125	GS	94 > 96	●			68B40756	
125	GS	97 >	●			68B40756	
125	MC	94 > 96	●			68B40756	





				Fix	Floating	Fix	Floating
<b>HRD</b>							
250	GS	94 > 96	●			68B40756	
250	MC	94 > 96	●			68B40756	
<b>HUSABERG</b>							
390	FE	10 > 12	●	68B407B8		68B40752	
400	FE	00 > 03	●	68B407B8		68B40752	
400	FE E	01 > 03	●	68B407B8		68B40752	
400	FS C	01 > 03	●	68B407B8		68B40752	
400	FS E	01 > 03	●	68B407B8		68B40752	
450	FE	10 > 12	●	68B407B8		68B40752	
450	FS E	03 > 08	●			68B40752	
450	FX E	10 >	●	68B407B8		68B40752	
470	FC E	01 > 02	●	68B407B8			
501	CR	99 > 03	●	68B407B8			
501	FC	99 > 03	●	68B407B8		68B40752	
501	FE E	99 > 04	●	68B407B8		68B40752	
501	FE S	99 > 04	●	68B407B8		68B40752	
550	FC E	01 > 05	●	68B407B8		68B40752	
550	FE E	04 > 08	●	68B407B8		68B40752	
570	FE	10 > 12	●	68B407B8		68B40752	
570	FS	10 >	●			68B40752	
600	FC	99 > 03	●	68B407B8		68B40752	
600	FE E	99 > 02	●	68B407B8		68B40752	
600	FE SUPERMOTARD	99 > 03	●			68B40752	
650	FE E	01 > 08	●	68B407B8		68B40752	
650	FS C	01 > 08	●			68B40752	
650	FS E	01 > 08	●			68B40752	
650	FX E	01 > 05	●	68B407B8		68B40752	
<b>HUSQVARNA</b>							
125	CR	00 > 04	●		78B40814	68B40754	
125	CR	05 > 12	●		78B40814	68B40789	
125	SM	00 >	●		78B40814	68B40754	
125	SM S	03 > 12	●		78B40814	68B40754	
125	SM S4	10 > 11	●		78B40814	68B40754	
125	TC	14 >	●	68B407B8		68B40752	
125	TE	10 > 12	●		78B40814	68B40754	
125	TE	14 >	●	68B407B8		68B40752	
125	WR	00 > 05	●		78B40814	68B40754	
125	WR	06 > 12	●		78B40814	68B40789	
125	WR E	00 > 09	●		78B40814	68B40754	
250	CR	00 > 04	●		78B40814	68B40754	
250	CR	05 > 11	●		78B40814	68B40789	
250	FC	14 >	●	68B407B8		68B40752	
250	FE	14 >	●	68B407B8		68B40752	
250	TC	01 > 12	●		78B40814	68B40789	
250	TC	14 >	●	68B407B8		68B40752	
250	TE	04 > 06	●		78B40814	68B40754	
250	TE	14 >	●	68B407B8		68B40752	
250	TXC	11 >	●		78B40814	68B40789	
250	WR	00 > 06	●		78B40814	68B40754	
250	WR	07 >	●		78B40814	68B40789	
300	TC	14 >	●	68B407B8			
300	TE	14 >	●	68B407B8		68B40752	
300	WR	09 >	●		78B40814	68B40754	
310	TE	10 > 12	●		78B40814	68B40789	
310	TE 4T	10 > 12	●		78B40814	68B40789	
310	TXC	11 >	●		78B40814	68B40789	
350	FC	14 >	●	68B407B8		68B40752	
350	FE	14 >	●	68B407B8		68B40752	
360	WR	00 > 04	●		78B40814	68B40754	
410	TE	00 > 01	●		78B40814	68B40754	
449	SMR	11 > 12	●			68B40789	
449	TC 449	11 > 13	●		78B40814	68B40789	
449	TE 449	11 > 13	●		78B40814	68B40789	
450	FC	14 >	●	68B407B8		68B40752	
450	FE	14 >	●	68B407B8		68B40752	
450	SM RR	06 > 08	●			68B40789	
450	SMR	03 > 09	●			68B40754	
450	TC	02 > 03	●		78B40814	68B40754	
450	TC	04 > 10	●		78B40814	68B40789	
450	TE	00 > 06	●		78B40814	68B40754	
450	TE	07 > 10	●		78B40814	68B40789	
450	TXC	11 > 13	●		78B40814	68B40789	



				Fix	Floating	Fix	Floating
<b>HUSQVARNA</b>							
480	TXC	11 > 13	●		78B40814	68B40789	
501	FE	14 >	●	68B407B8		68B40752	
510	SMR	05 > 05	●			68B40754	
510	SMR	06 > 10	●			68B40789	
510	TC	02 > 04	●		78B40814	68B40754	
510	TC	05 > 09	●		78B40814	68B40789	
510	TE	02 > 04	●		78B40814	68B40754	
510	TE	05 > 10	●		78B40814	68B40789	
510	TE CENTENNIAL	04 >	●		78B40814	68B40754	
510	TXC	11 > 12	●		78B40814	68B40789	
511	SMR	11 > 12	●			68B40789	
511	TE	11 > 13	●		78B40814	68B40789	
511	TXC	11 > 13	●			68B40789	
570	SMR	00 >	●			68B40754	
570	SMR	01 > 04	●			68B40754	
570	TC	00 > 03	●		78B40814	68B40754	
570	TE	01 > 04	●		78B40814	68B40754	
610	TC	00 > 04	●		78B40814	68B40754	
610	TE	00 > 04	●		78B40814	68B40754	
610	TE E	05 > 07	●		78B40814	68B40754	
630	SMR	03 > 05	●			68B40754	
630	TE	10 > 12	●		78B40814	68B40754	
650	TR STRADA	13 >	●	68B407G5		68B40781	
650	TR TERRA	13 >	●	68B407G5		68B40781	
900	NUDA ABS	11 >	●	68B407H7		68B407C0	
900	NUDA R	11 >	●●	68B407H7		68B407C0	
<b>HYOSUNG</b>							
50	SUPER CAB	95 >	●	68B40714			
50	SUPER CAB PLUS	98 >	●	68B40714			
<b>ITALJET</b>							
50	BAZOOKA	92 > 97	●	68B40710			
50	CRUISE	94 >	●	68B40711			
50	PISTA	93 >	●	68B40710			
50	SCOOP	93 >	●	68B40710			
50	YANKEE	93 >	●	68B40710			
125	DRAGSTER	99 > 01	●●			68B40776	
180	DRAGSTER	99 > 01	●●			68B40776	
250	JUPITER	00 >	●	68B407C9		68B40762	
<b>KAWASAKI</b>							
125	KX	88 > 02	●			68B40746	
125	KX	03 > 05	●		78B40810	68B40782	
125	KX	06 > 08	●		78B40811	68B40782	
200	KDX	04 > 06	●			68B40746	
220	KDX	03 > 05	●			68B40746	
250	KLX	14 >	●		78B40811		
250	KX	87 > 02	●			68B40746	
250	KX	03 > 05	●		78B40810	68B40782	
250	KX	06 > 08	●		78B40811	68B40782	
250	KX F	04 > 05	●		78B40810	68B40782	
250	KX F	06 > 13	●		78B40811	68B40782	
250	KX F	14 >	●		78B40844	68B40782	
250	KXE F	06 > 07	●		78B40811	68B40782	
250	Z SL	15 >	●	68B407L2		68B407N1	
250	ZZR	92 >	●		78B40841		
300	J	14 >	●		78B40819	68B407K4	
300	KLX	96 > 07	●			68B40746	
300	NINJA ABS	13 >	●	68B407L2			
300	Z ABS	15 >	●	68B407L2		68B407N1	
400	ZXR	89 > 90	●		78B40841		
400	ZXR	91 > 02	●			68B40779	
450	KLX F	07 > 09	●		78B40811	68B40782	
450	KLX R	06 >	●		78B40811	68B40782	
450	KX F	06 > 14	●		78B40811	68B40782	
450	KX F	15 >	●		78B40844	68B40782	
450	KXE F	06 > 07	●		78B40811		
500	KX	90 > 04	●			68B40746	
550	ZR ZEPHYR	93 > 01	●		78B40841	68B40779	
600	ZL ELIMINATOR	95 > 99	●		78B40841		
600	ZX-6R	95 > 97	●●		78B40841		
600	ZX-6R	98 > 02	●●		78B40841	68B40747	
600	ZX-6R	07 > 12	●●		78B40840	68B40747	





				Fix	Floating	Fix	Floating
<b>KAWASAKI</b>							
600	ZX-6R	13 >	••		78B40840	68B40747	
600	ZX-6RR	03 > 04	••		78B40815	68B40747	
600	ZX-6RR	05 > 06	••		78B40840	68B40747	
600	ZZR	90 > 92	••		78B40841		
600	ZZR	93 > 06	••		78B40841	68B40779	
636	ZX 6 RR	03 > 06	•			68B40747	
636	ZX-6R	02 > 02	••		78B40841	68B40747	
636	ZX-6R	03 > 04	••		78B40815	68B40747	
636	ZX-6R	05 > 06	••		78B40840	68B40747	
636	ZX-6R ABS	13 >	••		78B40861	68B40747	
650	ER-6F	06 >	•		78B40840	68B40747	
650	ER-6N	06 >	••		78B40840	68B40747	
650	KLX R	93 > 03	•			68B40746	
650	VERSYS	07 > 14	•		78B40840	68B40747	
650	VERSYS ABS	07 > 14	•			68B40747	
750	GPX R	86 > 90	•			68B40779	
750	Z 750	04 > 06	•		78B40841	68B40747	
750	Z 750 ABS	07 >	••		78B40840	68B407A3	
750	Z 750 R	11 > 12	•		78B40840	68B407A3	
750	Z 750 R ABS	11 > 12	•		78B40840	68B407A3	
750	Z 750 S	05 > 06	•		78B40841	68B40747	
750	ZEPHYR	91 > 03	••		78B40841		
750	ZR 7	99 > 03	•		78B40841	68B40779	
750	ZR 7S	99 > 03	••		78B40841	68B40779	
750	ZX 7 R	96 > 02	••		78B408A1	68B40761	
750	ZX 7 R	99 > 03	••			68B40761	
750	ZX-7 RR	93 > 04	•		78B408A1	68B40761	
750	ZXR	89 > 90	••		78B40899		
750	ZXR	91 > 95	••		78B408A1		
750	ZXR R	89 > 95	•			68B40761	
800	Z 800	13 >	•		78B40861	68B407J3	
800	Z 800 ABS	13 >	••		78B40861	68B407J3	
800	Z 800 E	13 >	••		78B40861	68B407J3	
900	GPZ R	90 > 03	••		78B40841		
900	ZX 9R	94 > 97	•		78B408A1	68B40761	
900	ZX 9R	98 > 99	•			68B40747	
900	ZX 9R	00 > 01	•		78B40899	68B40747	
900	ZX 9R	02 > 04	••		78B408A1	68B40747	
1000	GTR	86 > 93	•			68B40761	
1000	GTR	94 > 06	••		78B40841		
1000	KLV	04 > 07	•		78B40865	68B407E3	
1000	VERSYS	12 > 14	•		78B40840	68B407A3	
1000	Z	03 > 06	•		78B40841	68B40747	
1000	Z	07 >	•		78B40840	68B407A3	
1000	Z SX	11 >	•		78B40840	68B407A3	
1000	Z SX ABS	11 >	•		78B40840	68B407A3	
1000	Z1000 ABS	07 >	•		78B40840	68B407A3	
1000	ZX 10 R	04 > 10	••		78B40840	68B40747	
1000	ZX 10 R (ABS)	11 >	••		78B40861	68B40747	
1100	GPZ	95 > 98	••		78B40841		
1100	ZEPHYR	92 > 98	••		78B40899	68B40761	
1100	ZRX	97 > 00	••		78B40899		
1100	ZZE	93 > 01	••		78B408A1		
1100	ZZR	90 > 92	••		78B40899		
1200	ZX1200	01 > 08	••		78B40899		
1200	ZX12R NINJA	00 > 04	••		78B408A1		
1200	ZX12R NINJA	05 > 06	••		78B40841		
1200	ZZR	02 > 04	••		78B408A1		
1400	GTR	07 > 11	••		78B40861		
1400	ZZR	06 >	•		78B40861	68B407A3	
1400	ZZR ABS	06 >	•		78B40861	68B407A3	
1500	VN	02 > 04	••		78B408A1		
1600	M1600	04 > 05	••		78B408A1		
1600	VN	04 > 08	••		78B408A1		
<b>KEEWAY</b>							
125	OUTLOOK	08 >	•	68B40740		68B40740	
151	OUTLOOK	08 >	•	68B40740		68B40740	
<b>KL</b>							
50	BOMBER	94 >	•	68B40710			
50	HELIOS	98 >	•	68B40717			
50	INVADER	98 >	•	68B40710			





				Fix	Floating	Fix	Floating
--	--	--	--	-----	----------	-----	----------

**KL**

50	KRX	98 >	●	68B40710			
50	KRYPTON	99 >	●	68B40717			
50	RACER	94 >	●	68B40710			
50	XR7	98 >	●	68B40717			
125	NOX	00 > 01	●	68B40717			
125	PROXY	01 >	●	68B40717			
125	PULSAR	00 >	●	68B40717			
150	NOX	00 >	●	68B40717			
150	PROXY	01 >	●	68B40717			
150	PULSAR	00 >	●	68B40717			

**KTM**

125	EXC	98 >	●	68B407B8		68B40752	
125	EXC SIX DAYS	09 >	●	68B407B8		68B40752	
125	GS	88 > 92	●			68B40752	
125	GS	93 > 97	●	68B407B8		68B40752	
125	MX	89 > 92	●	68B407B8		68B40752	
125	STING	98 >	●			68B40752	
125	SX	93 >	●	68B407B8		68B40752	
125	SXS	00 > 10	●	68B407B8		68B40752	
144	SX	07 > 10	●	68B407B8		68B40752	
150	SX	08 >	●	68B407B8		68B40752	
200	EXC	98 >	●	68B407B8		68B40752	
200	EXC SIX DAYS	15 >	●	68B407B8		68B40752	
200	MXC	98 > 03	●	68B407B8		68B40752	
200	SX	03 > 09	●	68B407B8		68B40752	
200	XC W	06 > 09	●	68B407B8		68B40752	
250	EXC	98 >	●	68B407B8		68B40752	
250	EXC F	03 > 03	●	68B407B8			
250	EXC F	04 >	●	68B407B8		68B40752	
250	EXC F SIX DAYS	09 >	●	68B407B8		68B40752	
250	EXC G	04 > 09	●	68B407B8		68B40752	
250	EXC SIX DAYS	09 >	●	68B407B8		68B40752	
250	GS	88 > 92	●			68B40752	
250	GS	93 > 97	●	68B407B8		68B40752	
250	MX	89 > 91	●			68B40752	
250	MX	92 >	●	68B407B8		68B40752	
250	MXC	98 > 03	●	68B407B8		68B40752	
250	SX	93 > 97	●	68B407B8		68B40752	
250	SX	98 >	●	68B407B8		68B40752	
250	SX-F	03 >	●	68B407B8		68B40752	
250	SXS	03 > 10	●	68B407B8		68B40752	
250	SXS-F	06 > 09	●	68B407B8		68B40752	
250	XC-F	07 > 12	●	68B407B8		68B40752	
250	XC-W	06 > 12	●	68B407B8		68B40752	
300	EXC	97 >	●	68B407B8		68B40752	
300	EXC SIX DAYS	09 >	●	68B407B8		68B40752	
300	GS	91 > 96	●	68B407B8		68B40752	
300	MX	91 > 92	●	68B407B8		68B40752	
300	MXC	98 > 05	●	68B407B8		68B40752	
300	SX	93 > 96	●	68B407B8			
300	SX	97 > 03	●	68B407B8		68B40752	
300	XC	06 > 12	●	68B407B8		68B40752	
300	XC-W	06 > 12	●	68B407B8		68B40752	
350	EXC F	10 >	●	68B407B8		68B40752	
350	EXC F SIX DAYS	11 >	●	68B407B8		68B40752	
350	GS	93 >	●	68B407B8		68B40752	
350	SXF	11 >	●	68B407B8		68B40752	
380	EXC	98 > 02	●	68B407B8		68B40752	
380	MXC	98 > 01	●	68B407B8		68B40752	
380	SX	98 > 02	●	68B407B8		68B40752	
400	EGS	96 > 99	●			68B40752	
400	EXC	94 > 11	●	68B407B8		68B40752	
400	SX	00 > 02	●	68B407B8		68B40752	
400	XC-W	07 > 09	●	68B407B8		68B40752	
450	EXC	03 >	●	68B407B8		68B40752	
450	EXC R	08 > 09	●	68B407B8		68B40752	
450	EXC SIX DAYS	09 >	●	68B407B8		68B40752	
450	MXC	03 > 06	●	68B407B8		68B40752	
450	SMR	04 > 08	●			68B40752	
450	SXF	03 >	●	68B407B8		68B40752	
450	SXS	03 > 10	●	68B407B8		68B40752	
450	SXS-F	03 > 10	●	68B407B8		68B40752	



				Fix	Floating	Fix	Floating
<b>KTM</b>							
450	XC	06 > 09	●	68B407B8		68B40752	
450	XC-F	07 > 09	●	68B407B8		68B40752	
450	XC-W	07 > 09	●	68B407B8		68B40752	
500	EXC	10 >	●	68B407B8		68B40752	
500	EXC SIX DAYS	11 >	●	68B407B8		68B40752	
500	MX	89 > 93	●	68B407B8		68B40752	
500	SX	93 > 95	●	68B407B8		68B40752	
505	SX-F	07 > 09	●	68B407B8		68B40752	
505	XC-F	07 > 09	●	68B407B8		68B40752	
520	EXC	00 > 02	●	68B407B8		68B40752	
520	MXC	01 > 02	●	68B407B8		68B40752	
520	SX RACING	00 > 02	●	68B407B8		68B40752	
525	EXC	03 > 08	●	68B407B8		68B40752	
525	MXC	03 > 05	●	68B407B8		68B40752	
525	SMR	04 > 05	●			68B40752	
525	SX	03 > 06	●	68B407B8		68B40752	
525	SX RACING	05 > 06	●	68B407B8		68B40752	
525	XC	06 > 08	●	68B407B8		68B40752	
525	XCG	06 > 08	●	68B407B8		68B40752	
525	XCW	06 > 08	●	68B407B8		68B40752	
530	EXC	10 > 11	●	68B407B8		68B40752	
530	EXC R	08 > 09	●	68B407B8		68B40752	
530	EXC SIX DAYS	09 >	●	68B407B8		68B40752	
540	SXC	98 > 00	●	68B407B8		68B40752	
540	SXS	01 > 06	●	68B407B8		68B40752	
560	SMR	06 > 08	●			68B40752	
600	GS 4T	93 >	●	68B407B8		68B40752	
600	LC4	90 > 93	●	68B407B8		68B40752	
600	MX	90 > 92	●	68B407B8		68B40752	
620	ADVENTURE	97 > 98	●			68B40752	
620	DUKE 4T	95 > 97	●			68B40752	
620	DUKE 4T	98 >	●			68B40752	
620	EGS-LC4	96 > 02	●			68B40752	
620	LC4 SC SUPERCOMPETITION	98 > 04	●	68B407B8		68B40752	
620	LC4 SXC SUPERMOTO	99 > 01	●	68B407B8		68B40752	
625	LC4 SC SUPERCOMPETITION	02 >	●	68B407B8		68B40752	
625	LC4 SC SUPERCOMPETITION	03 > 04	●			68B40752	
625	SMC	05 > 08	●			68B40752	
625	SXC	03 > 08	●	68B407B8		68B40752	
640	DUKE II	99 > 02	●			68B40752	
640	DUKE II	03 > 06	●		78B40870	68B40752	
640	LC4 ADVENTURE	98 > 07	●			68B40752	
640	LC4 ENDURO	98 > 07	●			68B40752	
640	LC4 SUPERMOTO	98 > 04	●			68B40752	
640	LC4 SUPERMOTO	05 > 05	●		78B40870	68B40752	
640	LC4 SUPERMOTO	06 >	●			68B40752	
660	SMC	03 > 07	●			68B40752	
690	DUKE	08 > 13	●		78B40870	68B407F1	
690	DUKE	14 >	●●		78B408B0	68B407F1	
690	DUKE ABS	12 > 12	●		78B40870	68B407F1	
690	DUKE R	14 >	●		78B40870	68B407F1	
690	ENDURO R	14 >	●●		78B408A5		78B408A9
690	SM	07 >	●		78B40870	68B407F1	
690	SM PRESTIGE	08 > 09	●		78B40870	68B407F1	
690	SM R	08 >	●		78B40870	68B407F1	
690	SMC R	14 >	●		78B408A8		78B408A9
690	SMR R	14 >	●		78B408A8		78B408A9
690	SUPERMOTO	07 > 08	●			68B407F0	
950	LC8 ADVENTURE	02 > 06	●			68B407F0	
950	LC8 ADVENTURE S	02 > 06	●			68B407F0	
950	SUPERENDURO R	06 > 08	●			68B407F0	
950	SUPERMOTO	05 > 07	●			68B407F1	
950	SUPERMOTO R	06 > 08	●●		78B408A7	68B407F1	
990	LC8 ADVENTURE R	10 > 12	●		78B408A5		78B408A6
990	LC8 ADVENTURE S	06 > 08	●●		78B408A5	68B407F0	
990	LC8 ADVENTURE S / ABS	06 > 08	●●		78B408A5	68B407F0	
990	SUPER DUKE	05 > 11	●		78B40870	68B407F1	
990	SUPERDUKE R	07 > 11	●●		78B40870	68B407F1	
990	SUPERMOTO	07 > 12	●			68B407F1	
990	SUPERMOTO R	10 > 12	●		78B408A7	68B407F1	
1050	ADVENTURE	15 >	●●		78B40878		
1190	ADVENTURE	13 >	●●		78B40887		78B40833



				Fix	Floating	Fix	Floating
<b>KTM</b>							
1190	ADVENTURE R	13 >	••		78B40887		78B40833
1190	RC8	08 > 09	••		78B40870 **		
1290	SUPER ADVENTURE	15 >	•		78B40878		
1290	SUPER DUKE R	14 >	•		78B408B1	68B407K5	
<b>KYMCO</b>							
50	AGILITY R 10"	06 >	•	68B40714			
50	AGILITY R12	06 > 11	•	68B40714			
50	AGILITY R16	08 >	•	68B407B2			
50	AGILITY RS	09 >	•	68B40718			
50	B & W	01 > 02	•	68B40730			
50	B & W	03 > 06	•	68B40731			
50	DINK	98 > 02	•	68B40714			
50	DINK	08 >	•	68B40771			
50	DINK CLASSIC	03 > 07	•	68B40731			
50	DINK SPORTS	02 > 06	•	68B40731			
50	FEVER ZX	99 >	•	68B40714			
50	FILLY	02 >	•	68B40711			
50	HEROISM	95 >	•	68B40711			
50	K12	95 > 98	•	68B40711			
50	KB	95 > 98	•	68B40711			
50	LIKE 2T	09 >	•	68B407F9			
50	LIKE 4T	09 >	•	68B407F9			
50	MAXXER	02 > 03	•	68B40714		68B40714	
50	NEW DINK	08 >	•	68B40771			
50	PEOPLE	99 > 11	•	68B40757			
50	PEOPLE S	05 >	•	68B407B2			
50	SNIPER-DD	94 > 98	•	68B40711			
50	SUPER 9	02 >	•			68B40714	
50	SUPER 9 L.C.	02 >	•			68B40714	
50	TOP BOY	99 > 06	•	68B40714			
50	VITALITY	08 >	•	68B40714			
50	YUP	00 >	•	68B40714			
50	YUP SP	00 >	•	68B40714			
90	YUP SP	95 >	•	68B40714			
125	AGILITY 16 PLUS	14 >	•	68B407B2		68B40795	
125	AGILITY R 12"	06 > 10	•	68B40714			
125	AGILITY R16	08 > 14	•	68B407B2		68B40795	
125	AGILITY RS	09 >	•	68B40718			
125	B & W	00 >	•	68B40731		68B40714	
125	DINK	98 > 04	•	68B40714		68B40714	
125	DINK CLASSIC	02 >	•	68B40731		68B40714	
125	DINK LX	99 > 01	•	68B40714		68B40714	
125	DOWNTOWN	09 > 14	•		78B40819	68B40795	
125	DOWNTOWN I	15 >	•		78B40819	68B40771	
125	GRAND DINK	02 > 07	•	68B40731		68B40724	
125	HEROISM	96 > 98	•	68B40711			
125	K-XCTI	13 >	•		78B40819	68B40771	
125	LIKE	09 >	•	68B407F9		68B407D8	
125	MAXXER	02 > 03	•			68B40714	
125	MOVIE XL	99 > 09	•	68B40731			
125	PEOPLE	99 > 11	•	68B40757			
125	PEOPLE GTI	10 >	•	68B40794		68B40794	
125	PEOPLE ONE 125DD	14 >	•	68B407K6		68B407D8	
125	PEOPLE S	05 > 06	•	68B407B2			
125	PEOPLE S	07 >	•	68B407B2		68B407B2	
125	SUPER DINK	09 > 13	•			68B40771	
150	AGILITY R16	08 > 12	•	68B407B2		68B40795	
150	B&W	00 >	•	68B40731		68B40714	
150	DINK	98 > 01	•	68B40714		68B40714	
150	DINK CLASSIC	02 > 03	•	68B40731			
150	DINK LX	98 > 01	•	68B40714		68B40714	
150	GRAND DINK	02 > 07	•	68B40731		68B40724	
150	HEROISM	96 > 98	•	68B40711			
150	MAXXER	02 > 03	•			68B40714	
150	MOVIE XL	01 >	•	68B40731			
150	PEOPLE	99 > 04	•	68B40757			
200	AGILITY 16 PLUS	14 >	•	68B407B2		68B40795	
200	AGILITY R16	09 > 14	•	68B407B2		68B40795	
200	DINK CLASSIC	03 >	•	68B40731		68B40714	
200	DOWNTOWN I	10 > 14	•		78B40819	68B40795	
200	LIKE 200 I	09 >	•	68B407F9		68B407D8	
200	NEW DINK	08 >	•	68B40795		68B40724	





				Fix	Floating	Fix	Floating
--	--	--	--	-----	----------	-----	----------

### KYMCO

200	PEOPLE GTI	10 >	●	68B40794		68B40794	
200	PEOPLE S	05 > 06	●	68B407B2			
200	PEOPLE S	07 >	●	68B407B2		68B407B2	
250	B & W	00 > 06	●	68B40731			
250	GRAND DINK	00 > 06	●	68B40731		68B40724	
250	PEOPLE S	02 > 05	●	68B407B2		68B407B2	
250	PEOPLE S	06 > 09	●	68B407B2		68B407B2	
250	XCITING	05 > 08	●	68B407E1		68B40799	
250	YUP	03 >	●	68B40731		68B40724	
300	DOWNTOWN I	09 > 14	●		78B40819	68B40771	
300	DOWNTOWN I ABS	10 > 14	●		78B40819	68B407N5	
300	G-DINK	12 >	●	68B40795		68B407D8	
300	K-XCTI	12 >	●		78B40819	68B40771	
300	MXU	06 >	●			68B40714	
300	PEOPLE GTI	10 >	●	68B40794		68B40794	
300	PEOPLE GTI ABS	14 >	●	68B40794		68B40794	
300	PEOPLE S	08 > 10	●●	68B407B2		68B407B2	
300	PEOPLE SI	08 > 10	●●	68B407B2		68B407B2	
300	SUPER DINK	09 > 12	●●		78B40819	68B40795	
300	XCITING	08 > 11	●●	68B407E1		68B40799	
300	XCITING R	08 > 11	●●	68B407E1		68B40799	
300	XCITING RI	08 > 09	●	68B407E1		68B40799	
350	DOWNTOWN I ABS	15 >	●		78B40819	68B40771	
400	XCITING	12 > 14	●●		78B40897	68B40799	
400	XCITING ABS	12 >	●			68B40799	
500	XCITING	04 > 09	●●	68B407E1		68B40799	
500	XCITING R	07 > 11	●	68B407E1		68B40799	

### LAVERDA

650	GHOST	96 > 99	●		78B40870	68B40791	
650	SPORT	95 > 01	●		78B40870	68B40791	
668	DIAMANTE	96 > 98	●		78B40870	68B40791	
668	STRIKE	97 > 99	●		78B40870	68B40791	
750	BLACK STRIKE	00 >	●●		78B40870	68B40791	
750	FORMULA	97 > 98	●		78B40870	68B40791	
750	FORMULA	99 > 01	●			68B40791	
750	SPORT	97 > 98	●●		78B40870	68B40791	
750	STRIKE	98 > 01	●		78B40870	68B40791	
750	SUPER SPORT	99 > 00	●			68B40791	
800	T-8	98 >	●		78B40870	68B40791	
800	TSS	98 >	●		78B40870	68B40791	
1000	SFC LIMITED EDITION	03 >	●			68B407G6	

### LEM

50	FLASH	93 >	●	68B40710			
150	STAR DE LUXE	09 >	●	68B40722			

### LML

125	STAR 2T	10 >	●	68B40722			
125	STAR 4T	10 >	●	68B40722			
125	STAR DELUXE	09 >	●	68B40722			
150	STAR 2T	10 >	●	68B40722			
150	STAR 4T	10 >	●	68B40722			
150	STAR DE LUXE	09 >	●	68B40722			
151	STAR 4T	10 >	●	68B40722			
200	STAR 4T	10 >	●	68B40722			

### MALAGUTI

50	CENTRO SL	93 > 07	●	68B40723			
50	CROSSER	95 > 98	●	68B40715			
50	CROSSER	97 >	●	68B40715			
50	F12 PHANTOM	94 > 98	●	68B40715			
50	F12 PHANTOM AIR COOLED RESTYLING EURO2	06 >	●	68B40721			
50	F12 PHANTOM CAPIREX	03 >	●	68B40721		68B40715	
50	F12 PHANTOM DIGIT	00 > 02	●	68B40715		68B40715	
50	F12 PHANTOM DIGIT (TUTTI I MODELLI)	03 >	●	68B40721		68B40715	
50	F12 PHANTOM EURO1	99 > 00	●	68B40721			
50	F12 PHANTOM FOGGY	00 >	●	68B40721		68B40715	
50	F12 PHANTOM LC	94 > 98	●	68B40715			
50	F12 PHANTOM LC EURO1	99 > 00	●	68B40721		68B40715	
50	F12 PHANTOM LC RESTYLING EURO1	01 > 02	●	68B40721		68B40715	
50	F12 PHANTOM LC RESTYLING EURO2	02 > 06	●	68B40721		68B40715	
50	F12 PHANTOM LC RESTYLING EURO3	03 > 04	●	68B40721		68B40715	
50	F12 PHANTOM LC TDS	99 > 00	●	68B40721			





				Fix	Floating	Fix	Floating
--	--	--	--	-----	----------	-----	----------

**MALAGUTI**

50	F12 PHANTOM LC TWIN DISKS	98 > 00	●	68B40715		68B40715	
50	F12 PHANTOM RESTILYNG EURO1	01 > 02	●	68B40721			
50	F12 PHANTOM RESTILYNG EURO2	02 >	●	68B40721			
50	F12 PHANTOM RESTILYNG EURO3	03 > 04	●	68B40721			
50	F12 PHANTOM SPECTRUM	00 >	●	68B40721		68B40715	
50	F15 FIRE FOX	96 > 98	●	68B40715		68B40715	
50	F15 FIRE FOX AIR COOLED	05 > 06	●	68B40721			
50	F15 FIRE FOX EURO2	02 > 03	●	68B40721		68B40715	
50	F15 FIRE FOX FUN	99 > 00	●	68B40721		68B40715	
50	F15 FIRE FOX FUN	03 >	●	68B40721		68B40715	
50	F15 FIRE FOX LC RESTILYNG EURO2	04 > 05	●	68B40721		68B40715	
50	F15 FIRE FOX LC-TDS RESTILYNG EURO1	99 > 01	●	68B40721		68B40715	
50	F15 FIRE FOX RESTILYNG EURO2	03 > 04	●	68B40721		68B40715	
50	F15 FIRE FOX TWIN DISK DIGIT KAT	98 > 00	●	68B40721		68B40715	
50	F15 FIRE FOX TWIN DISKS & SPECIAL	98 > 99	●	68B40715		68B40715	
50	F15 FIREFOX L.C.	96 > 98	●	68B40715			
50	F15 FIREFOX TDS	99 > 00	●	68B40721		68B40715	
50	SILVERFOX	96 >	●	68B40715			
100	CIAK	99 >	●	68B40715		68B40715	
100	F12 PHANTOM	99 >	●	68B40721		68B40715	
125	CENTRO IE	08 >	●	68B407A9		68B40766	
125	F18 PROJECT	00 >	●			68B40735	
125	F18 WARRIOR	00 >	●			68B40735	
125	MADISON	99 >	●	68B40735		68B40735	
125	MADISON BLACK RIDER	03 >	●	68B40735		68B40735	
125	PHANTOM MAX	03 >	●	68B40735		68B40735	
150	F 18 PROJECT	00 >	●			68B40735	
150	F18 WARRIOR	00 >	●			68B40735	
150	MADISON	99 >	●	68B40735		68B40735	
160	CENTRO IE	07 >	●	68B407A9		68B40766	
180	MADISON	99 >	●	68B40735		68B40735	
200	MADISON	02 >	●	68B40735		68B40735	
200	MADISON BLACK RIDER	03 >	●	68B40735			
200	PHANTOM MAX	03 >	●	68B40735		68B40735	
250	MADISON	99 > 03	●	68B40772		68B40735	
250	MADISON 3	08 >	●	68B40735			
250	MADISON RS	04 >	●	68B40735		68B40735	
250	PASSWORD	05 >	●	68B407E5		68B40798	
250	PHANTOM MAX	05 > 06	●	68B40735		68B40735	
400	MADISON	02 > 06	●	68B407E5		68B40772	
500	SPYDER MAX GT	04 >	●	68B407E5		68B407E2	
500	SPYDER MAX RS	09 >	●	68B407E5		68B407E2	

**MBK**

50	BOOSTER ALL MODEL	96 > 99	●	68B40710			
50	BOOSTER N.G.	01 > 04	●	68B40716			
50	EVOLIS	92 >	●	68B40710			
50	F1 ASSISTANCE	01 >	●	68B40716			
50	FIZZ	94 >	●	68B40710			
50	FORTE	94 >	●	68B40710			
50	NEO'S	94 >	●	68B40717			
50	NITRO	97 > 10	●	68B40716		68B40716	
50	OVETTO	96 > 10	●	68B40717			
50	STUNT	00 > 10	●	68B40716			
50	TARGET	92 > 94	●	68B40710			
50	TRACK	95 >	●	68B40710			
80	EVOLIS	94 >	●	68B40710			
100	NITRO	00 > 03	●	68B40716		68B40716	
100	OVETTO	00 > 02	●	68B40717			
125	DOODO	00 >	●	68B407G3			
125	SKYLINER	99 > 01	●	68B407G3			
125	SKYLINER	02 > 10	●	68B407G3		68B407G1	
125	THUNDER	01 >	●			68B407G2	
150	DOODO	01 >	●	68B407G3			
150	SKYLINER	00 > 00	●	68B407G3			
150	SKYLINER	01 >	●	68B407G3		68B407G1	
180	SKYLINER	03 >	●	68B407G3		68B407G1	
250	SKYLINER	00 > 03	●	68B40791		68B40765	
300	KILIBRE	03 > 04	●	68B407C5		68B40778	

**MONDIAL**

50	MKX1	99 >	●	68B40710			
50	MKX3	99 >	●	68B40710			
50	XR7	99 >	●	68B40717			





				Fix	Floating	Fix	Floating
<b>MONDIAL</b>							
999	PIEGA	03 >	••		78B40870	68B407G2	
999	PIEGA EVO	03 >	••		78B40870	68B407G2	
999	PIEGA NUDA	04 >	••		78B40870	68B407G2	
999	RZ NUDA	02 >	•			68B407G2	
999	RZ STARFIGHTER	02 >	•			68B407G2	
<b>MOTO GUZZI</b>							
750	BREVA 750 I.E.	03 > 07	•		78B40870		
750	NEVADA	03 > 07	•		78B40870		
750	NEVADA AQUILA NERA	10 >	•		78B40870		
750	NEVADA CLASSIC I.E.	03 >	•		78B40870		
750	NEVADA CLUB	03 >	•		78B40870		
750	V7 CAFE' CLASSIC	10 >	•		78B40870		
750	V7 CLASSIC	09 >	•		78B40870		
750	V7 II CAFE' RACER	15 >	•		78B40870		
750	V7 II RACER	15 >	•		78B40870		
750	V7 II SPECIAL	15 >	•		78B40870		
750	V7 II STONE	15 >	•		78B40870		
750	V7 RACER	10 >	•		78B40870		
750	V7 SPECIAL	12 >	•		78B40870		
750	V7 STONE	12 >	•		78B40870		
850	BREVA	06 > 08	••		78B40870		
850	GRISO	06 >	••		78B40870		
850	NORGE T-GTL	07 >	••		78B40870		
850	NORGE T-GTL ABS	07 >	••		78B40870		
940	BELLAGIO	10 >	••		78B40870		
1000	CALIFORNIA AQUILA NERA	10 >	••		78B40870		
1000	CALIFORNIA STONE	01 > 06	••		78B40870		
1000	DAYTONA RACING	96 >	••		78B40870		
1000	DAYTONA RS	96 >	••		78B40870	68B407G4	
1000	V10 CENTAURO	97 > 99	••		78B40870		
1000	V10 CENTAURO GT	99 > 01	••		78B40870		
1000	V10 CENTAURO SPORT	98 > 00	••		78B40870		
1100	BREVA	05 > 07	••		78B40870		
1100	BREVA ABS	05 > 07	••		78B40870		
1100	CALIFORNIA ALUMINIUM	03 >	•		78B40870	68B407G4	
1100	CALIFORNIA EV	96 > 00	•		78B40870	68B407G4	
1100	CALIFORNIA EV SPECIAL	97 > 03	•		78B40870	68B407G4	
1100	CALIFORNIA EV TOURING	03 >	•		78B40870	68B407G4	
1100	CALIFORNIA JACKAL	01 > 06	•		78B40870	68B407G4	
1100	CALIFORNIA TITANIUM	03 >	•		78B40870	68B407G4	
1100	GRISO	05 > 08	••		78B40870		
1100	METAL	02 >	•		78B40870	68B407G4	
1100	SPORT	94 > 96	••		78B40870		
1100	SPORT	98 > 99	••		78B40870		
1100	SPORT	00 >	•		78B40870	68B407G4	
1100	SPORT CORSA	98 > 99	••		78B40870		
1100	SPORT I.E.	96 > 99	••		78B40870		
1100	V 11	00 >	•		78B40870	68B407G4	
1100	V 11 CAFE' SPORT	03 >	•		78B40870	68B407G4	
1100	V 11 LE MANS NERO CORSA	03 >	••		78B40870	68B407G4	
1100	V 11 LE MANS ROSSO CORSA	03 >	•		78B40870	68B407G4	
1100	V11 BALLABIO	03 >	••		78B40870	68B407G4	
1100	V11 COPPA ITALIA	03 >	•		78B40870	68B407G4	
1100	V11 LE MANS	01 > 05	•		78B40870	68B407G4	
1100	V11 NAKED	01 > 02	•		78B40870	68B407G4	
1100	V11 NAKED	03 >	•			68B407G4	
1100	V11 SPORT	01 > 02	•		78B40870	68B407G4	
1200	BREVA	08 > 09	••		78B40870		
1200	BREVA ABS	08 > 09	••		78B40870		
1200	GRISO 8V	07 >	••		78B40870		
1200	NORGE ABS	06 >	••		78B40870		
1200	NORGE GT 8V	08 >	••		78B40870		
1200	NORGE T-GTL	06 > 09	••		78B40870		
1200	SPORT	06 > 07	••		78B40870		
1200	SPORT 8V	09 >	••		78B40870		
1200	SPORT ABS	06 > 07	••		78B40870		
1200	STELVIO	08 >	••		78B40870		
1400	CALIFORNIA CUSTOM	13 >	•			68B407K1	
1400	CALIFORNIA TOURING	13 >	•			68B407K1	
1400	ELDORADO	15 >	•			68B407K1	



				Fix	Floating	Fix	Floating
<b>MOTO MORINI</b>							
1200	9 1/2	06 > 09	••		78B40870		
1200	CORSARO	05 > 09	••		78B40870		
1200	CORSARO AVIO	08 > 09	•		78B40870		
1200	CORSARO VELOCE	07 > 09	•		78B40870		
1200	GRANPASSO	08 >	••		78B408A2		
1200	SCRAMBLER	09 >	•		78B408A2		
1200	SPORT	08 > 10	•		78B40870		
<b>MOTOR UNION</b>							
125	MAXI	99 >	•	68B40791		68B40714	
150	MAXI	99 >	•	68B40791		68B40714	
150	MIDI	99 >	•	68B40714		68B40714	
400	MAXI	99 >	•	68B40791		68B40714	
<b>MOTRON</b>							
50	SPIKE-S	98 >	•	68B40716			
50	SYNCR0	99 >	•	68B40716			
50	ZR THUNDER	95 >	•	68B40716			
<b>MV AGUSTA</b>							
675	BRUTALE	13 >	•		78B40893	68B407J2	
675	F3	11 >	••		78B40893	68B407J2	
675	F3 RC	16 >	•		78B40893	68B407J2	
675	F3 SERIE ORO	12 > 13	••		78B40889	68B407J2	
750	BRUTALE S	01 > 06	••		78B40868	68B407J1	
750	F4 BIPOSTO-S	98 > 06	••			68B407J1	
750	F4 BIPOSTO-S	00 > 06	••		78B40868	68B407J1	
750	F4 SENNA	98 > 06	••		78B40868		
800	BRUTALE	13 >	•		78B40893	68B407J2	
800	BRUTALE RR	15 >	••		78B40893	68B407J2	
800	DRAGSTER	14 >	••		78B40893	68B407J2	
800	DRAGSTER RR	14 >	••		78B40893	68B407J2	
800	DRAGSTER RR LH44	15 >	•		78B40893	68B407J2	
800	F3	12 > 13	••		78B40893	68B407J2	
800	F3 AGO	14 >	••		78B40889	68B407J2	
800	F3 RC	16 >	•		78B40893	68B407J2	
800	F3 SERIE ORO	12 > 13	••		78B40889	68B407J2	
800	RIVALE	13 >	•		78B40893	68B407J2	
800	STRADALE	15 >	•		78B40893	68B407J2	
800	TURISMO VELOCE	14 >	•		78B40893	68B407J2	
800	TURISMO VELOCE LUSSO	14 >	•		78B40893	68B407J2	
910	BRUTALE R	06 > 08	••		78B40889		
910	BRUTALE S	05 > 08	••		78B40868	68B407J1	
920	BRUTALE	12 >	••		78B40889	68B407J1	
989	BRUTALE R	08 > 08	••		78B40868		
1000	F4	13 >	••		78B40889	68B407J1	
1000	F4 312 R	07 > 08	••		78B40889		
1000	F4 FRECCE TRICOLORI	10 > 12	••		78B40889		
1000	F4 R	06 > 07	••		78B40889		
1000	F4 R	10 > 13	••		78B40889	68B407J1	
1000	F4 RC	16 >	••		78B40889	68B407J1	
1000	F4 RR	10 > 13	••		78B40889	68B407J1	
1000	F4 S	10 > 12	••		78B40889		
1000	F4 S MAMBA	04 > 07	••		78B40868		
1078	BRUTALE	08 > 09	••		78B40889		
1078	F4 312 R	07 > 08	••		78B40889		
1090	BRUTALE	13 >	•			68B407J1	
1090	BRUTALE CORSA	14 >	••		78B40889	68B407J1	
1090	BRUTALE R	12 >	••			68B407J1	
1090	BRUTALE RR	12 >	••		78B40889	68B407J1	
<b>MZ</b>							
1000	1000 S	01 > 02	•			68B40753	
1000	1000 S	03 >	•			68B40753	
<b>PEUGEOT</b>							
50	BLASTER ICE BLADE	09 >	•	68B40716			
50	BUXY R	93 > 97	•	68B40717			
50	BUXY RS	93 > 97	•	68B40715			
50	CITYSTAR	14 >	•	68B407K7			
50	DJANGO	15 >	•	68B407M2			
50	ELYSEO	97 > 00	•	68B40715			
50	ELYSEO (AJP CALIPER)	99 > 00	•	68B40715			
50	ELYSTAR	01 >	•	68B40758		68B40715	
50	JET C-TECH	06 >	•	68B40758		68B40715	





				Fix	Floating	Fix	Floating
<b>PEUGEOT</b>							
50	JET C-TECH DARKSIDE	11 >	●	68B40758		68B40716	
50	JET C-TECH ICE BLADE	11 >	●	68B40758		68B40716	
50	JET FORCE	06 >	●	68B40758		68B40715	
50	LOOXOR	03 >	●			68B40716	
50	LUDIX CLASSIC	03 >	●	68B40715			
50	LUDIX ELEGANCE	03 >	●	68B40715			
50	LUDIX SNAKE	03 >	●	68B40710			
50	LUDIX TREND	03 >	●	68B40710			
50	METAL X	01 >	●	68B40715			
50	SPEEDAKE (AJP CAL.)	94 > 99	●	68B40715			
50	SPEEDAKE (BREMBO CALIPER)	94 > 99	●	68B40715			
50	SPEEDAKE (HENGTONG CALIPER)	94 > 99	●	68B40715			
50	SPEEDFIGHT (AJP CAL.)	00 >	●			68B40714	
50	SPEEDFIGHT (BREMBO CAL.)	96 >	●			68B40714	
50	SPEEDFIGHT 3 LC	10 >	●			68B40716	
50	SQUAB	94 > 01	●	68B40715			
50	SQUAB (AJP CALIPER)	96 > 01	●	68B40715			
50	SV GEO	91 > 91	●	68B40715			
50	SV GEO	92 >	●	68B40715			
50	SV GEO EXECUTIVE	96 >	●	68B40715			
50	SV ROLAND GARROS	93 >	●	68B40715			
50	SVM	97 >	●	68B40710			
50	TKR	96 >	●	68B40715			
50	TKR STREET ZONE	03 >	●	68B40715			
50	TREKKER	99 >	●	68B40715			
50	TREKKER STREETBOARD	00 >	●	68B40715			
50	TREKKER URBAN BLACK	00 >	●	68B40715			
50	TWEET	11 >	●	68B407J4			
50	TWEET RS	13 >	●	68B407J4		68B407J4	
50	V-CLIC	09 >	●	68B40710			
50	VIVA 3	12 >	●	68B407M2			
50	VIVACITY	99 > 07	●	68B40715			
50	VIVACITY 4T	08 >	●	68B40721			
50	VIVACITY COMPACT	03 >	●	68B40716			
50	VIVACITY SIXTIES	11 >	●	68B40721			
50	VIVACITY X RACE	03 >	●	68B40716			
50	X-RACE	02 > 05	●			68B40714	
80	SV	91 >	●	68B40715			
100	ELYSEO	96 > 99	●	68B40758			
100	ELYSEO	00 >	●	68B40758			
100	ELYSEO (AJP CALIPER)	98 > 99	●	68B40758			
100	LOOXOR	02 >	●			68B40716	
100	SPEEDFIGHT (AJP CAL.)	98 > 02	●			68B40714	
100	SV	98 > 99	●	68B40715			
100	TREKKER	99 >	●	68B40715			
100	VIVACITY	99 > 07	●	68B40716			
125	CITYSTAR	11 >	●	68B407K7		68B407K8	
125	DJANGO	15 >	●	68B407M2			
125	DJANGO ALLURE	14 >	●	68B407M2			
125	DJANGO EVASION	14 >	●	68B407M2			
125	DJANGO HERITAGE	14 >	●	68B407M2		68B407M3	
125	DJANGO ID	15 >	●	68B407M2			
125	DJANGO SPORT	15 >	●	68B407M2			
125	ELYSEO	98 > 99	●	68B40758			
125	ELYSEO	00 >	●	68B40758			
125	ELYSTAR	01 >	●	68B40758			
125	EXECUTIVE	94 >	●	68B40716			
125	GEO RS	07 > 08	●	68B407D9		68B40751	
125	GEOPOLIS	06 > 09	●	68B407D9			
125	GEOPOLIS RS	10 >	●	68B407D9		68B40751	
125	JET FORCE	03 >	●	68B40758			
125	JET FORCE COMPRESSOR	03 >	●	68B40758			
125	LXR	09 >	●	68B40728			
125	SATELIS	04 > 08	●	68B407D9			
125	SATELIS ABS	06 > 08	●	68B407D9		68B407A8	
125	SATELIS COMPRESSOR	11 >	●	68B407D9			
125	SATELIS RS	11 >	●	68B407D9			
125	SV GEO	91 > 95	●	68B40716			
125	TWEET	11 >	●	68B407J4		68B407J4	
125	TWEET EVO	15 >	●	68B407J4		68B407J4	
125	TWEET RS	13 >	●	68B407J4		68B407J4	
125	VIVA 3	12 >	●	68B407M2			





				Fix	Floating	Fix	Floating
<b>PEUGEOT</b>							
150	CITYSTAR	14 >	●	68B407K7		68B407K8	
150	DJANGO	15 >	●	68B407M2			
150	DJANGO ALLURE	14 >	●	68B407M2			
150	DJANGO EVASION	15 >	●	68B407M2			
150	DJANGO HERITAGE	14 >	●	68B407M2		68B407M3	
150	DJANGO ID	15 >	●	68B407M2			
150	DJANGO SPORT	15 >	●	68B407M2			
150	ELYSEO	00 >	●	68B40758			
150	ELYSTAR	01 >	●	68B40758			
150	TWEET	11 >	●	68B407J4		68B407J4	
150	TWEET EVO	15 >	●	68B407J4		68B407J4	
150	TWEET RS	13 >	●	68B407J4		68B407J4	
200	CITYSTAR	14 >	●	68B407K7			
200	LXR	09 >	●	68B40728			
250	GEO RS	06 > 08	●	68B407D9		68B40751	
250	GEOPOLIS	06 > 09	●	68B407D9		68B407A8	
250	SATELIS	06 >	●	68B407D9		68B40751	
250	SATELIS RS	11 >	●	68B407D9			
250	SV	02 > 07	●	68B40775		68B40749	
300	GEO RS	11 >	●	68B407D9			
300	GEOPOLIS	11 >	●	68B407D9			
300	GEOPOLIS GT	13 >	●	68B407D9			
300	SATELIS	14 >	●	68B407D9		68B40751	
400	GEOPOLIS	07 > 09	●	68B407D9		68B407A8	
400	GEOPOLIS GT	14 >	●	68B407D9		68B40751	
400	GEOPOLIS RS	07 > 08	●	68B407D9		68B40751	
400	METROPOLIS GT	14 >	●	68B407L7		68B407L8	
400	METROPOLIS i	14 >	●	68B407L7		68B407L8	
400	METROPOLIS i SPORT	14 >	●	68B407L7		68B407L8	
400	METROPOLIS RS	14 >	●	68B407L7		68B407L8	
400	SATELIS	07 >	●	68B407D9		68B407A8	
400	SATELIS RS	07 >	●	68B407D9		68B407A8	
500	GEOPOLIS	08 >	●	68B407D9			
500	GEOPOLIS RS	09 >	●	68B407D9			
500	SATELIS	06 >	●	68B407D9		68B407A8	
500	SATELIS RS	07 >	●	68B407D9		68B407A8	
600	SATELIS ABS	04 >	●	68B407D9			
<b>PGO</b>							
50	BIG MAX	94 > 02	●	68B40710			
50	BIG MAX SPORT	96 >	●	68B40710			
50	MEGA FIFTY	99 >	●	68B40710			
50	MOT	97 >	●	68B40710			
50	PMX	97 >	●	68B40710			
50	TORNADO	96 > 02	●	68B40710			
80	BIG MAX	95 >	●	68B40710			
90	BIG MAX	97 > 00	●	68B40710			
<b>PIAGGIO</b>							
50	CLASSIC SPORT	97 >	●	68B40730			
50	ENERGY EXTREME DD	99 >	●	68B40730		68B40713	
50	ENERGY EXTREME DT	99 >	●	68B40730			
50	FLY 2T	05 > 07	●	68B40722			
50	FLY 2T	10 > 11	●	68B40722			
50	FLY 2T	12 >	●	68B407L4			
50	FLY 4T	08 > 11	●	68B40722			
50	FLY 4T 2V	12 >	●	68B407L4			
50	FLY 4T 4V	12 > 13	●	68B407L4			
50	FREE FL	95 > 02	●	68B40722			
50	LIBERTY	97 > 11	●	68B40738			
50	LIBERTY 2T	06 > 08	●	68B40738			
50	LIBERTY 2T RST	04 >	●	68B40738			
50	LIBERTY 2T SPORT	06 > 08	●	68B40738			
50	LIBERTY 4T	00 > 09	●	68B40738			
50	LIBERTY 4T DELIVERY TNT	09 >	●	68B40738			
50	LIBERTY 4T RST	04 >	●	68B40738			
50	LIBERTY 4T SPORT	06 > 08	●	68B40738			
50	LIBERTY PTT EURO2	04 > 05	●	68B40738			
50	NRG EXTREME	99 > 00	●	68B40730		68B40713	
50	NRG MC3	01 > 04	●	68B40730		68B40713	
50	NRG POWER DD	05 > 11	●	68B40738		68B40713	
50	NRG POWER DD SERIE SPECIALE	07 >	●	68B40738		68B40713	
50	NRG POWER DT	06 > 11	●	68B40738			
50	NRG POWER PUREJET	04 > 11	●	68B40738		68B40713	





				Fix	Floating	Fix	Floating
<b>PIAGGIO</b>							
50	NRG PUREJET	02 > 04	●	68B40730		68B40713	
50	NRG PUREJET	05 > 10	●	68B40738		68B40713	
50	NRG RST MC2	96 > 98	●	68B40717		68B40713	
50	NTT	96 >	●	68B40717			
50	QUARTZ	95 >	●	68B40723			
50	SFERA RST	96 > 98	●	68B40722			
50	SKIPPER	92 >	●	68B40723			
50	STEALTH	98 >	●	68B40730			
50	STORM	94 >	●	68B40717			
50	TYPHOON	94 >	●	68B40717			
50	TYPHOON EURO 3	10 > 12	●	68B407L4			
50	VESPA ET2	97 > 05	●	68B40722			
50	VESPA ET4	97 > 05	●	68B40722			
50	VESPA LX 2T	05 > 13	●	68B40722			
50	VESPA LX 2T FL	09 > 10	●	68B40722			
50	VESPA LX 2T TOURING	10 > 13	●	68B40722			
50	VESPA LX 4T	05 > 08	●	68B40722			
50	VESPA LX 4T-4V	09 > 13	●	68B40722			
50	VESPA LX 4T-4V TOURING	10 > 13	●	68B40722			
50	VESPA LXV 2T	06 > 09	●	68B40722			
50	VESPA LXV 2T NAVY	08 > 08	●	68B40722			
50	VESPA PRIMAVERA	13 >	●	68B40722			
50	VESPA PRIMAVERA 4T 4V	13 >	●	68B40722			
50	VESPA S 2T	07 > 12	●	68B40722			
50	VESPA S 4T & COLLEGE	08 > 12	●	68B40722			
50	VESPA S 4T-4V	08 > 09	●	68B40722			
50	VESPA S COLLEGE 4T	07 > 10	●	68B40722			
50	VESPA SPRINT 2T 2V	14 >	●	68B40722			
50	VESPA SPRINT 4T 4V	14 >	●	68B40722			
50	ZIP	00 > 04	●	68B40713			
50	ZIP 2T	08 > 10	●	68B40713			
50	ZIP 4T	00 > 10	●	68B40713			
50	ZIP DISCO	96 >	●	68B40710			
50	ZIP FAST RIDER	93 > 00	●	68B40710			
50	ZIP II	01 >	●	68B40713			
50	ZIP SP	96 > 08	●	68B40722			
50	ZIP SP EURO2	06 > 13	●	68B40722			
50	ZIP SPORT H20 SP	96 >	●	68B40722			
50	ZIP SPORT RST	95 >	●	68B40710			
75	SFERA	96 > 97	●	68B40722			
80	SKIPPER	96 >	●	68B40723			
80	TYPHOON	96 >	●	68B40717			
100	FLY 4T	06 > 08	●	68B40722			
100	FREE	02 > 03	●	68B40738			
100	ZIP 4T	06 > 10	●	68B40713			
125	BEVERLY	01 > 06	●	68B407B7		68B407B7	
125	BEVERLY EURO3	07 > 08	●	68B407B7		68B407B7	
125	BEVERLY EURO3 MIC	07 >	●	68B407B7		68B407B7	
125	BEVERLY EURO3 SPORT	07 > 08	●	68B407B7		68B407B7	
125	BEVERLY I.E. GT	10 >	●			68B40760	
125	BEVERLY RST	04 > 07	●	68B407B7		68B407B7	
125	BEVERLY TOURER EURO3	08 > 10	●	68B407B7		68B407B7	
125	CARNABY	07 > 10	●	68B407B7		68B407B7	
125	COMMUTER	93 >	●	68B40723			
125	FLY	05 > 07	●	68B40722			
125	FLY 4T 3V EURO 3	13 >	●	68B407L4		68B40738	
125	FLY EURO3	08 > 11	●	68B40722			
125	GTS SUPER IE	15 >	●	68B40738		68B40738	
125	HEXAGON	94 > 97	●	68B40713			
125	HEXAGON GTX	00 >	●	68B40722		68B40722	
125	HEXAGON LX	98 > 99	●	68B40722			
125	LIBERTY	98 > 02	●	68B40738			
125	LIBERTY	12 >	●	68B40776			
125	LIBERTY 4T	06 > 07	●	68B40738			
125	LIBERTY 4T DELIVERY EURO3	08 >	●	68B40738			
125	LIBERTY 4T EURO3	07 > 08	●	68B40738			
125	LIBERTY 4T SPORT EURO3	06 > 08	●	68B40738			
125	LIBERTY RST	04 > 05	●	68B40738			
125	LIBERTY RST PTT	05 > 06	●	68B40738			
125	LIBERTY S	06 >	●	68B40738			
125	MP3	07 > 08	●●	68B40774		68B40777	
125	MP3 HYBRID	09 > 10	●	68B40774		68B40777	



				Fix	Floating	Fix	Floating
<b>PIAGGIO</b>							
125	MP3 IE	08 > 09	●●	68B40774		68B40777	
125	QUARZT	92 >	●	68B40723			
125	SFERA	96 > 98	●	68B40722			
125	SKIPPER	93 > 95	●	68B40723			
125	SKIPPER 4T	00 > 02	●	68B40730			
125	SKIPPER LX	98 > 99	●	68B40730			
125	SKR	01 > 02	●	68B40730			
125	STEALTH	96 >	●	68B40730			
125	SUPER HEXAGON GTX 12"	01 > 03	●	68B40777		68B40738	
125	TYPHOON	96 > 00	●	68B40717			
125	TYPHOON	10 > 11	●	68B407L4			
125	TYPHOON CATALIZ.	02 >	●	68B40717			
125	VESPA 946	14 >	●	68B407L5		68B407L6	
125	VESPA ET4	96 > 02	●	68B40722			
125	VESPA GRANTURISMO	03 > 07	●	68B40738		68B40738	
125	VESPA GRANTURISMO EURO3	06 > 07	●	68B40738		68B40738	
125	VESPA GRANTURISMO L	01 > 03	●	68B40730		68B40730	
125	VESPA GT L	04 >	●	68B40738		68B40738	
125	VESPA GTS 4T IE SUPER	09 >	●	68B40738		68B40738	
125	VESPA GTS EURO3	07 > 11	●	68B40738		68B40738	
125	VESPA GTV	07 > 08	●	68B40738		68B40738	
125	VESPA GTV 4T NAVY EURO3	08 >	●	68B40738		68B40738	
125	VESPA LX	04 > 11	●	68B40722			
125	VESPA LX 4T FL	09 > 09	●	68B40722			
125	VESPA LX EURO 3	06 > 08	●	68B40722			
125	VESPA LX EURO3 IE	09 > 11	●	68B40722			
125	VESPA LX TOURING	10 > 13	●	68B40722			
125	VESPA LXV 4T NAVY EURO3	07 > 08	●	68B40722			
125	VESPA LXV IE 4T	10 > 13	●	68B40722			
125	VESPA PRIMAVERA 4T	13 >	●	68B40722			
125	VESPA PX	98 > 11	●	68B40722			
125	VESPA PX 30 ANNI	07 > 08	●	68B40722			
125	VESPA S 4T EURO3	07 > 08	●	68B40722			
125	VESPA S 4T IE	12 >	●	68B40722			
125	VESPA S 4T IE & COLLEGE	09 > 11	●	68B40722			
125	VESPA SPRINT 4T IE	14 >	●	68B40722			
125	X EVO	07 >	●	68B407B6		68B40777	
125	X10 EXECUTIVE	13 >	●	68B407J5		68B407J6	
125	X10 I.E.	12 >	●	68B407J5		68B40777	
125	X7	07 > 09	●	68B407B6		68B40776	
125	X7 EURO3	08 > 09	●	68B407B6		68B40777	
125	X7 EVO IE EURO3	09 > 10	●	68B407B6		68B40777	
125	X8	04 > 06	●	68B407B6		68B40776	
125	X8 PREMIUM EURO2	06 > 07	●	68B407B6		68B40776	
125	X8 PREMIUM EURO3	06 > 07	●	68B407B6		68B40776	
125	X9	01 >	●	68B40776		68B40776	
125	X9 EVOLUTION	03 > 07	●●	68B40776		68B40776	
125	X9 EVOLUTION EURO3	07 >	●●	68B40776		68B40776	
125	ZIP	00 > 02	●	68B40713			
125	ZIP 4T	02 >	●	68B40738			
150	COMMUTER	93 >	●	68B40723			
150	FLY	05 > 07	●	68B40722			
150	FLY EURO3	08 > 11	●	68B40722			
150	HEXAGON	94 > 97	●	68B40713			
150	HEXAGON	98 >	●	68B40722		68B40776	
150	LIBERTY	00 >	●	68B40738			
150	LIBERTY	12 >	●	68B40776			
150	LIBERTY 4T EURO3	08 >	●	68B40738			
150	LIBERTY 4T SPORT EURO3	08 >	●	68B40738			
150	QUARZT	92 >	●	68B40723			
150	SKIPPER	94 > 97	●	68B40723			
150	SKIPPER LXT-ST	99 >	●	68B40730			
150	SKR	01 > 02	●	68B40730			
150	STEALTH	96 >	●	68B40730			
150	SUPERHEXAGON	99 >	●	68B40738		68B40738	
150	VESPA ET4	99 > 05	●	68B40722			
150	VESPA GRANTURISMO L	01 >	●	68B40730		68B40730	
150	VESPA LX	05 > 06	●	68B40722			
150	VESPA LX 4T FL	09 >	●	68B40722			
150	VESPA LX EURO3	06 > 08	●	68B40722			
150	VESPA LX EURO3 IE	09 > 11	●	68B40722			
150	VESPA LX TOURING	10 > 13	●	68B40722			





				Fix	Floating	Fix	Floating
<b>PIAGGIO</b>							
150	VESPA PRIMAVERA	14 >	●	68B40722			
150	VESPA PX	02 > 12	●	68B40722			
150	VESPA S 4T	08 > 09	●	68B40722			
150	VESPA S 4T IE & COLLEGE	09 > 12	●	68B40722			
150	X 8	06 > 08	●	68B407B6			
180	HEXAGON	94 > 98	●	68B40713			
180	HEXAGON LXT	99 > 00	●	68B40722			
180	SUPER HEXAGON GTX 12"	01 > 03	●	68B40777		68B40738	
180	SUPERHEXAGON	99 > 00	●	68B40722		68B40722	
180	X9	00 > 02	●●	68B40776		68B40776	
180	X9 AMALFI	00 > 03	●●	68B40776		68B40776	
200	BEVERLY	03 > 06	●	68B407B6		68B407B6	
200	CARNABY	07 > 09	●	68B407B6		68B407B6	
200	LIBERTY	06 >	●	68B40738			
200	LIBERTY 4T EURO3	07 > 08	●	68B40738			
200	LIBERTY 4T SPORT EURO3	06 > 07	●	68B40738			
200	LIBERTY RST	04 >	●	68B40738			
200	LIBERTY S	01 >	●	68B40738			
200	LIBERTY SPORT	06 >	●	68B40738			
200	VESPA GRANTURISMO	06 > 07	●	68B40738		68B40738	
200	VESPA GT L	04 > 06	●	68B40738		68B40738	
200	VESPA PX	96 > 07	●	68B40722			
200	VESPA PX E	96 > 07	●	68B40722			
200	VESPA PX TIME	01 > 07	●	68B40722			
200	X8	05 > 07	●	68B407B6		68B40776	
200	X8 EVO	05 > 07	●	68B407B6		68B40776	
200	X9	02 > 03	●●	68B40776		68B40776	
200	X9 AMALFI	01 > 02	●	68B40776		68B40776	
200	X9 EVOLUTION	03 > 04	●●	68B40776		68B40776	
250	BEVERLY	06 > 07	●	68B407B7		68B407B7	
250	BEVERLY CRUISER	07 > 09	●	68B407B7		68B407B7	
250	BEVERLY EURO3 MIC	07 >	●	68B407B7		68B407B7	
250	BEVERLY IE EURO3	06 > 08	●	68B407B7		68B407B7	
250	BEVERLY RST	04 > 05	●	68B407B7		68B407B7	
250	BEVERLY SPORT	06 > 08	●	68B407B7		68B407B7	
250	BEVERLY TOURER EURO3	08 > 09	●	68B407B7		68B407B7	
250	CARNABY	08 > 09	●	68B407B7		68B407B7	
250	HEXAGON	98 > 01	●	68B40722		68B40738	
250	MP3	06 > 08	●●	68B40774		68B40777	
250	MP3 LT	09 >	●●	68B40774		68B40777	
250	MP3 MIC	08 > 09	●●	68B40774		68B40777	
250	SUPERHEXAGON	99 > 01	●	68B40738		68B40722	
250	VESPA GT 60 EURO3	06 > 07	●	68B40738		68B40738	
250	VESPA GTS	05 > 12	●	68B40738		68B40738	
250	VESPA GTS ABS	05 > 12	●	68B40738		68B40738	
250	VESPA GTV	06 > 09	●	68B40738		68B40738	
250	VESPA GTV 4T NAVY EURO3	08 >	●	68B40738		68B40738	
250	X EVO	07 > 11	●	68B407B6		68B40777	
250	X7	08 > 09	●	68B407B6		68B40777	
250	X8 I.E.	05 > 08	●	68B407B6		68B40776	
250	X9	00 > 06	●●	68B40776		68B40776	
250	X9 EVOLUTION	04 > 06	●●	68B40776		68B40776	
300	BEVERLY I.E.	10 >	●	68B407D4		68B40760	
300	BEVERLY S	11 >	●	68B407D4		68B40760	
300	BEVERLY TOURER EURO3	09 >	●	68B407B7		68B407B7	
300	CARNABY CRUISER	09 > 12	●	68B407B6		68B407B6	
300	MP3 LT BUSINESS I.E.	13 >	●●	68B40774		68B40777	
300	MP3 LT HYBRID I.E.	10 >	●●	68B40774		68B40777	
300	MP3 LT I.E.	10 > 11	●●	68B40774		68B40777	
300	MP3 LT SPORT I.E.	09 > 10	●●	68B40774		68B40777	
300	MP3 MIC I.E.	10 >	●	68B40774		68B40777	
300	MP3 TOURING	11 >	●●	68B40774		68B40777	
300	MP3 YOURBAN	11 > 14	●	68B40774		68B40777	
300	MP3 YOURBAN ie	15 >	●●	68B40774		68B40777	
300	MP3 YOURBAN LT	13 >	●●	68B40774		68B40777	
300	MP3 YOURBAN SPORT I.E.	13 >	●●	68B40774		68B40777	
300	MP3 YOURBAN SPORT LT I.E.	13 >	●●	68B40774		68B40777	
300	VESPA GTS IE	12 >	●	68B40738		68B40738	
300	VESPA GTS SUPER	08 > 13	●	68B40738		68B40738	
300	VESPA GTS SUPER SPORT	10 >	●	68B40738		68B40738	
300	VESPA GTS TOURING	11 > 12	●	68B40738		68B40738	
300	VESPA GTS TOURING	15 >	●	68B40738		68B40738	





				Fix	Floating	Fix	Floating
--	--	--	--	-----	----------	-----	----------

**PIAGGIO**

300	VESPA GTS TOURING IE ABS	15 >	●	68B40738		68B40738	
300	VESPA GTV VIA MONTENAPOLIONE	10 >	●	68B40738		68B40738	
300	X7 EVO I.E.	09 > 11	●	68B407B6		68B40777	
350	BEVERLY I.E. GT	11 >	●	68B407D4		68B40760	
350	BEVERLY S	14 >	●	68B407D4		68B40760	
350	X10 EXECUTIVE ABS	12 >	●	68B407J5		68B407J6	
350	X10 I.E.	12 >	●●	68B407J5		68B40777	
400	BEVERLY I.E.	06 > 07	●	68B407B6		68B40776	
400	BEVERLY TOURER EURO3	08 > 10	●●	68B407B6		68B40776	
400	MP3	07 > 08	●●	68B40774		68B40777	
400	MP3 LT	09 > 10	●	68B40774		68B40777	
400	MP3 LT I.E.	09 > 10	●●	68B40774		68B40777	
400	MP3 LT SPORT	09 > 10	●●	68B40774		68B40777	
400	MP3 LT SPORT I.E.	09 > 10	●	68B40774		68B40777	
400	MP3 MIC	08 > 09	●●	68B40774		68B40777	
400	X EVO	07 > 11	●	68B40776		68B40777	
400	X8 I.E.	06 > 08	●●	68B40776		68B40776	
500	BEVERLY	02 > 06	●●	68B407B7		68B40777	
500	BEVERLY CRUISER	07 > 12	●	68B407B6		68B40777	
500	BEVERLY EURO 3	06 > 09	●●	68B407B7		68B40777	
500	MP3 LT BUSINESS I.E.	13 >	●●	68B40774		68B40777	
500	MP3 SPORT	11 >	●●	68B40774		68B40777	
500	MP3 TOURING IE	12 >	●●	68B40774		68B40777	
500	NEXUS IE SP	06 > 08	●			68B40777	
500	X10	12 >	●●	68B407J5		68B40777	
500	X10 EXECUTIVE	12 >	●	68B407J5		68B407J6	
500	X9	01 > 02	●●	68B407B7		68B40777	
500	X9 EVOLUTION	03 > 07	●●	68B407B6		68B40777	
500	X9 EVOLUTION ABS	06 > 07	●	68B407B6		68B40777	

**RIEJU**

50	CROSSER CR1	96 > 98	●	68B40716			
50	FIRST	97 > 99	●	68B40716			

**SIAMOTO**

50	BINGO	99 >	●	68B40710			
50	MAT	98 >	●	68B40716			
50	TOP RACING	98 >	●	68B40716			
100	MAT	99 > 02	●	68B40716			
100	TOP RACING	99 > 00	●	68B40716			
125	BINGO	99 >	●	68B40710			

**SUZUKI**

125	BURGMAN	01 > 06	●	68B40737		68B40741	
125	BURGMAN ABS	14 >	●	68B407M1		68B407M1	
125	BURGMAN NEW	06 >	●	68B40770		68B40770	
125	RM	89 > 98	●		78B40813		
125	RM	00 > 09	●		78B40813	68B40784	
125	SIXTEEN	08 >	●	68B40729		68B40729	
150	BURGMAN	01 > 06	●	68B40737		68B40741	
150	SIXTEEN	08 >	●	68B40729		68B40729	
200	BURGMAN	07 >	●	68B40770		68B40770	
200	BURGMAN ABS	14 >	●	68B407M1		68B407M1	
250	BURGMAN	98 > 02	●	68B407B3		68B40727	
250	BURGMAN	03 > 06	●	68B407B4		68B40725	
250	BURGMAN	07 > 08	●	68B407B4		68B40726	
250	RM	89 > 89	●		78B40813		
250	RM	99 > 08	●		78B40813	68B40784	
250	RM Z	04 > 06	●		78B40810	68B40782	
250	RM Z	07 >	●		78B40812	68B40788	
250	RMX	92 > 98	●		78B40813		
400	BURGMAN	98 > 02	●	68B407B3		68B40727	
400	BURGMAN	03 > 05	●	68B407B4		68B40725	
400	BURGMAN	06 >	●	68B407B4		68B40726	
400	BURGMAN ABS	11 >	●	68B407B4		68B40726	
400	DRZ E	00 > 08	●		78B40813		
400	DRZ S	00 > 09	●		78B40813		
400	DRZ SM	05 > 09	●			68B40784	
400	GSR	06 > 08	●		78B40866	68B40785	
450	RM-Z	05 >	●		78B40812	68B40788	
450	RMX	10 > 11	●		78B40812	68B40788	
500	GS E	89 > 08	●		78B408A0		
600	GSF BANDIT	95 > 04	●●		78B40820	68B40771	
600	GSF BANDIT S	95 > 04	●●			68B40771	





				Fix	Floating	Fix	Floating
<b>SUZUKI</b>							
600	GSR	06 > 10	•		78B40866	68B40785	
600	GSX F	89 > 97	••		78B40820		
600	GSX F	98 > 03	•		78B40820	68B40771	
600	GSX F	04 > 06	•		78B40821	68B40771	
600	GSX-R	97 > 03	•		78B40875	68B40744	
600	GSX-R	04 > 05	•		78B40842	68B40744	
600	GSX-R	06 > 07	••		78B40864	68B40744	
600	GSX-R	08 >	••		78B40863	68B40744	
600	RF R	93 > 97	••		78B40820	68B40771	
650	BURGMAN	02 > 03	••	68B407B5		68B407A1	
650	BURGMAN	13 >	••		78B40839	68B407A2	
650	BURGMAN ABS	04 > 12	•	68B407B4		68B407A2	
650	BURGMAN ABS	13 >	••		78B40839	68B407A2	
650	DL V STROM	04 > 06	••		78B40865	68B407E3	
650	DL V STROM	07 > 12	••		78B40866	68B407E3	
650	DL V STROM ABS	07 >	••		78B40866	68B407E3	
650	DL V STROM XT (left/rear)	15 >	••		78B40866	68B407E3	
650	DR R-RS	92 > 93	•	68B407D5			
650	DR RSE	91 > 95	•	68B407D5			
650	FREEWIND	97 >	•	68B407D5			
650	GLADIUS	09 > 14	••		78B40829	68B40785	
650	GLADIUS ABS	09 > 14	••		78B40829	68B40785	
650	GSF BANDIT	05 > 06	•		78B40821	68B40771	
650	GSF BANDIT	07 > 12	•		78B40866	68B40785	
650	GSF BANDIT ABS	11 > 14	••		78B40866	68B40785	
650	GSF BANDIT S	05 > 06	••		78B40821	68B40771	
650	GSF BANDIT S	07 > 12	••		78B40866	68B40785	
650	GSX F	08 > 12	•		78B40866	68B40785	
650	GSX F ABS	08 > 14	•		78B40866	68B40785	
650	SV	99 > 02	•		78B40820	68B40771	
650	SV	03 > 10	•		78B40821	68B40744	
650	SV	07 >	••		78B40829		
650	SV S	99 > 02	••		78B40820	68B40771	
650	SV S	03 > 10	•		78B40821	68B40744	
650	SV S ABS	07 > 09	••		78B40829		
750	GSR	11 > 14	•		78B40866	68B40785	
750	GSR ABS	11 > 14	•		78B40866	68B40785	
750	GSX	97 > 03	•			68B40771	
750	GSX F	98 > 03	•		78B40820	68B40771	
750	GSX F	04 > 06	••		78B40821	68B40771	
750	GSX F-FL SLINGSHOT	89 > 92	••		78B40820		
750	GSX R	85 > 87	•			68B40744	
750	GSX R	88 > 89	•			68B40771	
750	GSX R	90 > 95	•			68B40771	
750	GSX R	04 > 05	••		78B40842	68B40744	
750	GSX R	06 > 07	••		78B40864	68B40744	
750	GSX R	08 >	•		78B40863	68B40744	
750	GSX-R	96 > 03	•		78B40875	68B40744	
800	DR BIG	91 > 95	•	68B407D5			
900	RF F	94 > 97	•			68B40771	
900	RF R	94 > 98	••		78B408A0		
1000	DL V STROM	02 > 10	••		78B40865	68B407E3	
1000	DL V STROM ABS	14 >	••		78B40866	68B407E3	
1000	GSX R	01 > 02	•		78B40875	68B40744	
1000	GSX R	03 > 04	•		78B40842	68B40744	
1000	GSX R	05 > 08	••		78B40864	68B40744	
1000	GSX R	09 > 14	••		78B40863	68B40744	
1000	SV	03 > 07	•		78B40865	68B40744	
1000	SV S	03 > 07	•		78B40865	68B40744	
1000	TL R	98 > 03	•		78B40875	68B40744	
1000	TL S	97 > 01	•		78B40875	68B40744	
1000	V-STROM ABS	14 >	•			68B407E3	
1100	GSX-R	86 > 88	•			68B40744	
1100	GSX-R	89 > 89	•			68B40771	
1100	GSX-R	90 > 92	•			68B40771	
1100	GSX-R W	93 > 00	•			68B40771	
1200	GSF BANDIT	97 > 05	•		78B408A0	68B40771	
1200	GSF BANDIT	06 >	•		78B40866	68B40785	
1200	GSF BANDIT S	97 > 05	••		78B408A0	68B40771	
1200	GSX	99 > 01	•			68B40771	
1200	GSX	02 >	•			68B40771	
1250	GSF BANDIT	07 > 11	•		78B40866	68B40785	



				Fix	Floating	Fix	Floating
<b>SUZUKI</b>							
1250	GSF BANDIT ABS	15 >	●●		78B40866	68B40785	
1250	GSF BANDIT S	11 > 12	●●		78B40866	68B40785	
1250	GSF BANDIT S ABS	11 >	●●		78B40866	68B40785	
1250	GSX F	10 >	●			68B40771	
1250	GSX FA	10 >	●		78B40866	68B40785	
1300	B-KING	08 > 10	●●		78B40866		
1300	GSX R HAYABUSA	99 > 07	●●		78B40875	68B40771	
1300	GSX R HAYABUSA	08 >	●●		78B40866		
1400	GSX	02 > 07	●●		78B40875		

<b>SYM</b>							
50	CHA-CHA	99 >	●	68B40711			
50	CINDARELLA	99 > 00	●	68B40711			
50	SUPER FANCY	99 >	●	68B40711			
50	SYMPHONY	12 >	●	68B407F4		68B407F4	
50	SYMPHONY SR	12 >	●	68B407F4		68B407F4	
100	CINDARELLA	99 > 00	●	68B40711			
100	SUPER FANCY	95 >	●	68B40711			
125	ATTILA	00 >	●	68B40711			
125	HD 2	10 >	●	68B40728		68B40728	
125	HD EVO	07 >	●	68B40728			
125	SUPER DUKE	00 >	●	68B40711			
150	ATTILA	00 >	●	68B40711			
150	SYMPHONY	12 >	●	68B407F4		68B407F4	
200	HD EVO	07 > 10	●	68B40728			
200	HD EVO	11 >	●	68B40728		68B407J8	
200	HD2 EVO	13 >	●	68B407J7		68B407J8	
300	CITYCOM	10 >	●	68B407A7		68B407B9	
300	JOY MAX EVO	12 >	●	68B407J9		68B407J8	
400	I MAXSYM	14 >	●	68B407K9		68B407K9	

<b>TGB</b>							
50	101 S	99 >	●	68B40710			
50	202 T	99 >	●	68B40716			
50	303 R	99 >	●	68B40716			
50	309 RS	00 >	●	68B40716			
50	AKROS	93 >	●	68B40710			
50	AKROS TEC.	94 >	●	68B40716			
50	ERGON	93 >	●	68B40711			
50	HIW'S	99 >	●	68B40716			
50	TRIGGER	99 >	●	68B40716			
90	101 S	99 >	●	68B40710			
90	202 T	99 >	●	68B40716			
90	AKROS	99 >	●	68B40716			
90	HIW'S	99 >	●	68B40716			
90	TRIGGER	99 >	●	68B40716			
125	202 T	99 >	●	68B40716			
125	303 R	99 >	●	68B40716			
125	309 RS	00 >	●	68B40716			
150	303 R	00 >	●	68B40716			
150	309 RS	00 >	●	68B40716			
300	X-MOTION	10 >	●	68B407C6		68B40734	

<b>TM</b>							
125	GS	90 > 92	●			68B40756	
125	MC	90 > 92	●			68B40756	

<b>TRIUMPH</b>							
600	BABY SPEED	01 > 02	●			68B40749	
600	DAYTONA	03 > 07	●●			68B40749	
600	SPEED FOUR	03 > 06	●			68B40749	
600	TT	00 > 03	●			68B40749	
675	DAYTONA	06 > 12	●●		78B40862	68B40749	
675	DAYTONA	13 >	●●		78B40859	68B407H6	
675	DAYTONA R	11 > 12	●●		78B40862	68B40749	
675	DAYTONA R	13 >	●●		78B40859	68B407H6	
675	STREET TRIPLE	07 > 12	●		78B40862	68B40749	
675	STREET TRIPLE	13 >	●●		78B40869	68B407H6	
675	STREET TRIPLE R	07 > 12	●		78B40862	68B40749	
675	STREET TRIPLE R	13 >	●		78B40869	68B407H6	
675	STREET TRIPLE RX	15 >	●●		78B40869	68B407H6	
800	BONNEVILLE	01 > 06	●			68B407A4	
800	TIGER	11 > 14	●●		78B40847	68B40749	
800	TIGER ABS	11 > 14	●●		78B40847	68B407A4	
800	TIGER XC	11 > 14	●●		78B40847	68B40749	





				Fix	Floating	Fix	Floating
--	--	--	--	-----	----------	-----	----------

### TRIUMPH

800	TIGER XC	15 >	●		78B40862	68B407N6	
800	TIGER XC ABS	11 > 14	●●		78B40847	68B407A4	
800	TIGER XCx	15 >	●		78B40862	68B407N6	
800	TIGER XR	15 >	●		78B40862	68B407N6	
800	TIGER XRx	15 >	●		78B40862	68B407N6	
855	T 509 SPEED TRIPLE	97 > 98	●●		78B40874	68B40749	
865	BONNEVILLE	07 > 08	●	68B407L3		68B407A4	
865	BONNEVILLE SE	09 > 11	●			68B407A4	
865	BONNEVILLE T100	05 >	●	68B407K2		68B407A4	
865	SCRAMBLER	06 > 08	●			68B407A4	
865	SCRAMBLER IE	06 > 14	●			68B407A4	
865	THRUXTON	04 > 07	●			68B407A4	
865	THRUXTON IE	08 > 14	●			68B407A4	
900	SPEED TRIPLE	99 >	●●			68B40749	
900	SPEED TRIPLE T509	97 > 98	●●		78B40874	68B40749	
900	THRUXTON	04 > 11	●			68B407A4	
900	TIGER	93 > 98	●●	68B407E9			
950	DAYTONA T595	96 > 98	●●		78B40874	68B40749	
955	DAYTONA T955I	99 > 01	●●		78B40874	68B40749	
955	DAYTONA T955I	02 > 06	●●		78B40873	68B40749	
955	SPEED TRIPLE	99 > 01	●●		78B40874	68B40749	
955	SPEED TRIPLE	02 > 04	●●		78B40873	68B40749	
955	SPRINT RS	99 > 04	●●		78B40874	68B407A4	
955	SPRINT ST	98 > 04	●		78B40874	68B407A4	
1050	SPEED TRIPLE	05 > 06	●●		78B40881	68B40749	
1050	SPEED TRIPLE	07 > 08	●●		78B40872	68B40749	
1050	SPEED TRIPLE	09 >	●●		78B40872	68B407A4	
1050	SPEED TRIPLE ABS	07 > 08	●●		78B40872	68B40749	
1050	SPEED TRIPLE ABS	09 >	●●		78B40872		
1050	SPEED TRIPLE R	12 > 13	●●		78B40881	68B40749	
1050	SPEED TRIPLE R	14 >	●●		78B40872	68B40749	
1050	SPEED TRIPLE R ABS	12 > 13	●●		78B40881	68B407A4	
1050	SPEED TRIPLE R ABS	14 >	●●		78B40872	68B407A4	
1050	SPRINT GT	10 >	●●		78B40872	68B407A4	
1050	SPRINT ST	05 > 10	●●		78B40873	68B40749	
1050	SPRINT ST ABS	05 > 10	●●		78B40873	68B407A4	
1050	SPRINT ST i	11 > 12	●●		78B40872	68B40749	
1050	SPRINT ST i ABS	11 > 12	●●		78B40872	68B407A4	
1050	TIGER	07 > 11	●●		78B40881	68B40749	
1050	TIGER SE	10 > 13	●●		78B40881	68B40749	
1050	TIGER SPORT ABS	13 >	●●		78B40881	68B407A4	
1200	TIGER EXPLORER	12 >	●		78B40847	68B407H5	
1200	TIGER EXPLORER XC	13 >	●●		78B40847	68B407H5	
1200	TIGER XC	13 >	●		78B40847	68B407H5	
1215	TROPHY	12 >	●●		78B40872	68B407H5	
1215	TROPHY SE	12 >	●●		78B40872	68B407H5	
2300	ROCKET III	04 > 09	●●		78B40873		
2300	ROCKET III CLASSIC	07 > 09	●●		78B40873		
2300	ROCKET III ROADSTER ABS	10 >	●●		78B40873		
2300	ROCKET X	15 >	●●		78B40873		

### VOXAN

1000	BLACK MAGIC	06 >	●●		78B40870		
1000	CAFE' RACER	99 > 06	●●		78B40870		
1000	ROADSTER	00 > 06	●●		78B40870		

### YAMAHA

50	AEROX	97 > 06	●	68B40716		68B40716	
50	AEROX REPLICA	97 > 06	●	68B40716		68B40716	
50	AEROX ROSSI	04 >	●	68B40716		68B40716	
50	AXIS	95 > 96	●	68B40710			
50	BREEZE	94 > 95	●	68B40710			
50	BW'S	93 > 98	●	68B40710			
50	BW'S NEXT GENERATION	01 > 03	●	68B40716			
50	CRZ	92 > 95	●	68B40710			
50	JOG	01 >	●	68B40716			
50	JOG R	01 >	●	68B40716			
50	JOG-Z	91 >	●	68B40710			
50	NEO'S	96 > 06	●	68B40717			
50	OVETTO	96 >	●	68B40717			
50	SLIDER	00 >	●	68B40716			
50	TZR	93 > 02	●	68B40791			
80	YE ZEST	95 >	●	68B40710			
80	YE ZEST	97 > 98	●	68B40710			



				Fix	Floating	Fix	Floating
<b>YAMAHA</b>							
90	JOG-Z	91 >	●	68B40710			
100	AEROX	00 > 02	●	68B40716		68B40716	
100	NEO'S	96 >	●	68B40717			
100	NEO'S	00 > 02	●	68B40717			
125	DT R	92 > 03	●			68B40756	
125	DT RE	05 > 06	●	68B407M5			
125	DT X SUPERMOTARD	05 > 06	●		78B40843	68B407M5	
125	MAJESTY	98 > 00	●	68B407G3			
125	MAJESTY	01 > 09	●	68B407G3		68B407G1	
125	MAXSTER	01 >	●			68B407G2	
125	MT	15 >	●	68B407M9		68B407M8	
125	N MAX	15 >	●	68B407P1		68B407P2	
125	SR	95 >	●			68B407E4	
125	TDR	89 > 99	●			68B40756	
125	TDR R	93 >	●		78B40870		
125	TEO'S	99 > 02	●	68B407G3		68B407G1	
125	TEO'S	03 >	●	68B407G3		68B407G2	
125	TZR R	91 >	●		78B40870		
125	WR	89 > 89	●			68B40756	
125	WR	90 > 97	●			68B40756	
125	WR	01 > 07	●		78B40813	68B40790	
125	WR X	09 > 13	●	68B407M4		68B407M5	
125	X CITY	08 >	●	68B407E6		68B40778	
125	X MAX	05 > 13	●	68B407C2	78B40817	68B40778	
125	X MAX	14 >	●	68B407C2	78B40817	68B407N9	
125	X MAX ABS	13 >	●	68B407C2	78B40817		
125	XENTER	12 >	●	68B407F7			
125	XV S DRAG STAR	99 > 02	●	68B407D0			
125	XV S VIRAGO	97 > 00	●	68B407D0			
125	XV VIRAGO	97 > 01	●	68B407D0			
125	YZ	85 > 89	●			68B40756	
125	YZ	90 > 97	●			68B40756	
125	YZ	98 > 01	●		78B40813		
125	YZ	02 >	●		78B40813	68B40790	
125	YZF R	08 >	●	68B407M9		68B407M8	
150	MAJESTY	98 > 00	●	68B407G3			
150	MAJESTY	01 > 02	●	68B407G3		68B407G1	
150	MAXSTER	01 >	●			68B407G2	
150	TEO'S	03 >	●	68B40791		68B407G2	
150	XENTER	12 >	●	68B407F7			
180	MAJESTY	01 > 06	●	68B407G3		68B407G1	
200	DT	89 >	●			68B40755	
200	WR	92 > 95	●			68B40756	
250	FZX ZEAL	91 >	●		78B40870		
250	MAJESTY	96 > 97	●	68B40791			
250	MAJESTY ABS	98 > 99	●	68B40791		68B40762	
250	MAJESTY ABS	00 > 05	●	68B40791		68B40765	
250	TDR	89 > 92	●		78B40870		
250	TT	00 >	●			68B40756	
250	TZR	89 > 89	●●		78B40870		
250	TZR	90 > 92	●●		78B40870		
250	WR	90 > 91	●			68B40756	
250	WR	92 > 97	●			68B40756	
250	WR	01 > 07	●		78B40813	68B40790	
250	WR F	01 > 02	●		78B40813	68B40790	
250	WR F	03 >	●		78B40813	68B40790	
250	X MAX	05 > 13	●	68B407C2	78B40817	68B40778	
250	X MAX	14 >	●	68B407C2	78B40817	68B407N9	
250	X MAX ABS	13 >	●	68B407C2	78B40817		
250	X MAX SPORT	11 > 13	●	68B407C2	78B40817	68B40778	
250	X MAX SPORT	14 >	●	68B407C2	78B40817		
250	X-CITY	07 >	●	68B407E6		68B40778	
250	XV S VIRAGO	95 > 07	●	68B407D0			
250	XV VIRAGO	95 > 087	●	68B407D0			
250	YZ	85 > 89	●			68B40756	
250	YZ	90 > 97	●			68B40756	
250	YZ	98 > 01	●		78B40813		
250	YZ	02 >	●		78B40813	68B40790	
250	YZ F	01 > 02	●		78B40813		
250	YZ F	03 >	●		78B40813	68B40790	
250	YZF F	03 > 05	●		78B40813		
300	XC VERSITY	03 > 04	●	68B407C5		68B40778	





				Fix	Floating	Fix	Floating
<b>YAMAHA</b>							
300	XC VERSTY	04 > 06	●	68B407C5		68B40778	
321	YZF R3	15 >	●		78B40849	68B407P0	
350	RD LC	85 > 93	●	68B407E4		68B407E4	
360	YZ	89 >	●			68B40756	
360	YZ	90 > 93	●			68B40756	
400	FZ R	85 > 87	●●	68B407E4			
400	MAJESTY	04 > 07	●●	68B407C3	78B40817	68B407C4	
400	MAJESTY ABS	08 >	●●	68B407C3	78B40817	68B407C4	
400	SR	14 >	●	68B407L1			
400	SRX	91 >	●			68B40791	
400	WR F	98 > 00	●		78B40813	68B40756	
400	X MAX	14 >	●		78B40835	68B407C4	
400	X MAX ABS	14 >	●		78B40835	68B407C4	
400	XJR	95 > 00	●			68B40791	
400	YZ F	98 > 00	●		78B40813	68B40756	
426	WR F	01 > 02	●		78B40813	68B40790	
426	YZ F	01 > 02	●		78B40813	68B40790	
450	WR F	03 >	●		78B40813	68B40790	
450	YZ F	03 >	●		78B40813	68B40790	
500	RD LC	84 > 88	●●	68B407E4			
500	T MAX	01 > 03	●	68B407D0		68B407E4	
500	T MAX	04 > 07	●●		78B40817	68B407E4	
500	T MAX	08 > 11	●		78B40818	68B407E4	
500	T MAX ABS	08 > 11	●●		78B40818	68B407E4	
500	T MAX BLACK MAX	04 > 07	●●		78B40817	68B407E4	
500	WR	92 > 93	●			68B40756	
530	T MAX	12 >	●		78B40817	68B407F8	
530	T MAX ABS	12 >	●●		78B40817	68B407F8	
530	T MAX BRONZE MAX/ ABS	13 >	●		78B40817	68B407F8	
530	T MAX IRON MAX	15 >	●		78B40817	68B407F8	
535	XV VIRAGO	96 > 00	●		78B40830		
600	DIVERSION	09 >	●		78B40831	68B40793	
600	FZ 6 FAZER	04 > 08	●		78B40831	68B407H3	
600	FZ6 FAZER S2	07 > 08	●●		78B40831	68B407H3	
600	FZR	89 > 95	●●		78B408A2	68B407H8	
600	FZR R	94 > 95	●●		78B408A2		
600	FZS FAZER	98 > 00	●			68B407H8	
600	FZS FAZER	01 > 03	●			68B407H8	
600	FZS FAZER	04 > 08	●			68B407H3	
600	SRX	86 >	●	68B407E4		68B407H8	
600	TT E	97 > 00	●	68B407C1			
600	TT R	98 > 00	●	68B407C1		68B40756	
600	TT RE	04 > 07	●	68B407C1		68B40756	
600	XJ 6	09 > 11	●		78B40831	68B40793	
600	XJ DIVERSION	91 > 97	●			68B407H8	
600	XJ DIVERSION	98 > 03	●●		78B40830	68B407H8	
600	XJ DIVERSION	09 > 11	●●		78B40831		
600	XJ F	83 > 90	●	68B407E4		68B407E4	
600	XJ N	98 > 03	●●		78B40830	68B40791	
600	XT	83 > 85	●	68B407E4			
600	XT	86 > 89	●	68B407E4		68B40742	
600	XT E	90 > 94	●			68B40742	
600	XT E	95 >	●	68B407D0		68B40742	
600	XT K	83 > 85	●	68B407E4			
600	XT K	86 > 89	●	68B407E4		68B40742	
600	XT TENERE'	83 > 89	●	68B407E4			
600	XTZ TENERE'	86 > 91	●	68B407E4		68B40742	
600	YZF R THUNDER CAT	96 > 04	●		78B40830	68B407H8	
600	YZF R6	99 > 02	●●		78B40830	68B40755	
600	YZF R6	03 > 04	●●		78B40831	68B40750	
600	YZF R6	05 >	●●		78B40860	68B40750	
650	XVS DRAG STAR	97 > 04	●●		78B40830		
650	XVS DRAG STAR CLASSIC	98 > 06	●		78B40830		
660	MT-03	06 > 11	●		78B40831	68B407H3	
660	SZR	95 >	●		78B40870		
660	XT R	04 > 13	●		78B40843	68B407H8	
660	XT R	14 >	●		78B40843		
660	XT X	04 > 09	●		78B40894	68B407H8	
660	XTZ TENERE'	91 > 96	●	68B407D0		68B40742	
660	XTZ TENERE'	08 > 13	●		78B40843	68B407H8	
700	MT 07	14 >	●		78B40837	68B407L0	
700	MT 07 ABS	15 >	●●		78B40837	68B407L0	



				Fix	Floating	Fix	Floating
<b>YAMAHA</b>							
750	FZ	85 > 88	●	68B407E4		68B407E4	
750	FZ GENESIS	89 > 92	●●		78B408A2	68B407E4	
750	FZR	89 > 92	●●		78B40870		
750	FZR GENESIS	87 >	●		78B40870	68B407E4	
750	FZX	87 >	●●	68B407E4		68B407E4	
750	XJ F	83 > 88	●	68B407E4			
750	XTZ SUPERTENERE	89 >	●●			68B407C9	
750	XV VIRAGO	87 > 93	●●	68B407E4		68B407E4	
750	XV VIRAGO	94 > 00	●●	68B407D0			
750	YZF R	93 > 97	●		78B40870	68B40791	
750	YZF R7	99 > 01	●●		78B40894	68B407H8	
750	YZF SP	93 > 97	●		78B40870	68B40791	
800	FZ 8	10 > 13	●●		78B40860	68B407C2	
800	FZS FAZER	98 > 99	●			68B407H8	
800	FZS FAZER	10 > 12	●●		78B40860	68B407C2	
850	MT 09	14 >	●		78B40831	68B407L0	
850	MT 09 ABS	14 >	●		78B40831	68B407L0	
850	MT 09 STREET RALLY	14 >	●●		78B40831	68B407L0	
850	MT 09 STREET RALLY ABS	14 >	●		78B40831	68B407L0	
850	TDM	91 > 01	●●		78B408A2	68B407H8	
850	TRX	95 > 00	●		78B408A2	68B407H8	
900	TDM	02 > 10	●●		78B40830	68B40791	
900	TDM ABS	02 > 10	●●		78B40830	68B40791	
900	XJ DIVERSION	94 >	●			68B407E4	
900	XJ F	83 > 90	●●	68B407E4			
950	XVS MIDNIGHT STAR	09 >	●●		78B40894		
1000	FZ1	06 > 11	●●		78B40871	68B407H3	
1000	FZ1 FAZER	06 > 12	●		78B40871	68B407H3	
1000	FZR	87 > 88	●			68B407E4	
1000	FZR EX-UP	89 > 90	●		78B40870	68B407E4	
1000	FZR EX-UP	91 > 91	●●		78B40870	68B407E4	
1000	FZR EX-UP	92 > 93	●●		78B40870	68B407E4	
1000	FZR EX-UP	94 > 95	●●		78B40870	68B407E4	
1000	FZR GENESIS	87 > 88	●		78B40870	68B407E4	
1000	FZS FAZER	01 > 05	●●		78B40830	68B407E4	
1000	GTS	93 > 96	●			68B407D0	
1000	YZF R1	98 > 01	●●		78B40830	68B40791	
1000	YZF R1	02 > 03	●		78B40830	68B40755	
1000	YZF R1	04 > 06	●		78B40871	68B40750	
1000	YZF R1	07 > 14	●●		78B40860	68B40750	
1000	YZF R1	15 >	●		78B40871	68B40750	
1000	YZF R1 SP	06 >	●			68B40750	
1000	YZF R1M SPECIAL EDITION	15 >	●●		78B40871	68B40750	
1000	YZF THUNDER ACE	96 > 98	●		78B40830	68B407H8	
1100	BT BULLDOG	02 > 06	●●		78B40830	68B407E4	
1100	FJ	84 > 85	●●	68B407D0		68B407D0	
1100	XV VIRAGO	87 > 93	●●	68B407E4			
1100	XVS DRAG STAR	99 > 06	●		78B40830	68B407D0	
1200	FJ	88 > 95	●●		78B408A2	68B407D0	
1200	FJ ABS	88 > 95	●			68B407D0	
1200	V MAX	86 > 92	●	68B407D0		68B407D0	
1200	V MAX	93 > 06	●●		78B40830	68B407D0	
1200	XJR	95 > 98	●		78B40870	68B407E4	
1200	XTZ SUPERTENERE	10 > 13	●●		78B40860	68B407D0	
1200	XVZ VENTURE ROYALE	84 > 87	●●		78B40830		
1200	XVZ VENTURE ROYALE	96 > 07	●●		78B40830		
1300	FJR A	06 >	●			68B407D0	
1300	FJR ABS	01 > 04	●●		78B40830	68B407D0	
1300	FJR ABS	06 >	●		78B40894	68B407D0	
1300	FJR AS	06 >	●			68B407D0	
1300	XJR	99 >	●●		78B40830	68B407E4	
1300	XJR (BREMBO CALIPER)	98 >	●		78B40870	68B407E4	
1300	XJR SP	99 >	●			68B407E4	
1300	XVS MIDNIGHT STAR	07 > 11	●●		78B40830		
1600	WILD STAR	99 > 07	●●		78B40830		
1670	MT-01	05 >	●		78B40894	68B407E4	
1700	XV PC ROAD STAR WARRIOR	02 > 07	●●		78B40830		
1900	XV ROADLINER	06 >	●●		78B40830		