



Yamaha T-MAX 500 (2001 - 2005)

Supersport SP Series Exhaust System



Akrapovic Supersport SP series Exhaust System

for the Yamaha T-MAX 500 (2001 - 2005)

Description

The Akrapovic SUPERSPORT SP series complete system is designed for maxi scooter riders looking for a comfortable ride and a bit of the kind of tuning usually reserved for sport motorcycles. With an Akrapovic exhaust system the Yamaha T-max will gain in both looks and performance.

PERFORMANCE

Measurements of the Akrapovic SUPERSPORT SP SERIES system on the YAMAHA T-MAX (without noise damper):

Power & Torque: with the Akrapovic Supersport system the best news is the filling of the drop-outs in the power and torque curves. The T-max engine will now run evenly and smoothly throughout the range, which is exceptionally welcome given the intention of the scooter. In addition the engine also gains significant increases in power and torque. At 6750 rpm it puts out 32.6 HP.

CONFIGURATION

The system is composed of cylindrical stainless steel header tubes joined by a conical stainless steel Y link pipe. The link pipe also serves as the collector. The joints are sleeve joints held together with silicon-shielded tensioning springs, including the link pipe – muffler joint. As the system is part of the SP series, the inlet and outlet cap and inner perforation are made of stainless steel, while the outer sleeve is made entirely of titanium.

	PERFORMANCE		
	stock	AKRAPOVIC	max. increased power
max. rear wheel power HP / rpm (measured on SuperFlow Cyle Dyn)	30.3 / 5850	32.6 / 6750	2.7 / 7000

	CONFIGURATION		
	header tubes	collector	link pipe
material	STAINLESS STEEL	-	STAINLESS STEEL
tube shape	CYLINDRICAL	-	CONICAL

interference crossover tubes	-	lambda sensor	-
header tube inner sleeves	S.S. CNC MACHINED	header tube flanges	ALU CNC MACHINED
header tubes - collector connection	SLEEVE JOINT + SILICON SHIELDED SPRINGS	collector / header tube - link pipe connection	-
link pipe - muffler connection	SLEEVE JOINT + SILICON SHIELDED SPRINGS	muffler inlet cap /outlet cap	STAINLESS STEEL / STAINLESS STEEL
muffler metal interior	STAINLESS STEEL	muffler outer sleeve	TITANIUM
muffler clamp	CARBON-FIBER ROAD	muffler bracket	-
noise damper	-	heat shield	-

OPTIONS				
link pipe	noise damper	muffler outer sleeve	muffler bracket	heat shield
-	-	-	-	-

	ADDITIONAL DATA		
	stock	AKRAPOVIC	difference
	6.25	SUPERSPORT SP SERIES 5.60	stock - SUPERSPORT SP SERIES 0.65
weight comparison (kg)			
noise measurements (dB / rpm)	stock 94 / 3500		AKRAPOVIC 94 / 3500
possibility of periodic service without removing A.E.S.	oil YES		oil filter YES
legal for street use	NO		

Technical specifications of Akrapovic exhaust systems and related products subject to change without notice.

Product code: 104210 (SS-Y5S1-DT)

Akrapovic Supersport SP series Exhaust System

for the Yamaha T-MAX 500 (2001 - 2005)



CARBON-FIBER
MUFFLER CLAMP

Product code: 104210 (SS-Y5S1-DT)

Akrapovic Supersport SP series Exhaust System

for the Yamaha T-MAX 500 (2001 - 2005)



Akrapovic Exhaust System Technology copyright 2005, all rights reserved

Road Program

Product code: 104210 (SS-Y5S1-DT)

Akrapovic Supersport SP series Exhaust System for the Yamaha T-MAX 500 (2001 - 2005)



Akrapovic Exhaust System Technology copyright 2005, all rights reserved

Road
Program

Product code: 104210 (SS-Y5S1-DT)

Akrapovic Supersport SP series Exhaust System

for the Yamaha T-MAX 500 (2001 - 2005)

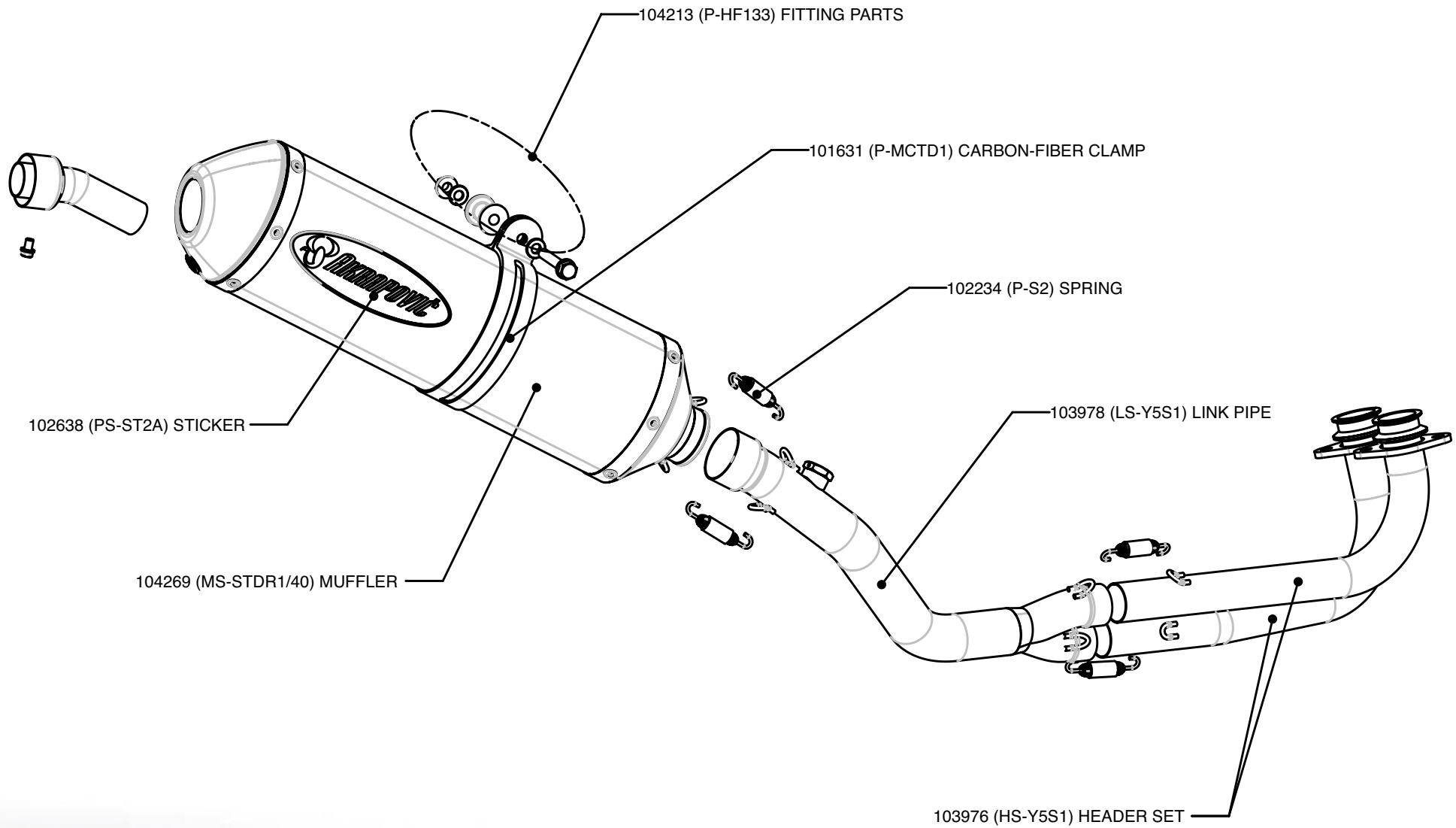

Product code: 104210 (SS-Y5S1-DT)



Akrapovic Supersport SP series Exhaust System

for the Yamaha T-MAX 500 (2001 - 2005)

Diagram / Chart

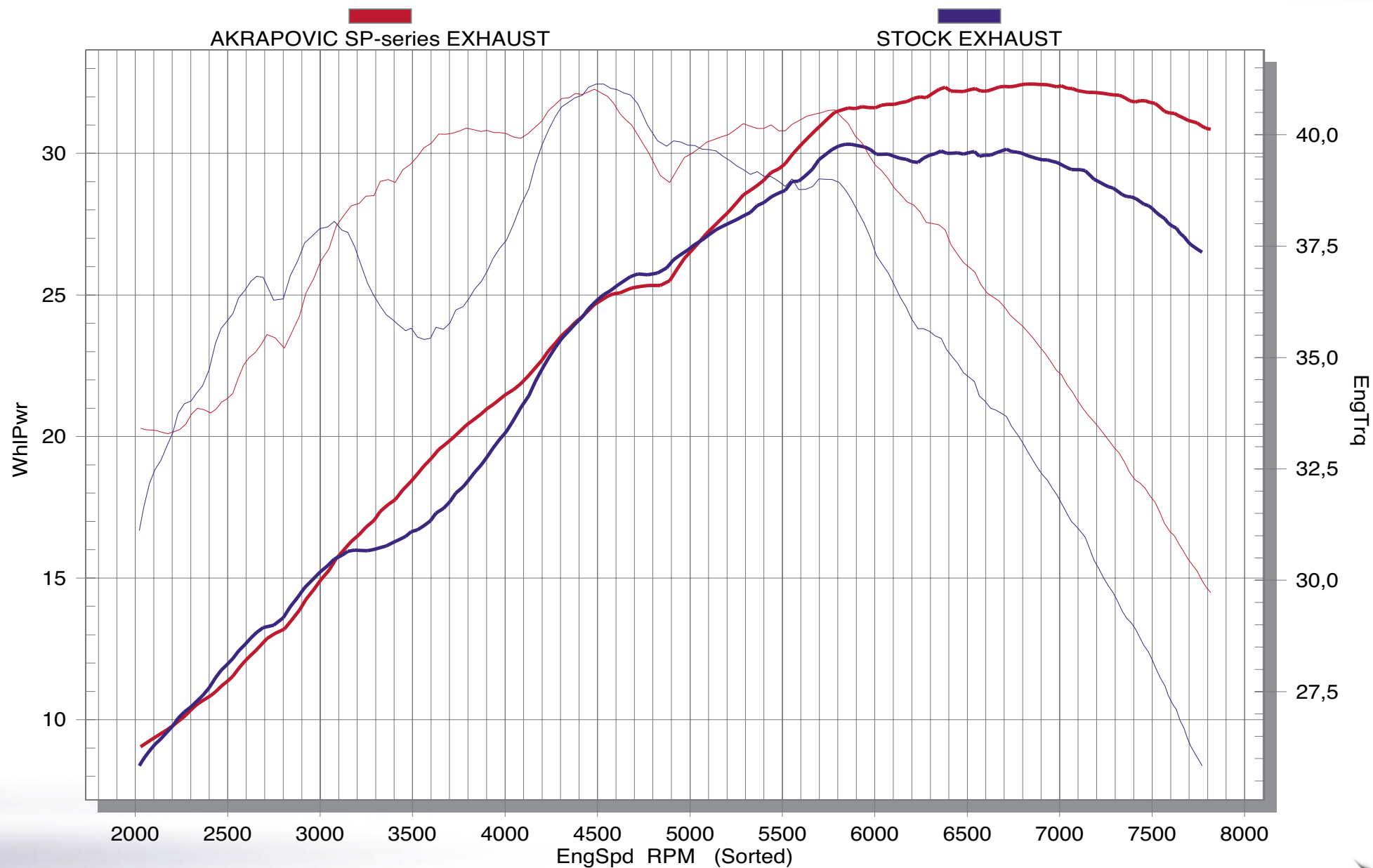

Product code: 104210 (SS-Y5S1-DT)